

TM 11-6625-601-34P

TECHNICAL MANUAL

**DIRECT SUPPORT AND GENERAL SUPPORT MAINTENANCE
REPAIR PARTS AND SPECIAL TOOLS LISTS
(INCLUDING DEPOT MAINTENANCE REPAIR PARTS AND SPECIAL TOOLS)
FOR
MAINTENANCE KIT, ELECTRONIC EQUIPMENT
MK-733/ARC-54
(NSN 5821-00-901-4327)**

HEADQUARTERS, DEPARTMENT OF THE ARMY

NOVEMBER 1978

TECHNICAL MANUAL

No. 11-6625-601-34P

HEADQUARTERS
DEPARTMENT OF THE ARMY
WASHINGTON, DC, 2 November 1978

**DIRECT SUPPORT AND GENERAL SUPPORT MAINTENANCE
REPAIR PARTS AND SPECIAL TOOLS LISTS
(INCLUDING DEPOT MAINTENANCE REPAIR PARTS AND SPECIAL TOOLS)
FOR
MAINTENANCE KIT, ELECTRONIC EQUIPMENT MK-733/ARC-54
(NSN 5821-00-901-4327)**

Current as of 14 June 1978

REPORTING OF ERRORS

You can improve this manual by recommending improvements using DA Form 2028-2 located in the back of the manual. Simply tear out the self addressed form, fill it out as shown on the sample, fold it where shown, and drop it in the mail.

If there are no blank DA Form 2028-2 in the back of your manual, use the standard DA Form 2028-2 (Recommended Changes to Publications and Blank Forms) and forward to the Commander, US Army Communications and Electronics Materiel Readiness Command, ATTN: DRSEL-ME-MQ, Fort Monmouth, New Jersey 07703.

In either case a reply will be furnished direct to you.

Table of Contents

		Page	Illus Figure
SECTION	I. Introduction	1	
	II. Repair parts list	5	
Group	00 Maintenance Kit, Electronic Equipment MK-733/ARC-54	5	1
	01 Extender Module MX-4930/ARC-54	7	2
	02 Extender Module MX-4931/ARC-54	11	3
	03 Extender Module MX-4932/ARC-54	15	4
	04 Extender Module MX-4933/ARC-54	17	5
	05 Extender Module MX-4934/ARC-54	21	6
	06 Cable Assembly CX-9070/ARC-54	23	7
	07 Cable Assembly CX-9071/ARC-54	25	8
	08 Cable Assembly CX-9072/ARC-54	27	9
	09 Cable Assembly CX-11136/ARC-54	29	10
	10 Cable Assembly CG-409G/U (1-F)	31	11
	11 Test Set, Radio TS-1967/ARC-54	33	12
	1101 Front panel assembly SMB-504958	37	13,14
	110101 Indicator ID-48/ARN (See TM 11-5840-270-24-1 for parts)		
	110102 Audio amplifier (A1)	47	15
	1102 Simulator, Test Set SM-349/ARC-54	51	16,17
	110201 Electronic component assembly (A2)	57	18
	110202 Audio amplifier (A1) (See group 110102 for parts)		
	110203 Front panel assembly SMB-504943	59	19
	12 Case, Maintenance Kit CW-711/ARC-54	63	20
SECTION	III. Special tools list (Not applicable)		
	IV. National stock number and part number index	64	

*This manual supersedes TM 11-6625-601-34P, 17 January 1977.

SECTION I

INTRODUCTION

1. Scope

This manual lists repair parts and special tools required for performance of direct support and general support maintenance of the MK-733/ARC-54.

2. General

This Repair Parts and Special Tools List is divided into the following sections:

a. Section II. Repair Parts List. A list of repair parts authorized for use in the performance of maintenance. The list also includes parts which must be removed for replacement of the authorized parts. Parts lists are composed of functional groups in ascending numerical sequence, with the parts in each group listed in figure and item number sequence.

b. Section III. Special Tools List. Not applicable.

c. Section IV. National Stock Number and Part Number Index. A list, in ascending National item identification number (NIIN, last 9 digits) sequence, of all National stock numbers appearing in the listings, followed by a list, in alphameric sequence, of all part numbers appearing in the listings. National stock number and part numbers are cross-referenced to each illustration figure and item number appearance.

3. Explanation of Columns

The following provides an explanation of columns found in the tabular listings:

a. Illustration. This column is divided as follows:

(1) *Figure number.* Indicates the figure number of the illustration in which the item is shown.

(2) *Item number.* The number used to identify each item called out in the illustration.

b. Source, Maintenance, and Recoverability Codes (SMR).

(1) *Source code.* Source codes are assigned to support items to indicate the manner of acquiring support items for maintenance, repair, or overhaul of end items. Source codes are entered in the first and second positions of the Uniform SMR Code format as follows

<i>Code</i>	<i>Definition</i>
-------------	-------------------

PA-Item procured and stocked for anticipated or known usage.

PD- Support item, excluding support equipment, procured for initial issue or outfitting and stocked only for subsequent or additional initial issues or outfittings. Not subject to automatic replenishment.

XD-A support item that is not stocked. When required, item will be procured through normal

supply channels.

NOTE

Cannibalization or salvage may be used as a source of supply for any items source coded above except those coded XA, XD, and aircraft support items as restricted by AR 700-42.

(2) *Maintenance code.* Maintenance codes are assigned to indicate the levels of maintenance authorized to USE and REPAIR support items. The maintenance codes are entered in the third and fourth positions of the Uniform SMR Code format as follows:

(a) The maintenance code entered in the third position will indicate the lowest maintenance level authorized to remove, replace, and use the support item. The maintenance code entered in the third position will indicate one of the following levels of maintenance:

<i>Code</i>	<i>Application/Explanation</i>
-------------	--------------------------------

O-Support item is removed, replaced, used at the organizational level.

F- Support item is removed, replaced, used at the direct support level.

H-Support item is removed, replaced, used at the general support level.

(b) The maintenance code entered in the fourth position indicates whether the item is to be repaired and identifies the lowest maintenance level with the capability to perform complete repair (i.e., all authorized maintenance functions). This position will contain one of the following maintenance codes:

<i>Code</i>	<i>Application/Explanation</i>
-------------	--------------------------------

F- The lowest maintenance level capable of complete repair of the support item is the direct support level.

H- The lowest maintenance level capable of complete repair of the support item is the general support level.

D- The lowest maintenance level capable of complete repair of the support item is the depot level.

Z- Nonreparable. No repair is authorized.

(3) *Recoverability code.* Recoverability codes are assigned to support items to indicate the disposition action on unserviceable items. The recoverability code is entered in the fifth position of the Uniform SMR Code format as follows:

<i>Recoverability codes</i>	<i>Definition</i>
-----------------------------	-------------------

Z- Nonreparable item. When unserviceable, condemn and dispose at the level indicated in position 3.

*Recoverability
codes*

Definition

- F- Repairable item. When uneconomically repairable, condemn and dispose at the direct support level.
- H- Repairable item. When uneconomically repairable, condemn and dispose at the general support level.
- D- Repairable item. When beyond lower level repair capability, return to depot. Condemnation and disposal not authorized below depot level.

c. National Stock Number. Indicates the National stock number assigned to the item and will be used for requisitioning purposes.

d. Part Number. Indicates the primary number used by the manufacturer (individual company, firm, corporation or Government activity), which controls the design and characteristics of the item by means of its engineering drawings, specifications standards, and inspection requirements, to identify an item or range of items.

NOTE

When a stock numbered item is requisitioned, the repair part received may have a different part number than the part being replaced.

e. Federal Supply Code for Manufacturer (FSCM). The FSCM is a 5-digit numeric code listed in SB 708-42 which is used to identify the manufacturer, distributor, or Government agency, etc.

f. Description. Indicates the Federal item name and, if required, a minimum description to identify the item.

g. Unit of Measure (U/M). Indicates the standard of the basic quantity of the listed item as used in performing the actual maintenance function. This measure is expressed by a two-character alphabetical abbreviation (e.g., ea, in, pr, etc.). When the unit of measure differs from the unit of issue, the lowest unit of issue that will satisfy the required units of measure will be requisitioned.

h. Quantity Incorporated in Unit. Indicates the quantity of the item used in the breakout shown on the

illustration figure, which is prepared for a functional group, subfunction group, or an assembly.

4. Special Information

The following publications pertain to the MK-733/ARC-54 and its components
 TM 11-5840-270-24-1, Indicator ID-48A/ARN
 TM 11-6625-601-12, Maintenance Kit, Electronic Equipment MK-733/ARC-54
 TM 11-6625-601-20P, Maintenance Kit Electronic Equipment MK-733/ARC-54
 TM 11-6625-601-34, Maintenance Kit Electronic Equipment MK-733/ARC-54

5. How to Locate Repair Parts

a. When National stock number or part number is unknown.

(1) *First.* Using the table of contents, determine the fictional group within which the repair part belongs. This is necessary since illustrations are prepared for functional groups and listings are divided into the same groups.

(2) *Second.* Find the illustration covering the functional group to which the repair part belongs.

(3) *Third.* Identify the repair part on the illustration and note the illustration figure and item number of the repair part.

(4) *Fourth.* Using the Repair Parts Listing, find the figure and item number noted on the illustration.

b. When National stock number or part number is known.

(1) *First.* Using the Index of National Stock Numbers and Part Numbers, find the pertinent National stock number or part number. This index is in ascending NIIN sequence followed by a list of part numbers in ascending alphabetic sequence, cross-referenced to the illustration figure number and item number.

(2) *Second.* After finding the figure and item number, locate the figure and item number in the repair parts list.

6. Abbreviations

Not applicable.

(Next printed page is 4)

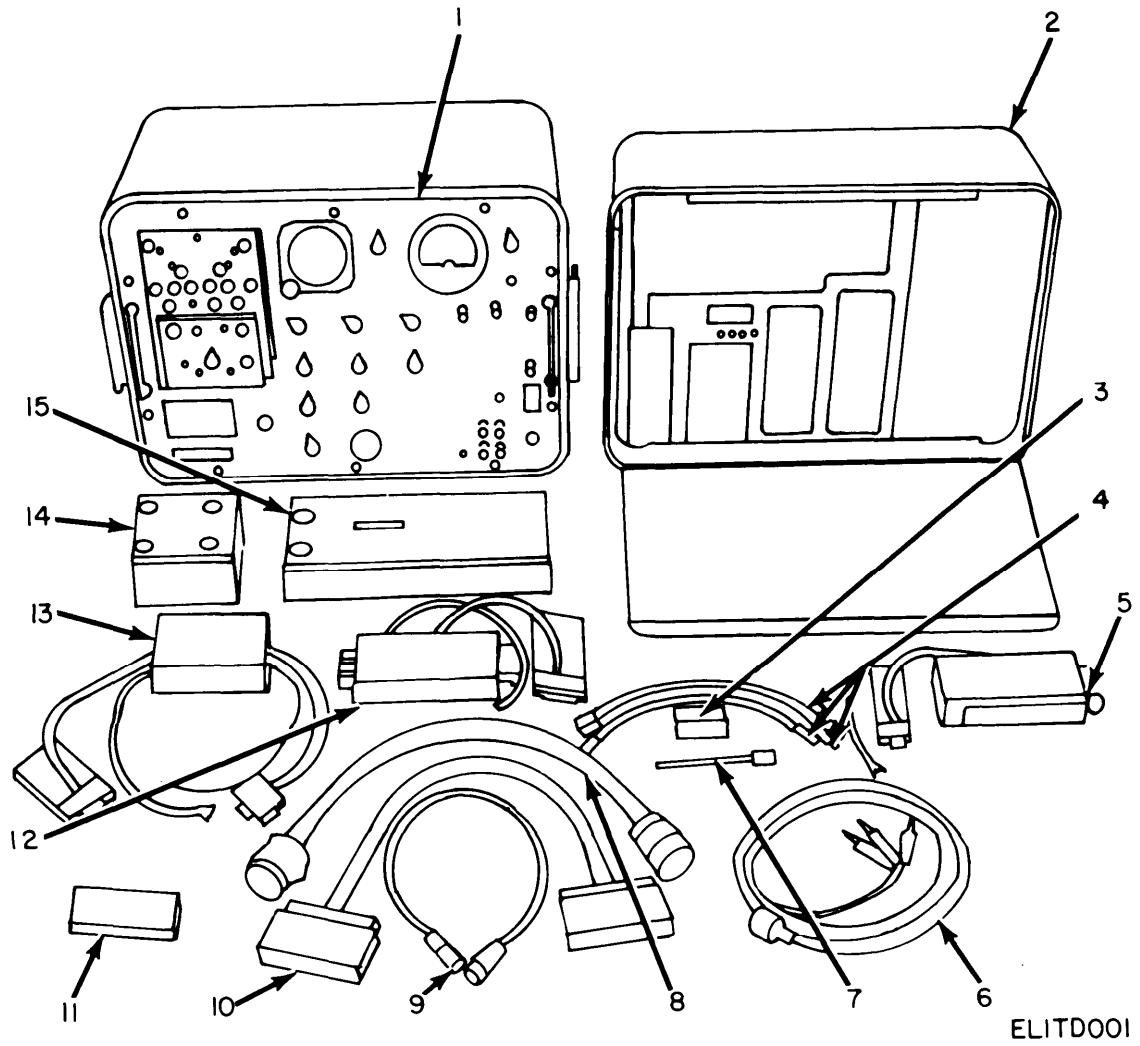
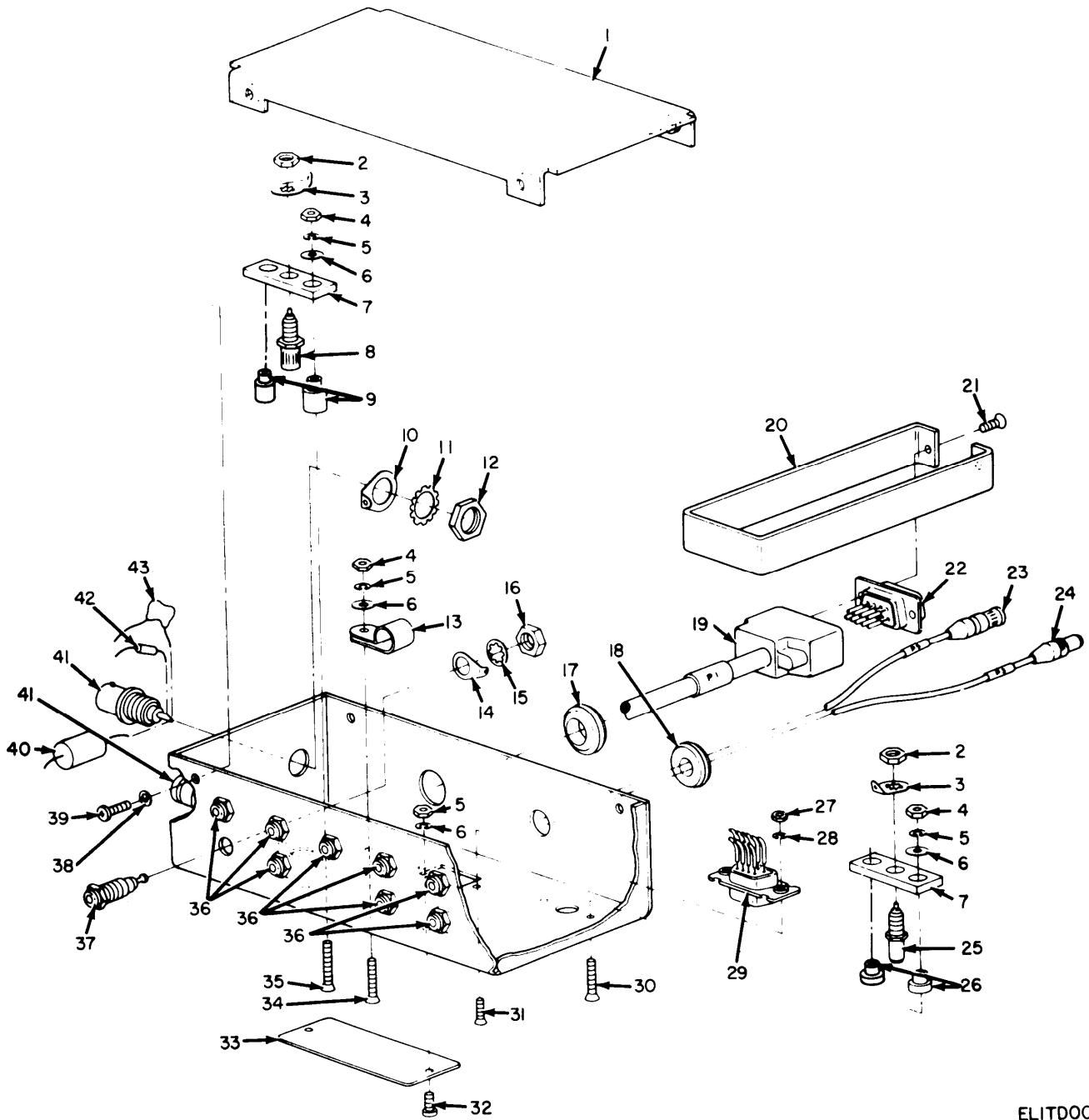

Figure 1. Maintenance Kit, Electronic Equipment MK-733/ARC-54.

SECTION II

TM11-6625-601-34P

(1) ILLUSTRATION (A) FIG NO	(2) (B) ITEM NO	(3) SMR CODE	(4) NATIONAL STOCK NUMBER	(5) PART NUMBER	(6) FSCM	(7) DESCRIPTION	USABLE ON CODE	(8) QTY INC IN UNIT
						GROUP 00 MAINTENANCE KIT,ELECTRONIC EQUIPMENT MK-733/ARC-54		
1	1	PDOFD	6625-00-901-2972	TS-1967/ARC-54	80058	TEST SET,RADIO TS-1967/ARC-54	EA	1
1	2	XDOFD	6625-00-906-1171	CW-711/ARC-54	80058	CASE,MAINTENANCE CW-711/ARC-54	EA	1
1	3	PAOZZ	5821-00-001-8571	UG-1678/U	80058	ADAPTER,CONNECTOR UG-1678/U	EA	1
1	4	PAOFF	5995-00-933-5782	CG-409G/U	80058	CABLE ASSEMBLY CG-409G/U	EA	3
1	5	PAOFF	6625-00-906-1175	MX-4930/ARC-54	80058	EXTENDER MODULE MX-4930/ARC-54	EA	1
1	6	PAOFF	5995-00-901-4340	CX-11136/ARC-54	80058	CABLE ASSEMBLY CX-11136/ARC-54	EA	1
1	7	PAOFF	5985-00-985-9023	AS-1487/ARC-54	80058	ANTENNA AS-1487/ARC-54	EA	1
1	8	PAOFF	5995-00-901-4335	CX-9071/ARC-54	80058	CABLE ASSEMBLY CX-9071/ARC-54	EA	1
1	9	PAOFF	5995-00-901-4334	CX-9070/ARC-54	80058	CABLE ASSEMBLY CX-9070/ARC-54	EA	1
1	10	PAOFF	5995-00-901-4337	CX-9072/ARC-54	80058	CABLE ASSEMBLY CX-9072/ARC-54	EA	1
1	11	PDODD	5180-00-900-8041	TK-156/ARC-54	80058	TOOL KIT,ELECTRONIC EQUIPMENT TK-156/ARC-54	EA	1
1	12	PAOFF	6625-00-906-1174	MX-4931/ARC-54	80058	EXTENDER MODULE MX-4931/ARC-54	EA	1
1	13	PAOFF	6625-00-906-1177	MX-4934/ARC-54	80058	EXTENDER MODULE MX-4934/ARC-54	EA	1
1	14	PAOFF	6625-00-906-1176	MX-4932/ARC-54	80058	EXTENDER MODULE MX-4932/ARC-54	EA	1
1	15	PAOFF	6625-00-906-1173	MX-4933/ARC-54	80058	EXTENDER MODULE MX-4933/ARC-54	EA	1



ELITD002

Figure 2. Extender Module MX-4930/ARC-54.

SECTION II

TM11-6625-601-34P

(1) ILLUSTRATION (A) FIG NO	(2) (B) ITEM NO	(3) SMR CODE	(4) NATIONAL STOCK NUMBER	(5) PART NUMBER	(6) FSCM	(7) DESCRIPTION	(8) QTY INC IN UNIT
						GROUP 01 EXTENDER MODULE MX-4930/ARC-54	
2	1	XDFZZ		SMD-504766	80063	COVER, EXTENDER MODULE MX4930	EA 1
2	2	XDFZZ		RAYC504067-1	30972	NUT, PLAIN, HEXAGON	EA 2
2	3	XDFZZ		RAYC504031-2	30972	TERMINAL, LUG	EA 2
2	4	PAFZZ	5310-00-934-9748	MS35649-244	96906	NUT, PLAIN, HEXAGON	EA 7
2	5	PAFZZ	5310-00-933-8118	MS35338-135	96906	WASHER, LOCK	EA 7
2	6	PAFZZ	5310-00-782-1349	MS15795-804	96906	WASHER, FLAT	EA 5
2	7	XDFZZ		SMC-504760	80063	PLATE, RETAINING, ELECTRICAL CONNECTOR	EA 2
2	8	PAFZZ	5935-00-963-1432	Y500	94375	CONNECTOR, RECEPTACLE, ELECTRICAL	EA 1
2	9	XDFZZ		SMC-504745-1	80063	SPACER, SLEEVE, STEPPED	EA 2
2	10	XDFZZ		SMC-504800	80063	TERMINAL, LUG	EA 2
2	11	XDFZZ		RAYM39012-21-1-2	30972	WASHER, LOCK	EA 2
2	12	XDFZZ		RAYM39012-21-1-1	30972	NUT, PLAIN, HEXAGON	EA 2
2	13	XDFZZ		SMD-504037-2	80063	CLAMP, LOOP	EA 1
2	14	PAFZZ	5940-00-665-5592	4012	77147	TERMINAL, LUG	EA 3
2	15	XDFZZ		RAYMS16108-1-2	30972	WASHER, LOCK	EA 9
2	16	PAFZZ	5310-00-245-7801	RAYMS16108-1-1	30972	NUT, PLAIN, HEXAGON	EA 9
2	17	PAFZZ	5325-00-248-7031	911	75543	GROMMET, RUBBER	EA 1
2	18	PAFZZ	5325-00-263-6632	MS35489-6	96906	GROMMET, RUBBER	EA 1
2	19	XDFZZ		SMC-504820-1	80063	SHIELD, ELECTRICAL CONNECTOR	EA 1
2	20	XDFZZ		SMC-504770-1	80063	HANDLE, EXTENDER MODULE	EA 1
2	21	PAFZZ	5305-00-763-7822	MS51959-14	96906	SCREW, MACHINE	EA 2
2	22	PAFZZ	5935-00-769-4066	DE-9P-C33	71468	CONNECTOR, PLUG, ELECTRICAL	EA 1
2	23	PAFZZ	5935-00-944-7169	31-53	98278	CONNECTOR, PLUG, ELECTRICAL	EA 1
2	24	PAFZZ	5935-00-950-0365	S0S50-32-55	98278	CONNECTOR, PLUG, ELECTRICAL	EA 1
2	25	PAFZZ	5935-00-881-9480	357-9308-00	13499	CONNECTOR, RECEPTACLE, ELECTRICAL	EA 1
2	26	XDFZZ		SMC-504745-2	80063	SPACER, SLEEVE, STEPPED	EA 2
2	27	PAFZZ	5310-00-938-2013	MS35649-224	96906	NUT, PLAIN, HEXAGON	EA 2
2	28	PAFZZ	5310-00-928-2690	MS35338-134	96906	WASHER, LOCK	EA 2
2	29	PAFZZ	5935-00-901-5204	DEF9S-C33	71468	CONNECTOR, RECEPTACLE, ELECTRICAL	EA 1
2	30	PAFZZ	5305-00-768-0336	MS51959-17	96906	SCREW, MACHINE	EA 2
2	31	PAFZZ	5305-00-764-2964	MS51959-4	96906	SCREW, MACHINE	EA 2
2	32	PAFZZ	5305-00-054-5647	MS51957-13	96906	SCREW, MACHINE	EA 2
2	33	XDFZZ		SMD-504913-4	80063	PLATE, IDENTIFICATION	EA 1
2	34	PAFZZ	5305-00-770-2579	MS51959-15	96906	SCREW, MACHINE	EA 1
2	35	PAFZZ	5305-00-763-7827	MS51959-18	96906	SCREW, MACHINE	EA 2
2	36	PAFZZ	5935-00-728-4514	M39024-10-01	81349	JACK, TIP, WHITE	EA 8
2	37	PAFZZ	5935-00-762-0312	M39024-10-03	81349	JACK, TIP, BLACK	EA 1
2	38	XDFZZ		SMB-504707	80063	WASHER, FLAT	EA 4
2	39	PAFZZ	5305-00-054-5648	MS51957-14	96906	SCREW, MACHINE	EA 4

SECTION II

TM11-6625-601-34P

(1) ILLUSTRATION (A) FIG NO	(B) ITEM NO	(2) SMR CODE	(3) NATIONAL STOCK NUMBER	(4) PART NUMBER	(5) FSCM	(6) DESCRIPTION	(7) USABLE ON CODE	(8) QTY INC IN UNIT
2	40	PAFZZ	5950-00-820-1227	SMC-508340-1	80063	CHOKE,RADIO FREQUENCY	EA	1
2	41	PAFZZ	5935-00-552-7660	UG625B/U	80058	CONNECTOR,RECEPTACLE,ELECTRICAL	EA	2
2	42	PAFZZ	5905-00-615-5217	RC07GF273J	81349	RESISTOR,FIXED,COMPOSITION	EA	1
2	43	PAFZZ	5910-00-051-4612	CM05ED220J03	81349	CAPACITOR,FIXED,MICA	EA	1

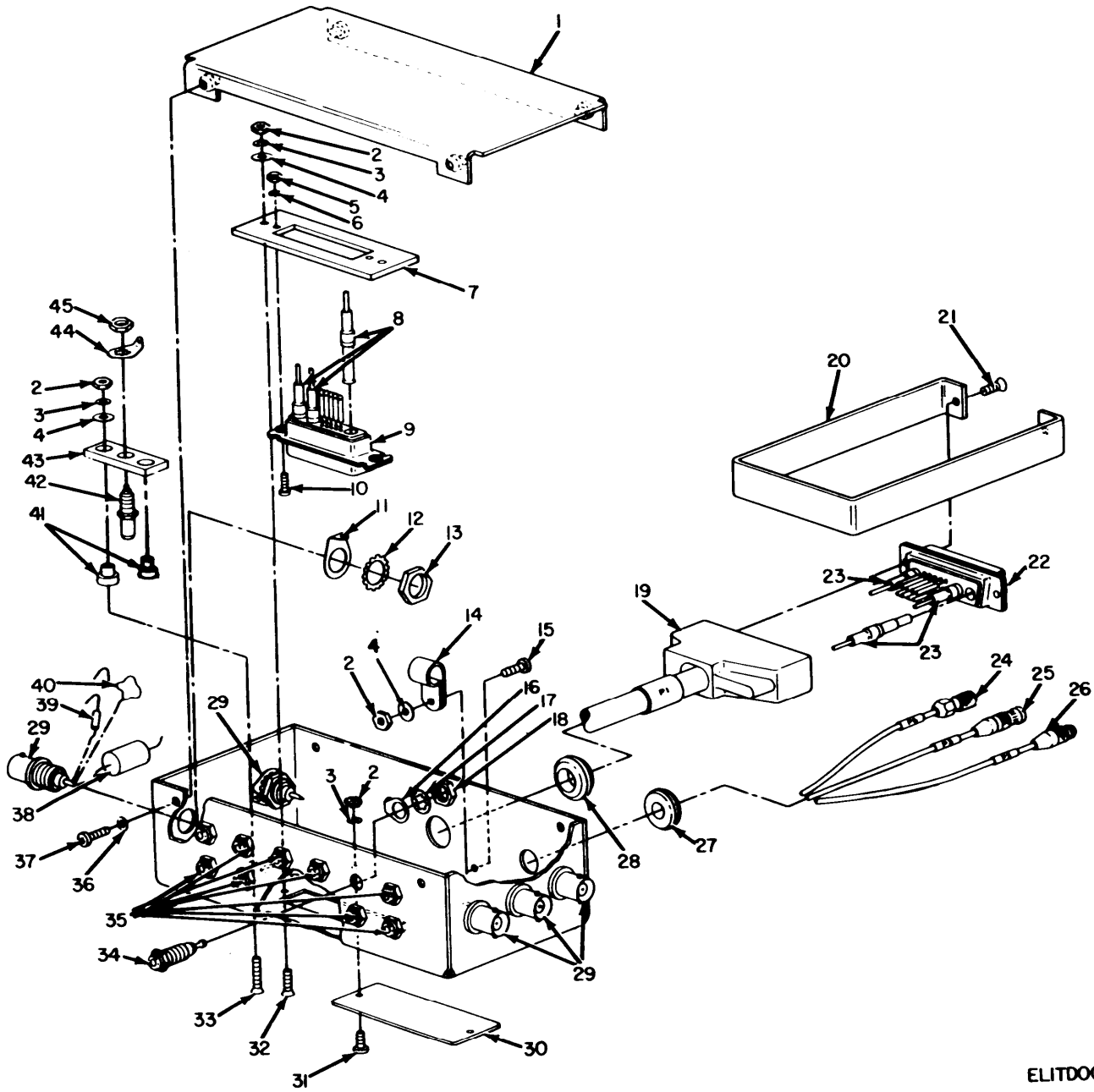

ELITD003

Figure 3. Extender Module MX-4931/ARC-54.

SECTION II

TM11-6625-601-34P

(1) ILLUSTRATION (A) FIG NO	(2) (B) ITEM NO	(3) SMR CODE	(4) NATIONAL STOCK NUMBER	(5) PART NUMBER	(6) FSCM	DESCRIPTION	USABLE ON CODE	(7) U/M	(8) QTY INC IN UNIT
						GROUP 02 EXTENDER MODULE MX-4931/ARC-54			
3	1	XDFZZ		SMD-504766	80063	COVER, EXTENDER MODULE		EA	1
3	2	PAFZZ	5310-00-934-9748	MS35649-244	96906	NUT, PLAIN, HEXAGON		EA	7
3	3	PAFZZ	5310-00-933-8118	MS35338-135	96906	WASHER, LOCK		EA	6
3	4	PAFZZ	5310-00-782-1349	MS15795-804	96906	WASHER, FLAT		EA	5
3	5	PAFZZ	5310-00-938-2013	MS35649-224	96906	NUT, PLAIN, HEXAGON		EA	2
3	6	PAFZZ	5310-00-928-2690	MS35338-134	96906	WASHER, LOCK		EA	2
3	7	XDFZZ		SMC-504732	80063	PLATE, RETAINING, ELECTRICAL CONNECTOR		EA	1
3	8	PAFZZ	5999-00-944-4742	DM53742-5029	71468	CONNECTOR, PLUG, ELECTRICAL		EA	3
3	9	XDFZZ	5435-00-089-1165	SMD-504366	80063	CONNECTOR, RECEPTACLE, ELECTRICAL		EA	1
3	10	PAFZZ	5305-00-054-5637	MS51957-3	96906	SCREW, MACHINE		EA	2
3	11	XDFZZ		SMC-504800	80063	TERMINAL, LUG		EA	5
3	12	XDFZZ		RAYM39012-21-1-2	30972	WASHER, LOCK		EA	5
3	13	XDFZZ		RATM39012-21-1-1	30972	NUT, PLAIN, HEXAGON		EA	5
3	14	XDFZZ		SMC-508365-2	80063	CLAMP, LOOP		EA	1
3	15	PAFZZ	5305-00-054-5649	MS51957-15	96906	SCREW, MACHINE		EA	1
3	16	PAFZZ	5940-00-665-5592	4012	77147	TERMINAL, LUG		EA	1
3	17	XDFZZ		RAYMS16108-1-2	30972	WASHER, LOCK		EA	10
3	18	PAFZZ	5310-00-245-7801	RAYMS16108-1-1	30972	NUT, PLAIN, HEXAGON		EA	10
3	19	XDFZZ	5935-00-052-3758	371-0290-00	13499	SHIELD, ELECTRICAL CONNECTOR		EA	1
3	20	XDFZZ		SMC-504770-2	80063	HANDLE, EXTENDER MODULE		EA	1
3	21	PAFZZ	5305-00-763-7822	MS51959-14	96906	SCREW, MACHINE		EA	2
3	22	PAFZZ	5935-00-811-1382	DBM13W3PC27	71468	CONNECTOR, RECEPTACLE, ELECTRICAL		EA	1
3	23	PAFZZ	5935-00-941-9642	DM53740-5035	71468	CONNECTOR, PLUG, ELECTRICAL		EA	3
3	24	PAFZZ	5935-00-950-0365	S0S50-32-55	98278	CONNECTOR, PLUG, ELECTRICAL		EA	1
3	25	PAFZZ	5935-00-685-9816	357-9227-000	13499	CONNECTOR, PLUG, ELECTRICAL		EA	1
3	26	XDFZZ		SMC-508376	80063	CONNECTOR, PLUG, ELECTRICAL		EA	1
3	27	PAFZZ	5325-00-248-7031	911	75543	GROMMET, RUBBER		EA	1
3	28	PAFZZ	5325-00-263-6632	MS35489-6	96906	GROMMET, RUBBER		EA	1
3	29	PAFZZ	5935-00-552-7660	UG625B/U	80058	CONNECTOR, RECEPTACLE, ELECTRICAL		EA	5
3	30	XDFZZ		SMD-504913-5	80063	PLATE, IDENTIFICATION		EA	1
3	31	PAFZZ	5305-00-054-5647	MS51957-13	96906	SCREW, MACHINE		EA	2
3	32	PAFZZ	5305-00-764-2964	MS51959-4	96906	SCREW, MACHINE		EA	2
3	33	PAFZZ	5305-00-763-7827	MS51959-18	96906	SCREW, MACHINE		EA	2
3	34	PAFZZ	5935-00-762-0312	M39024-10-03	81349	JACK, TIP, BLACK		EA	1
3	35	PAFZZ	5935-00-728-4514	M39024-10-01	81349	JACK, TIP, WHITE		EA	9
3	36	XDFZZ		SMB-504707	80063	WASHER, FLAT		EA	4
3	37	PAFZZ	5305-00-054-5648	MS51957-14	96906	SCREW, MACHINE		EA	4
3	38	PAFZZ	5950-00-820-1227	SMC-508340-1	80063	CHOKE, RADIO FREQUENCY		EA	1
3	39	PAFZZ	5905-00-615-5217	RC07GF273J	81349	RESISTOR, FIXED, COMPOSITION		EA	1

SECTION II

TM11-6625-601-34P

(1) ILLUSTRATION (A) FIG NO	(B) ITEM NO	(2) SMR CODE	(3) NATIONAL STOCK NUMBER	(4) PART NUMBER	(5) FSCM	(6) DESCRIPTION	(7) USABLE ON CODE	U/M	(8) QTY INC IN UNIT
3	40	PAFZZ	5910-00-954-1772	CM05E470J03	81349	CAPACITOR, FIXED, MICA	EA	1	
3	41	XDFZZ		SMC-504745-4	80063	SPACER, SLEEVE, STEPPED	EA	2	
3	42	PAFZZ	5935-00-881-9480	357-9308-00	13499	CONNECTOR, RECEPTACLE, ELECTRICAL	EA	1	
3	43	XDFZZ		SMC-504760	80063	PLATE, RETAINING, ELECTRICAL CONNECTOR	EA	1	
3	44	XDFZZ		RAYC504031-2	30972	TERMINAL, LUG	EA	1	
3	45	PAFZZ	5310-00-231-8965	RAYC504031-1	30972	NUT, PLAIN, HEXAGON	EA	1	

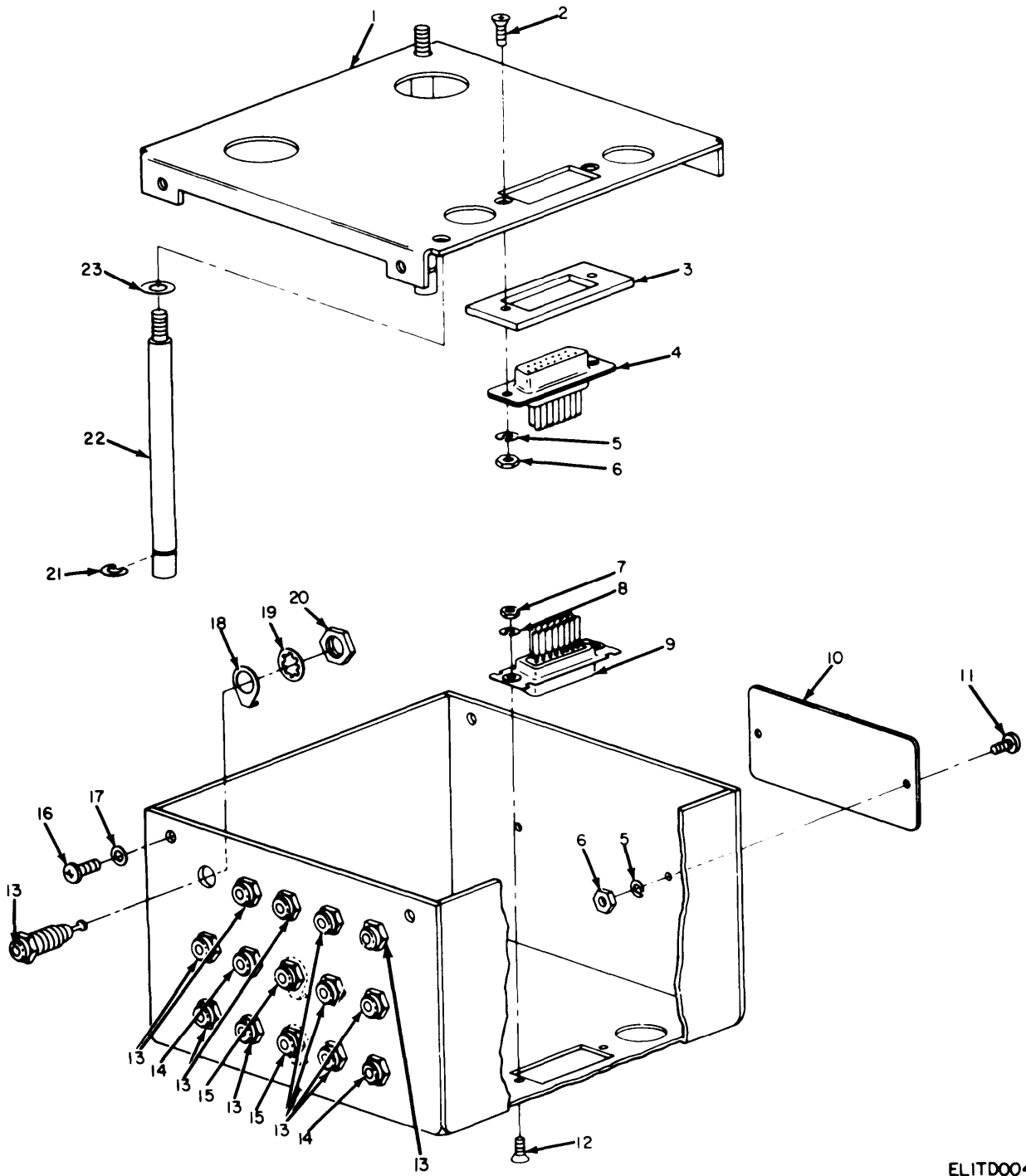

ELIT0004

Figure 4. Extender Module MX-4932//ARC-54.

SECTION II

TM11-6625-601-34P

(1) ILLUSTRATION (A) FIG NO	(2) SMR CODE	(3) NATIONAL STOCK NUMBER	(4) PART NUMBER	(5) FSCM	(6) DESCRIPTION	(7) USABLE ON CODE	(8) QTY INC IN UNIT
					GROUP 03 EXTENDER MODULE MX-4932/ARC-54		
4	1	XDFZZ	SMD-504737	80063	COVER, EXTENDER MODULE	EA	1
4	2	PAFZZ	5305-00-763-7822	MS51959-14	96906 SCREW, MACHINE	EA	2
4	3	XDFZZ	SMC-504744	80063	PLATE, RETAINING, CONNECTOR	EA	1
4	4	XDFZZ	SMC-504466-2	80063	CONNECTOR, RECEPTACLE, ELECTRICAL	EA	1
4	5	PAFZZ	5310-00-933-8118	MS35338-135	96906 WASHER, LOCK	EA	4
4	6	PAFZZ	5310-00-225-3072	SMB-438860	80063 NUT, PLAIN, HEXAGON	EA	4
4	7	PAFZZ	5310-00-938-2013	MS35649-224	96906 NUT, PLAIN, HEXAGON	EA	2
4	8	PAFZZ	5310-00-928-2690	MS35338-134	96906 WASHER, LOCK	EA	2
4	9	PAFZZ	5935-00-989-2546	DAF155C33	80063 CONNECTOR, RECEPTACLE, ELECTRICAL	EA	1
4	10	XDFZZ	SMD-504913	80063	PLATE, IDENTIFICATION	EA	1
4	11	PAFZZ	5305-00-054-5647	MS51957-13	96906 SCREW, MACHINE	EA	2
4	12	PAFZZ	5305-00-764-2964	MS51959-4	96906 SCREW, MACHINE	EA	2
4	13	PAFZZ	5935-00-728-4514	M39024-10-01	81349 JACK, TIP, WHITE	EA	11
4	14	PAFZZ	5935-00-702-4199	M39024-10-02	81349 JACK, TIP, RED	EA	2
4	15	PAFZZ	5935-00-762-0312	MS39024-10-03	81349 JACK, TIP, BLACK	EA	2
4	16	PAFZZ	5305-00-054-5648	MS51957-14	96906 SCREW, MACHINE	EA	4
4	17	XDFZZ	SMB-504707	80063	WASHER, FLAT	EA	4
4	18	PAFZZ	5940-00-665-5592	4012	77147 TERMINAL, LUG	EA	4
4	19	XDFZZ	RAYMS16108-1-2	30972	WASHER, LOCK	EA	15
4	20	PAFZZ	5310-00-245-7801	RAYMS16108-1-1	30972 NUT, PLAIN, HEXAGON	EA	15
4	21	PAFZZ	5365-00-993-5303	MS16632-1021	96906 RING, RETAINING	EA	2
4	22	PAFZZ	5305-00-419-0895	SMC-504748-1	80063 SCREW, MACHINE, SPECIAL	EA	2
4	23	XDFZZ	SMB-504787	80063	WASHER, FLAT	EA	2

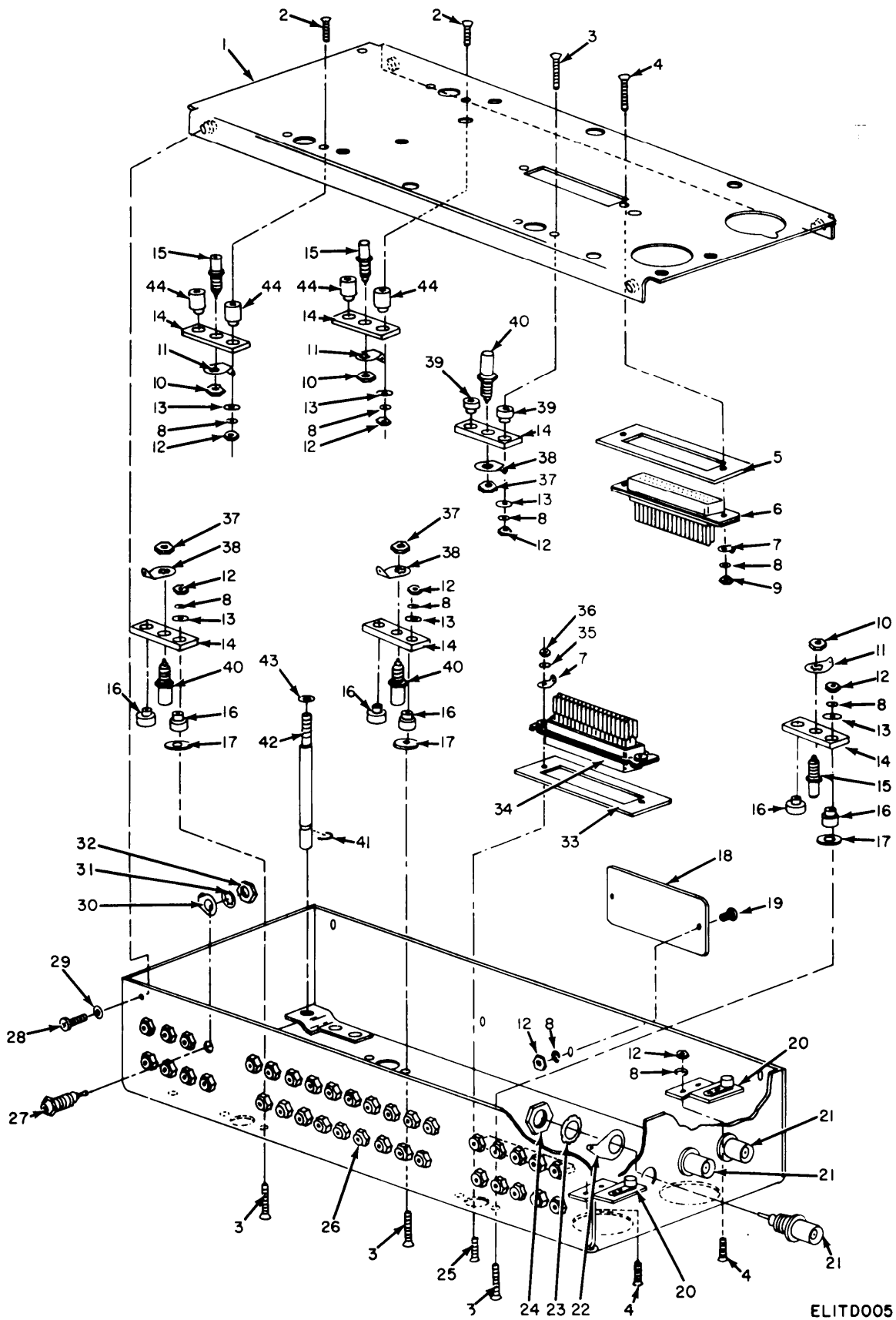

Figure 5. Extender Module MX-4933/ARC-54.

SECTION II

TM11-6625-601-34P

(1) ILLUSTRATION (A) FIG NO	(2) (B) ITEM NO	(3) SMR CODE	(4) NATIONAL STOCK NUMBER	(5) PART NUMBER	(6) FSCM DESCRIPTION	(7) USABLE ON CODE U/M	(8) QTY INC IN UNIT
					GROUP 04 EXTENDER MODULE MX-4933/ARC-54		
5	1	XDFZZ		SMD-504947	80063 COVER, EXTENDER MODULE	EA	1
5	2	PAFZZ	5305-00-763-7827	MS51959-18	96906 SCREW, MACHINE	EA	4
5	3	PAFZZ	5305-00-768-0336	MS51959-17	96906 SCREW, MACHINE	EA	6
5	4	PAFZZ	5305-00-770-2579	MS51959-15	96906 SCREW, MACHINE	EA	6
5	5	XDFZZ		SMC-504747-2	80063 PLATE, RETAINING, ELECTRICAL CONNECTOR	EA	1
5	6	PAFZZ	5935-00-686-3635	SMC-394465	80063 CONNECTOR, RECEPTACLE, ELECTRICAL	EA	1
5	7	PAFZZ		SMC-504699	80063 TERMINAL, LUG	EA	2
5	8	PAFZZ	5310-00-933-8118	MS35338-135	96906 WASHER, LOCK	EA	20
5	9	PAFZZ	5310-00-225-3072	SMB-438860	80063 NUT, PLAIN, HEXAGON	EA	6
5	10	XDFZZ		RAYC504067-1	30972 NUT, PLAIN, HEXAGON	EA	3
5	11	XDFZZ		RAYC504067-2	30972 TERMINAL, LUG	EA	3
5	12	PAFZZ	5310-00-934-9748	MS35649-244	96906 NUT, PLAIN, HEXAGON	EA	14
5	13	PAFZZ	5310-00-782-1349	MS15795-804	96906 WASHER, FLAT	EA	8
5	14	XDFZZ		SMC-504760	80063 PLATE, RETAINING, ELECTRICAL CONNECTOR	EA	6
5	15	PAFZZ	5935-00-963-1432	Y500	94375 CONNECTOR, RECEPTACLE, ELECTRICAL	EA	3
5	16	XDFZZ		SMC-504745-3	80063 SPACER, SLEEVE, STEPPED	EA	6
5	17	XDFZZ		SMB-504724	80063 WASHER, FLAT	EA	3
5	18	XDFZZ		SMD-504913-7	80063 PLATE, IDENTIFICATION	EA	1
5	19	PAFZZ	5305-00-054-5647	MS51957-13	96906 SCREW, MACHINE	EA	2
5	20	XDFZZ		SMC-504823	80063 BRACKET, ANGLE	EA	2
5	21	PAFZZ	5935-00-552-7660	UG625B/U	80058 CONNECTOR, RECEPTACLE, ELECTRICAL	EA	3
5	22	XDFZZ		SMC-504800	80063 TERMINAL, LUG	EA	3
5	23	XDFZZ		RAYM39012-21-1-2	30972 WASHER, LOCK	EA	3
5	24	XDFZZ		RAYM39012-21-1-1	30972 NUT, PLAIN, HEXAGON	EA	3
5	25	PAFZZ	5305-00-725-4191	MS51959-7	96906 SCREW, MACHINE	EA	2
5	26	PAFZZ	5935-00-728-4514	M39024-10-01	81349 JACK, TIP, WHITE	EA	36
5	27	PAFZZ	5935-00-762-0312	M39024-10-03	81349 JACK, TIP, BLACK	EA	1
5	28	PAFZZ	5305-00-054-5648	MS51957-14	96906 SCREW, MACHINE	EA	4
5	29	XDFZZ		SMB-504707	80063 WASHER, FLAT	EA	4
5	30	PAFZZ	5940-00-665-5592	4012	77147 TERMINAL, LUG	EA	1
5	31	XDFZZ		RAYMS16108-1-2	30972 WASHER, LOCK	EA	37
5	32	PAFZZ	5310-00-245-7801	RAYMS16108-1-1	30972 NUT, PLAIN, HEXAGON	EA	37
5	33	XDFZZ		SMC-504727-1	80063 PLATE, RETAINING, ELECTRICAL CONNECTOR	EA	1
5	34	PAFZZ	5935-00-989-4399	DCF37S-C33	71468 CONNECTOR, RECEPTACLE, ELECTRICAL	EA	1
5	35	PAFZZ	5310-00-928-2690	MS35338-134	96906 WASHER, LOCK	EA	2
5	36	PAFZZ	5310-00-938-2013	MS35649-224	96906 NUT, PLAIN, HEXAGON	EA	2
5	37	PAFZZ	5310-00-231-8965	RAYC504031-1	30972 NUT, PLAIN, HEXAGON	EA	3
5	38	XDFZZ		RAYC504031-2	30972 TERMINAL, LUG	EA	3
5	39	XDFZZ		SMC-504745-2	80063 SPACER, SLEEVE, STEPPED	EA	2

SECTION II

TM11-6625-601-34P

(1) ILLUSTRATION (A) FIG NO	(B) ITEM NO	(2) SMR CODE	(3) NATIONAL STOCK NUMBER	(4) PART NUMBER	(5) FSCM	(6) DESCRIPTION	(7) USABLE ON CODE	U/M	(8) QTY INC IN UNIT
5	40	PAFZZ	5935-00-881-9480	357-9308-00	13499	CONNECTOR, PLUG, ELECTRICAL		EA	3
5	41	PAFZZ	5365-00-993-5303	MS16632-1021	96906	RING, RETAINING		EA	2
5	42	PAFZZ	5305-00-419-0896	SMC-504748-2	80063	SCREW, MACHINE, SPECIAL		EA	2
5	43	PAFZZ	5310-00-221-0230	SMB-504789	80063	WASHER, FLAT		EA	2
5	44	XDFZZ		SMC-504745-5	80063	SPACER, SLEEVE, STEPPED		EA	4

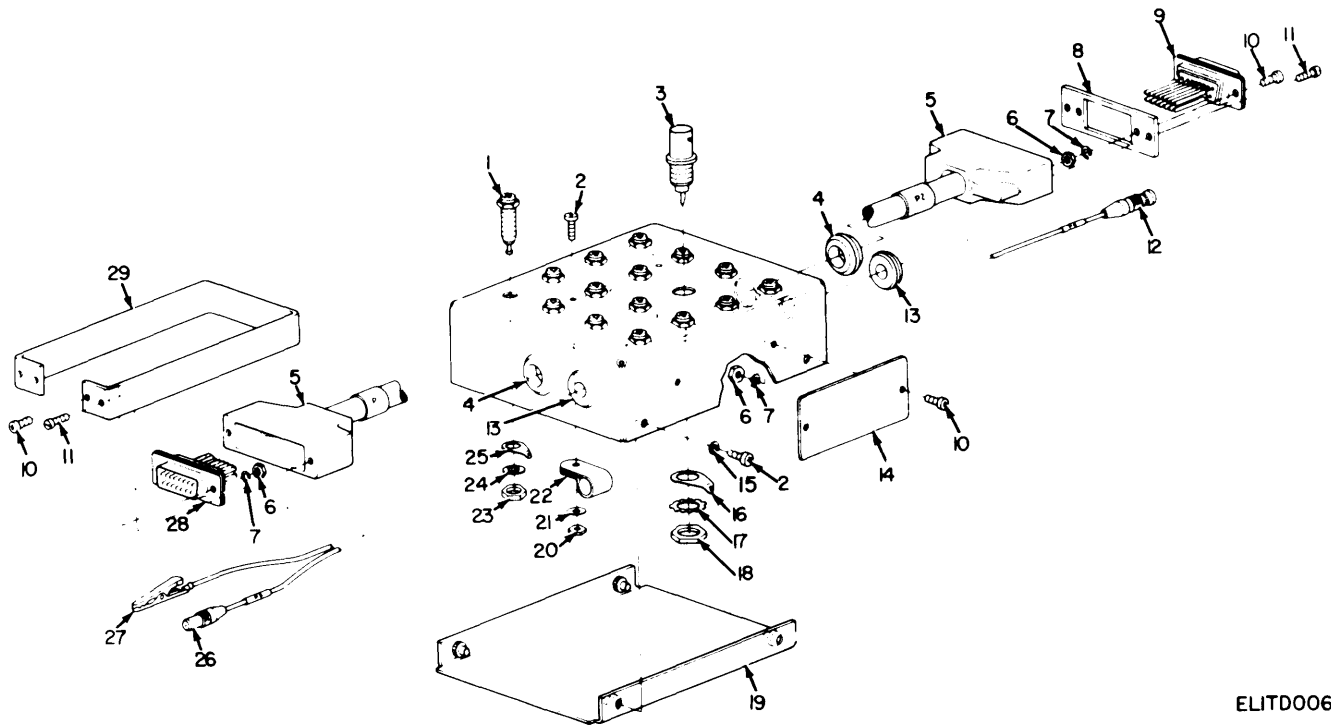

ELITD006

Figure 6. Extender Module MX-4934/ARC-54.

SECTION II

TM11-6625-601-34P

(1) ILLUSTRATION (A) FIG NO	(2) (B) ITEM NO	(3) SMR CODE	(4) NATIONAL STOCK NUMBER	(5) PART NUMBER	(6) FSCM	(7) DESCRIPTION	USABLE ON CODE	(8) QTY INC IN UNIT
						GROUP 05 EXTENDER MODULE MX-4934/ARC-54		
6	1	PAFZZ	5935-00-728-4514	M39024-10-01	81349	JACK,TIP,WHITE	EA	15
6	2	PAFZZ	5305-00-054-5648	MS51957-14	96906	SCREW,MACHINE	EA	6
6	3	PAFZZ	5935-00-552-7660	UG625B/U	80058	CONNECTOR,RECEPTACLE,ELECTRICAL	EA	1
6	4	PAFZZ	5325-00-263-6632	MS35489-6	96906	GROMMET,RUBBER	EA	2
6	5	XDFZZ	5935-00-052-3758	371-0290-00	13499	SHIELD,ELECTRICAL CONNECTOR	EA	2
6	6	PAFZZ	5310-00-225-3072	SMB-438860	80063	NUT,PLAIN,HEXAGON	EA	6
6	7	PAFZZ	5310-00-933-8118	MS35338-135	96906	WASHER,LOCK	EA	6
6	8	XDFZZ		SMC-504731	80063	PLATE,RETAINING,ELECTRICAL CONNECTOR	EA	1
6	9	PAFZZ	5935-00-719-1029	DAM15S037	71468	CONNECTOR,PLUG,ELECTRICAL	EA	1
6	10	PAFZZ	5305-00-054-5647	MS51957-13	96906	SCREW,MACHINE	EA	6
6	11	XDFZZ		RAYC504820-1	30972	SCREW,MACHINE,RETURN HEAD	EA	4
6	12	PAFZZ	5935-00-950-0365	SOS50-32-55	98278	CONNECTOR,PLUG,ELECTRICAL	EA	1
6	13	PAFZZ	5325-00-290-6163	MS35489-13	96906	GROMMET,RUBBER	EA	2
6	14	XDFZZ		SMD-504913-8	80063	PLATE,IDENTIFICATION	EA	1
6	15	XDFZZ		SMB-504707	80063	WASHER,FLAT	EA	4
6	16	XDFZZ		SMC-504800	80063	TERMINAL,LUG	EA	1
6	17	XDFZZ		RAYM39012-21-1-2	30972	WASHER,LOCK	EA	1
6	18	XDFZZ		RAYM39012-21-1-1	30972	NUT,PLAIN,HEXAGON	EA	1
6	19	XDFZZ		SMC-504875	80063	COVER,EXTENDER MODULE	EA	1
6	20	PAFZZ	5310-00-934-9748	MS35649-244	96906	NUT,PLAIN,HEXAGON	EA	2
6	21	PAFZZ	5310-00-782-1349	MS15795-804	96906	WASHER,FLAT	EA	2
6	22	PAFZZ	5340-00-969-6501	SMC-508365-3	80063	CLAMP,LOOP	EA	2
6	23	PAFZZ	5310-00-245-7801	RAYMS16108-1-1	30972	NUT,PLAIN,HEXAGON	EA	15
6	24	XDFZZ		RAYMS16108-1-2	30972	WASHER,LOCK	EA	15
6	25	PAFZZ	5940-00-665-5592	4012	77147	TERMINAL,LUG	EA	9
6	26	PAFZZ	5935-00-944-7169	31-53	98278	CONNECTOR,PLUG,ELECTRICAL	EA	1
6	27	PAFZZ	5999-00-577-0994	30	76545	CLIP,ELECTRICAL	EA	1
6	28	XDFZZ		SMC-504466-2	80063	CONNECTOR,PLUG,ELECTRICAL	EA	1
6	29	XDFZZ		SMC-504728	80063	HANDLE,EXTENDER MODULE	EA	1

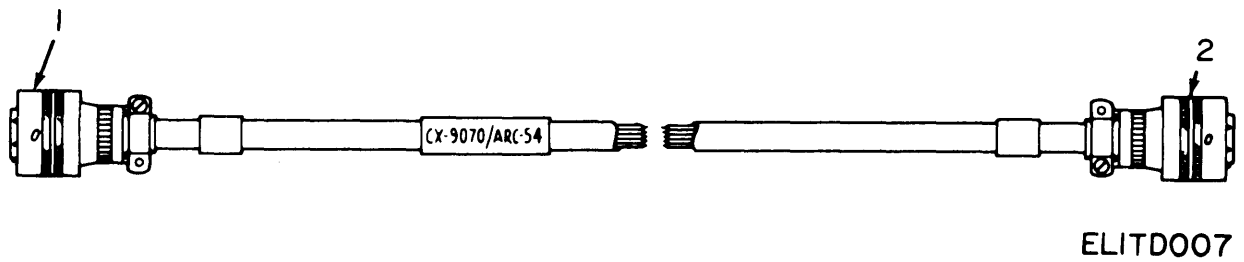

Figure 7. Cable Assembly CX-9070/ARC-54.

SECTION II

TM11-6625-601-34P

(1) ILLUSTRATION (A) FIG NO	(B) ITEM NO	(2) SMR CODE	(3) NATIONAL STOCK NUMBER	(4) PART NUMBER	(5) FSCM	(6) DESCRIPTION	(7) USABLE ON CODE	(8) QTY INC IN UNIT
						GROUP 06 CABLE ASSEMBLY CX-9070/ARC-54		
7	1	PAFZZ	5935-00-729-8687	SMD-504830	80063	CONNECTOR, PLUG, ELECTRICAL	EA	1
7	2	XDFZZ		371-6411-00	13499	CONNECTOR, PLUG, ELECTRICAL	EA	1

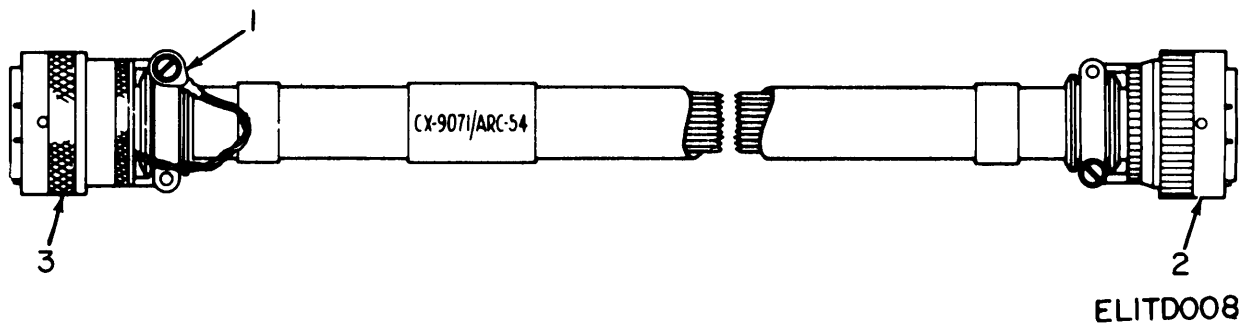

Figure 8. Cable Assembly CX-9071/ARC-54.

SECTION II

TM11-6625-601-34P

(1) ILLUSTRATION (A) FIG NO	(B) ITEM NO	(2) SMR CODE	(3) NATIONAL STOCK NUMBER	(4) PART NUMBER	(5) FSCM	(6) DESCRIPTION	(7) USABLE ON CODE	(8) QTY INC IN UNIT
						GROUP 07 CABLE ASSEMBLY CX-9071/ARC-54		
8	1	PAFZZ	5940-00-143-4774	SMC-504843	80063	TERMINAL,LUG	EA	1
8	2	XDFZZ		371-6281-00	13499	CONNECTOR,PLUG,ELECTRICAL	EA	1
8	3	XDFZZ		371-6113-000	13499	CONNECTOR,PLUG,ELECTRICAL	EA	1

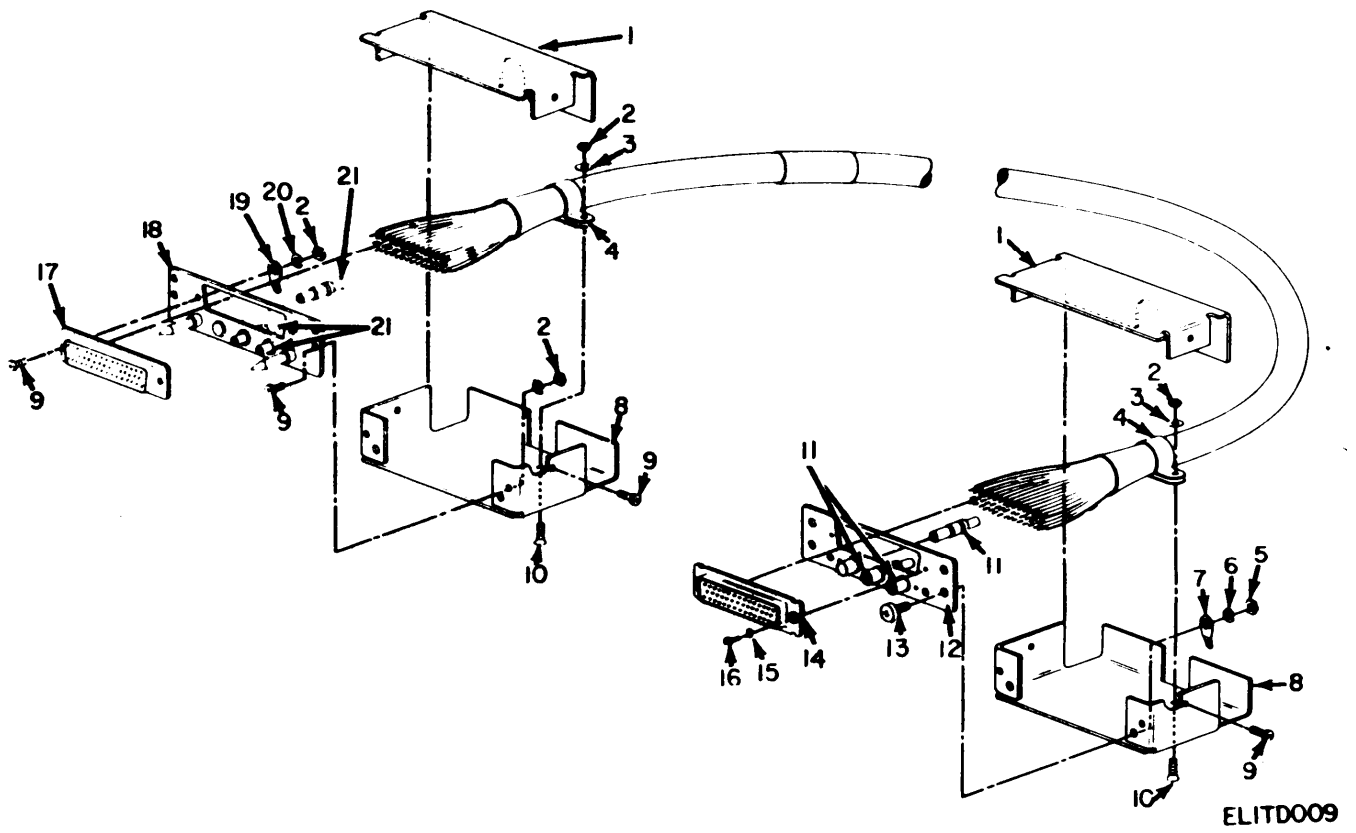

Figure 9. Cable Assembly CX-9072/ARC-54.

SECTION II

TM11-6625-601-34P

(1) ILLUSTRATION (A) FIG NO	(2) (B) ITEM NO	(3) SMR CODE	(4) NATIONAL STOCK NUMBER	(5) PART NUMBER	(6) FSCM	(7) DESCRIPTION	USABLE ON CODE	(8) QTY INC IN UNIT
						GROUP 08 CABLE ASSEMBLY CX-9072/ARC-54		
9	1	XDFZZ		SMC-504866	80063	SHIELD,ELECTRICAL CONNECTOR	EA	2
9	2	PAFZZ	5310-00-225-3072	SMB-438860	80063	NUT,PLAIN,HEXAGON	EA	6
9	3	PAFZZ	5310-00-782-1349	MS15795-804	96906	WASHER,FLAT	EA	2
9	4	PAFZZ	5340-00-337-8642	SMD-504037-4	80063	CLAMP,LOOP	EA	2
9	5	PAFZZ	5310-00-225-3071	SMB-504795	80063	NUT,PLAIN,HEXAGON	EA	2
9	6	PAFZZ	5310-00-933-8119	MS35338-137	96906	WASHER,LOCK	EA	2
9	7	XDFZZ		SMC-508325-2	80063	TERMINAL,LUG	EA	2
9	8	XDFZZ		SMD-504808	80063	SHELL,ELECTRICAL CONNECTOR	EA	2
9	9	PAFZZ	5305-00-054-5648	MS51957-14	96906	SCREW,MACHINE	EA	8
9	10	PAFZZ	5305-00-763-7822	MS51959-14	96906	SCREW,MACHINE	EA	2
9	11	PAFZZ	5999-00-944-4742	DM53742-5029	71468	CONNECTOR,PLUG,ELECTRICAL	EA	3
9	12	XDFZZ		SMD-504307	80063	PLATE,RETAINING,ELECTRICAL CONNECTOR	EA	1
9	13	PAFZZ	5305-00-054-6668	MS51957-43	96906	SCREW,MACHINE	EA	2
9	14	PAFZZ	5935-00-583-5956	371-0182-000	13499	CONNECTOR,RECEPTACLE,ELECTRICAL	EA	1
9	15	PAFZZ	5310-00-928-2690	MS35338-134	96906	WASHER,LOCK	EA	2
9	16	PAFZZ	5305-00-054-5637	MS51957-3	96906	SCREW,MACHINE	EA	2
9	17	PAFZZ	5935-00-729-7306	019606-0041	71468	CONNECTOR,RECEPTACLE,ELECTRICAL	EA	1
9	18	XDFZZ		SMD-504799	80063	PLATE,RETAINING,ELECTRICAL CONNECTOR	EA	1
9	19	XDFZZ		SMC-504699	80063	TERMINAL,LUG	EA	2
9	20	PAFZZ	5310-00-933-8118	MS35338-135	96906	WASHER,LOCK	EA	4
9	21	PAFZZ	5935-00-941-9642	DM53740-5035	71468	CONNECTOR,PLUG,ELECTRICAL	EA	3

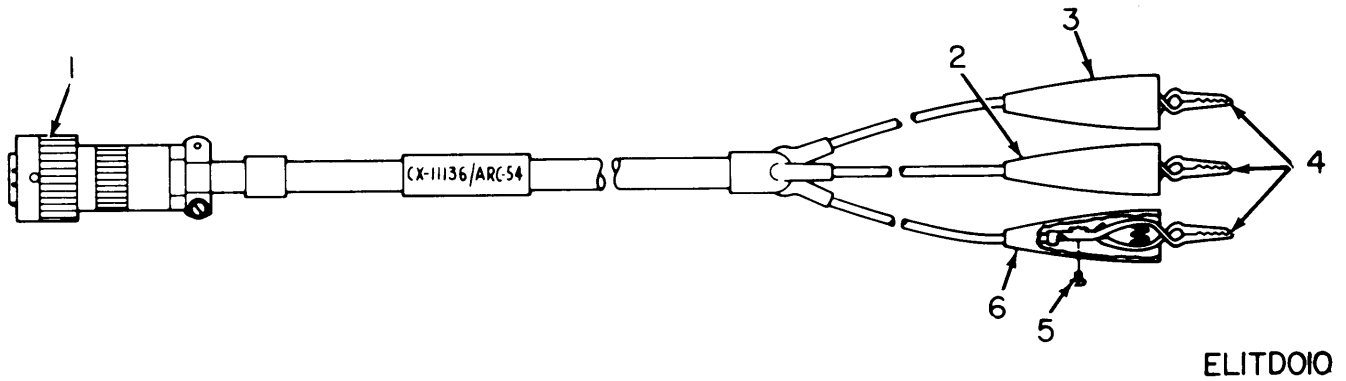

Figure 10. Cable Assembly CX-11136/ARC-54.

SECTION II

TM11-6625-601-34P

(1) ILLUSTRATION (A) FIG NO	(B) ITEM NO	(2) SMR CODE	(3) NATIONAL STOCK NUMBER	(4) PART NUMBER	(5) FSCM	(6) DESCRIPTION	(7) USABLE ON CODE	(8) QTY INC IN UNIT
						GROUP 09 CABLE ASSEMBLY CX-11136/ARC-54		
10	1	PAFZZ	5935-00-926-2955	MS3116J12-3S	96906	CONNECTOR, PLUG, ELECTRICAL	EA	1
10	2	PAFZZ	5975-00-284-7615	57	85775	CABLE NIPPLE, ELECTRICAL, BLACK	EA	1
10	3	PAFZZ	5975-00-557-2531	87-RED	85775	CABLE NIPPLE, ELECTRICAL, RED	EA	1
10	4	XDFZZ		SMC-504919	80063	CLIP, ELECTRICAL	EA	3
10	5	XDFZZ		RAYC504919-1	30972	SCREW, MACHINE, BINDING HEAD	EA	3
10	6	PAFZZ	5975-00-933-4279	363-0026-240	85775	CABLE NIPPLE, ELECTRICAL, GREEN	EA	1

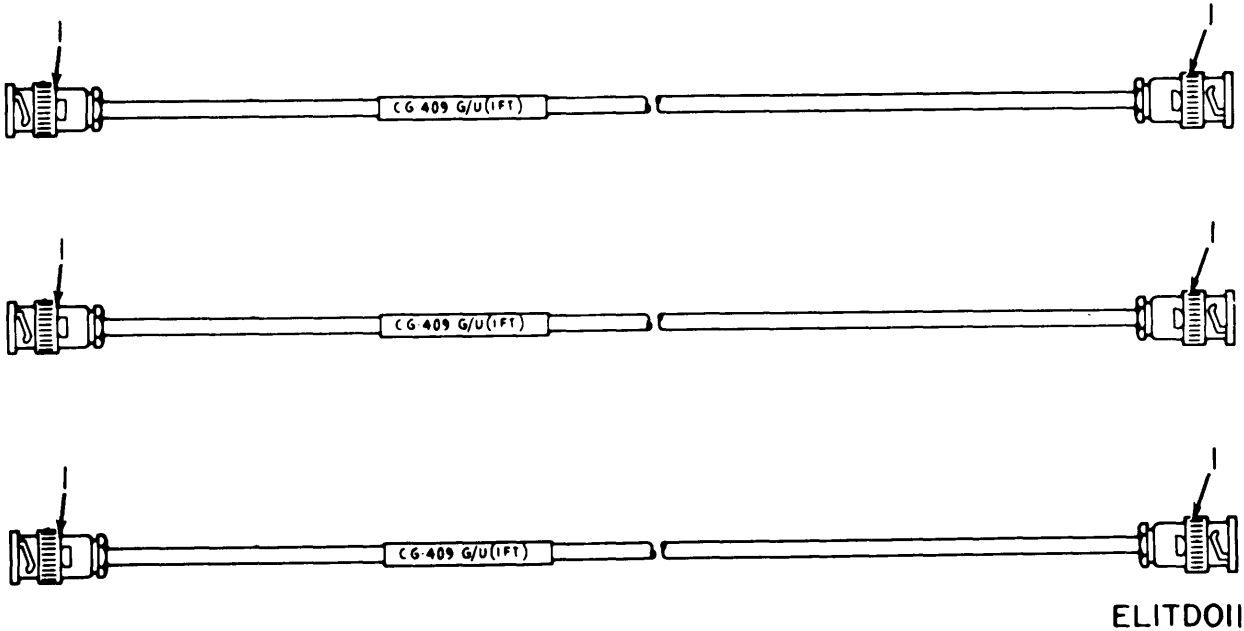
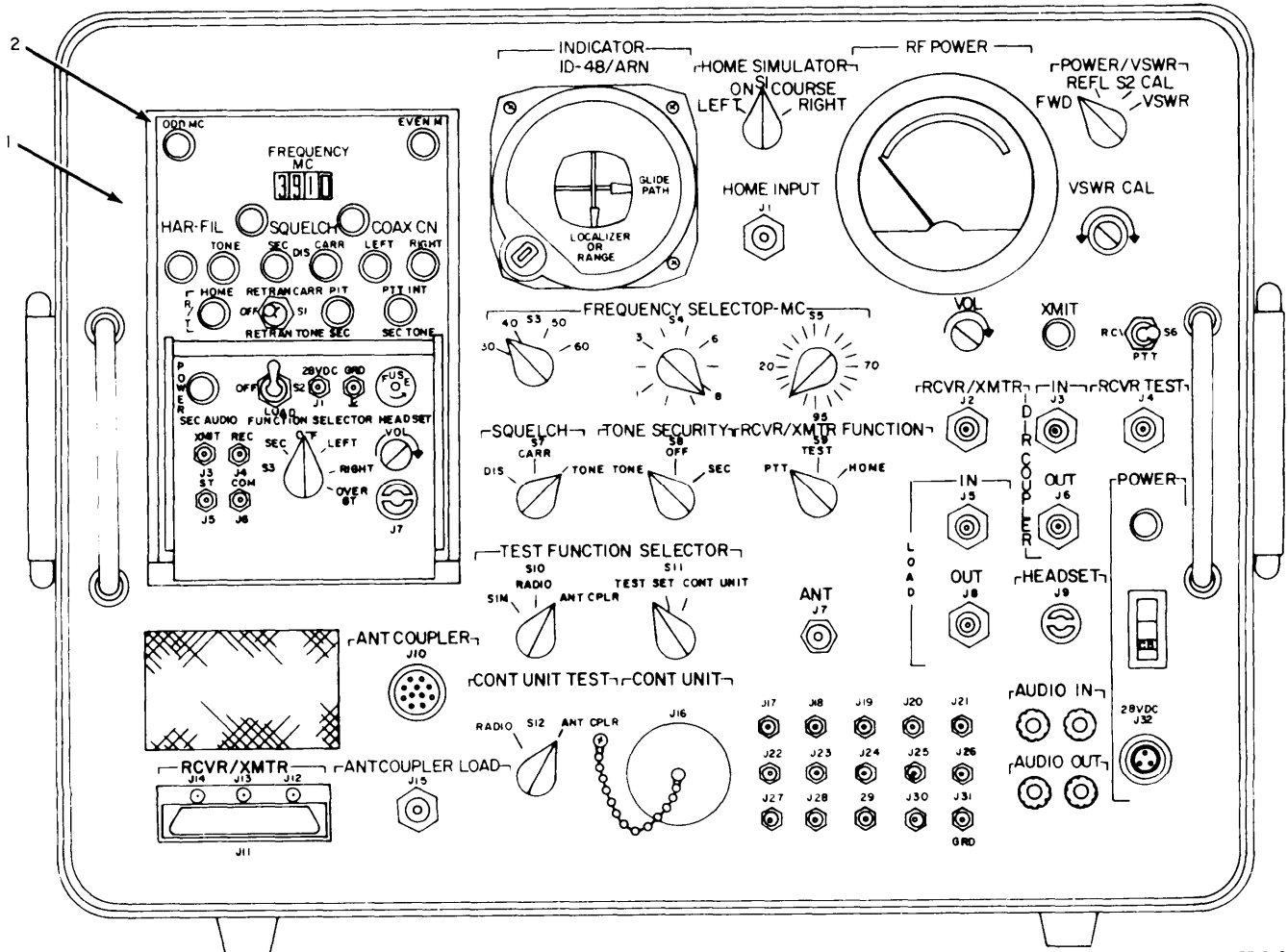

Figure 11. Cable Assembly CG-409G/U (1-F).

SECTION II

TM11-6625-601-34P

(1) ILLUSTRATION (A) FIG NO	(B) ITEM NO	(2) SMR CODE	(3) NATIONAL STOCK NUMBER	(4) PART NUMBER	(5) FSCM	(6) DESCRIPTION	USABLE ON CODE	(7) U/M	(8) QTY INC IN UNIT
11	1	PAFZZ	5935-00-823-0487	UG88E/U	80058	GROUP 10 CABLE ASSEMBLY CG-409G/U (1-F) CONNECTOR, PLUG, ELECTRICAL		EA	6



EL T0012

Figure 12. Test Set, Radio TS-1967/ARC-54.

SECTION II

TM11-6625-601-34P

(1) ILLUSTRATION (A) FIG NO	(B) ITEM NO	(2) SMR CODE	(3) NATIONAL STOCK NUMBER	(4) PART NUMBER	(5) FSCM	(6) DESCRIPTION	(7) USABLE ON CODE	(8) QTY INC IN UNIT
						GROUP 11 TEST SET,RADIO TS-1967/ARC-54		
12	1	XDFFF		SMB-504958	80063	FRONT PANEL ASSEMBLY	EA	1
12	2	PDOFD	6625-00-906-1172	SM-349/ARC-54	80058	SIMULATOR,TEST SET SM-349/ARC-54	EA	1

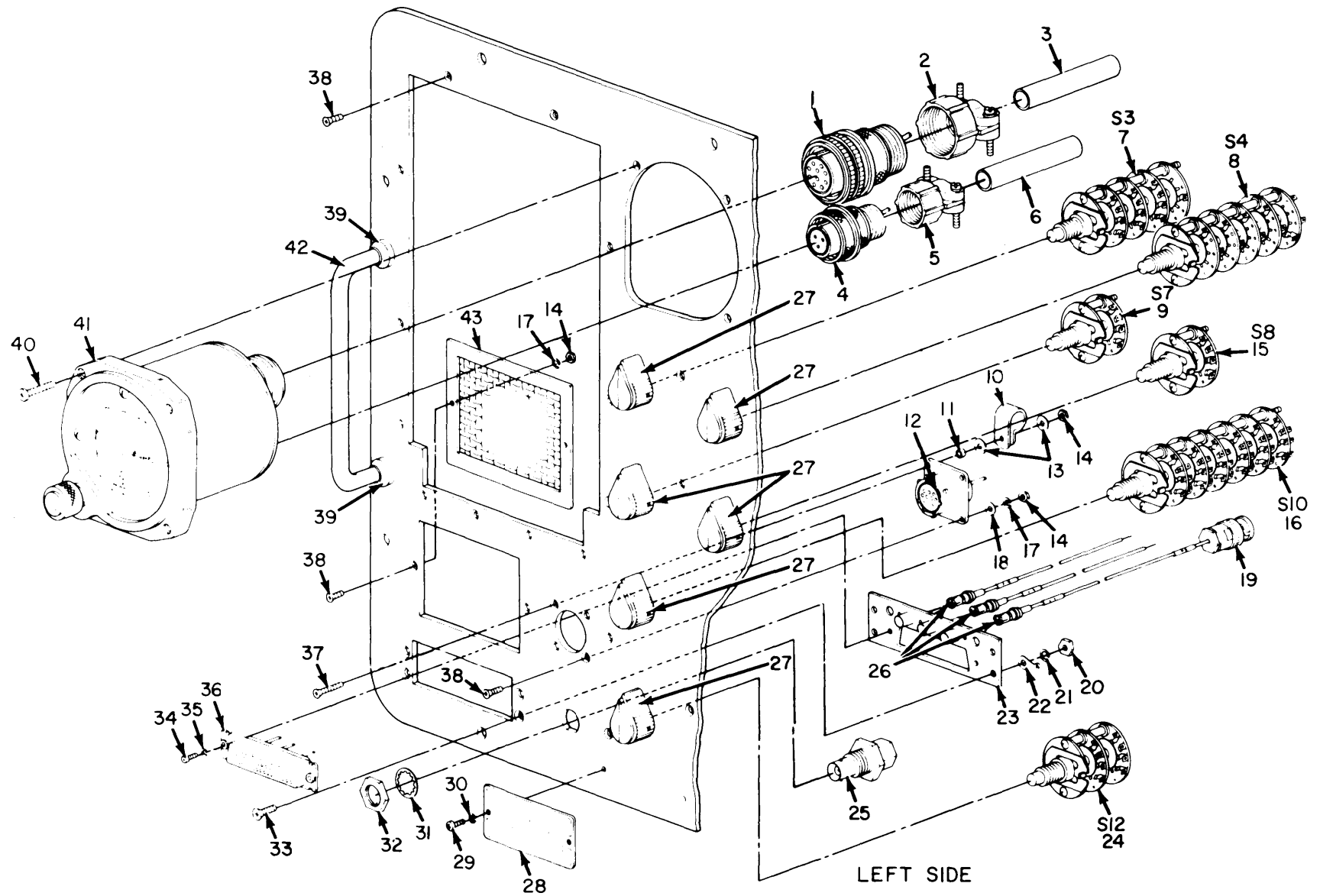

Figure 13. Front Panel Assembly (SMB-504958) (Sheet 1 of 2).

ELITD013

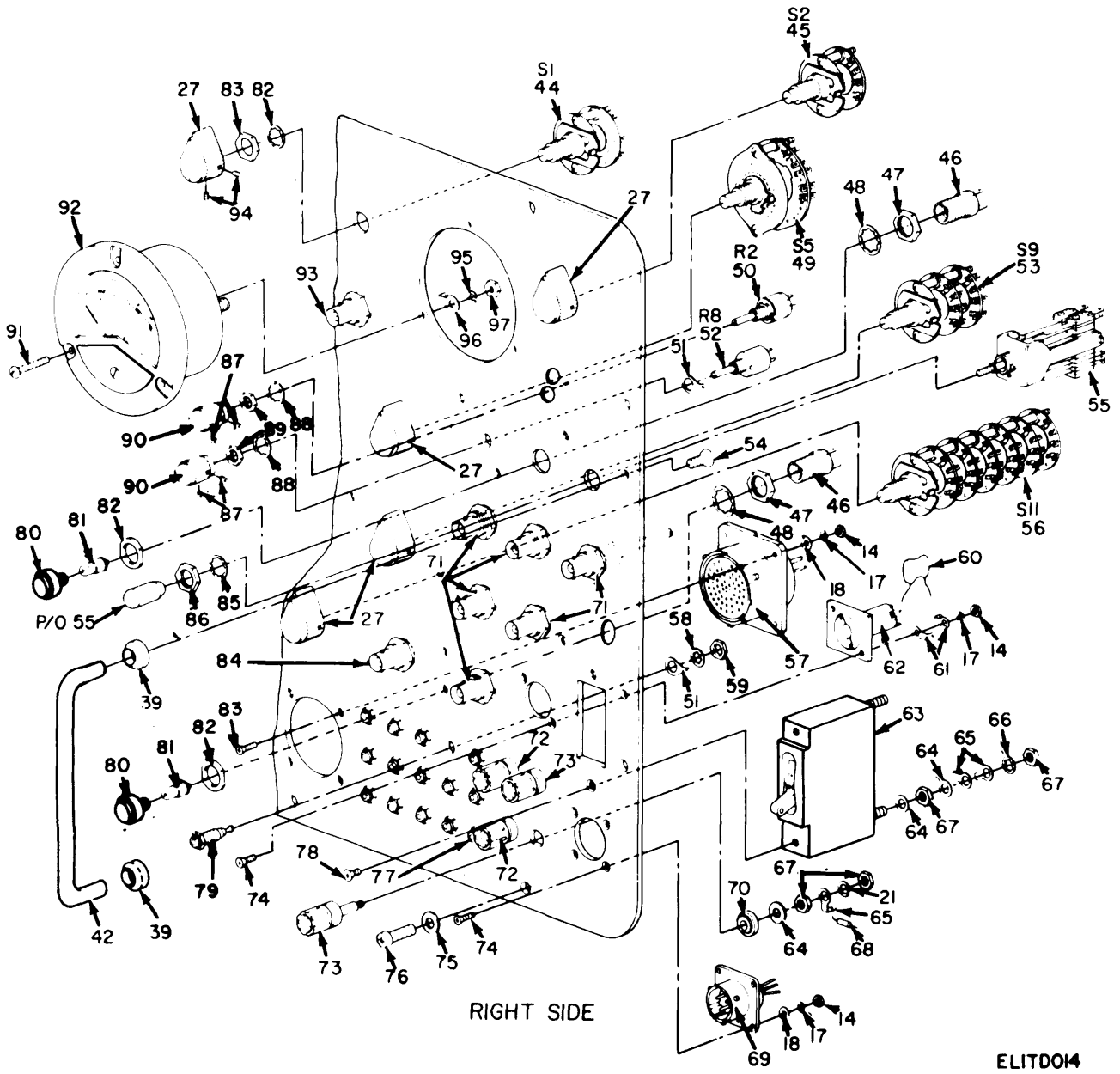

Figure 13. Front Panel Assembly (SMB-504958) (Sheet 2 of 2).

SECTION II

TM11-6625-601-34P

(1) ILLUSTRATION (A) FIG NO	(2) (B) ITEM NO	(3) SMR CODE	(4) NATIONAL STOCK NUMBER	(5) PART NUMBER	(6) FSCM	(7) DESCRIPTION USABLE ON CODE	(8) QTY INC IN UNIT
						GROUP 1101 FRONT PANEL ASSEMBLY (SMB-504958)	
13	1	PAFZZ	5935-00-721-0491	MS3106A18-1S	96906	CONNECTOR, PLUG, ELECTRICAL	EA 1
13	2	PAFZZ	5935-00-809-0786	MS3057-10A	96906	CLAMP, CABLE, ELECTRICAL CONNECTOR	EA 1
13	3	PAFZZ	5935-00-936-7376	MS3420-10	96906	BUSHING, RUBBER	EA 1
13	4	XDFZZ		MS3106A14S-7S	96906	CONNECTOR, PLUG, ELECTRICAL	EA 1
13	5	PAFZZ	5935-00-280-2195	MS3057-6A	96906	CLAMP, CABLE, ELECTRICAL CONNECTOR	EA 1
13	6	PAFZZ	5365-00-820-4535	MS3420-6	96906	BUSHING, RUBBER	EA 1
13	7	PAFZZ	5930-00-943-1444	259-2343-010	13499	SWITCH, ROTARY	EA 1
13	8	PAFZZ	5930-00-944-2425	259-2343-020	13499	SWITCH, ROTARY	EA 1
13	9	PAFZZ	5930-00-944-2417	259-2344-070	13499	SWITCH, ROTARY	EA 1
13	10	PAFZZ	5340-00-964-2557	SMC-508365-4	80063	CLAMP, LOOP	EA 1
13	11	XDFZZ		SMC-504221-6	80063	SPACER, SLEEVE	EA 1
13	12	XDFZZ		SMD-504850	80063	CONNECTOR, RECEPTACLE, ELECTRICAL	EA 1
13	13	PAFZZ	5310-00-722-5998	MS15795-805	96906	WASHER, FLAT	EA 2
13	14	PAFZZ	5310-00-225-3072	SMB-438860	80063	NUT, PLAIN, HEXAGON	EA 16
13	15	PAFZZ	5930-00-944-2419	244223F1	76854	SWITCH, ROTARY	EA 1
13	16	XDFZZ		259-2344-020	13499	SWITCH, ROTARY	EA 1
13	17	PAFZZ	5310-00-933-8118	MS35338-135	96906	WASHER, LOCK	EA 16
13	18	PAFZZ	5310-00-136-1631	SMB-504908	80063	WASHER, FLAT	EA 11
13	19	PAFZZ	5935-00-943-6898	13564	91737	CONNECTOR, RECEPTACLE, ELECTRICAL	EA 1
13	20	PAFZZ	5310-00-934-9761	MS35649-264	96906	NUT, PLAIN, HEXAGON	EA 4
13	21	PAFZZ	5310-00-933-8120	MS35338-138	96906	WASHER, LOCK	EA 8
13	22	XDFZZ		SMC-504133-2	80063	TERMINAL, LUG	EA 2
13	23	XDFZZ		SMD-504307	80063	PLATE, RETAINING, ELECTRICAL CONNECTOR	EA 1
13	24	XDFZZ		SMD-504846-5	80063	SWITCH, ROTARY	EA 1
13	25	XDFZZ		SMC-504946	80063	COUPLER, ANTENNA	EA 1
13	26	PAFZZ	5940-00-812-2903	YE-1620	09922	PLUG, TIP	EA 3
13	27	PAOZZ	5355-00-616-9604	MS91528-1P2B	96906	KNOB	EA 11
13	28	XDFZZ		SMD-504913-2	80063	PLATE, IDENTIFICATION	EA 1
13	29	PAFZZ	5305-00-054-5644	MS51957-11	96906	SCREW, MACHINE	EA 2
13	30	XDFZZ		AN936B4B	88044	WASHER, LOCK	EA 2
13	31	XDFZZ		RAYC505015-1	30972	WASHER, LOCK	EA 9
13	32	PAFZZ	5310-00-814-4534	MS35125-3	96906	NUT, PLAIN, HEXAGON	EA 9
13	33	PAFZZ	5305-00-727-8832	MS51959-29	96906	SCREW, MACHINE	EA 4
13	34	PAFZZ	5305-00-054-5637	MS51957-3	96906	SCREW, MACHINE	EA 2
13	35	PAFZZ	5310-00-928-2690	MS35338-134	96906	WASHER, LOCK	EA 2
13	36	PAFZZ	5935-00-583-5956	371-0182-000	13499	CONNECTOR, RECEPTACLE, ELECTRICAL	EA 1
13	37	PAFZZ	5305-00-763-7827	MS51959-18	96906	SCREW, MACHINE	EA 1
13	38	PAFZZ	5305-00-770-2579	MS51959-15	96906	SCREW, MACHINE	EA 19
13	39	XDFZZ		900-14	15849	FERRULE, BOW HANDLE	EA 4

SECTION II

TM11-6625-601-34P

(1) ILLUSTRATION (A) FIG NO	(2) (B) ITEM NO	(3) SMR CODE	(4) NATIONAL STOCK NUMBER	(5) PART NUMBER	(6) FSCM	(7) DESCRIPTION	(8) USABLE ON CODE	(9) QTY INC IN UNIT
13	40	PAFZZ	5305-00-054-6656	MS51957-32	96906	SCREW, MACHINE	EA	3
13	41	PDODD	6610-00-839-8638	ID-48/ARN	80058	INDICATOR, COURSE ID-48/ARN	EA	1
13	42	XDFZZ		SMC-504906	80063	HANDLE, BOW	EA	2
13	43	XDFZZ		SMC-504905	80063	SCREEN, VENTILATION, METAL	EA	1
13	44	PAFZZ	5930-00-944-2414	259-2344-040	76854	SWITCH, ROTARY	EA	1
13	45	XDFZZ		244213F1	76854	SWITCH, ROTARY	EA	1
13	46	XDFZZ		91080M	87034	LAMPHOLDER	EA	2
13	47	XDFZZ		RAYD508431-3	30972	NUT, PLAIN, HEXAGON	EA	2
13	48	XDFZZ		RAYD508431-5	30972	WASHER, LOCK	EA	2
13	49	XDFZZ		SMD-508443	80063	SWITCH, ROTARY	EA	1
13	50	XDFZZ		RV6NAYS1103B	81349	RESISTOR, VARIABLE	EA	1
13	51	PAFZZ	5940-00-665-5592	4012	77147	TERMINAL, LUG	EA	6
13	52	XDFZZ		SMC-504033	80063	RESISTOR, VARIABLE	EA	1
13	53	PAFZZ	5930-00-944-2415	259-2344-010	13499	SWITCH, ROTARY	EA	1
13	54	PAFZZ	5305-00-071-1321	MS51960-64	96906	SCREW, MACHINE	EA	4
13	55	PAFZZ	5930-00-944-4578	1E7052-89	01548	SWITCH, LEVER WITH KNOB	EA	1
13	56	PAFZZ	5930-00-944-2416	SMD-504846-6	80063	SWITCH, ROTARY	EA	1
13	57	PAFZZ	5935-00-173-1214	SMD-504854	80063	CONNECTOR, RECEPTACLE, ELECTRICAL	EA	1
13	58	XDFZZ		RAYMS16108-1-2	30972	WASHER, LOCK	EA	15
13	59	PAFZZ	5310-00-245-7801	RAYMS16108-1-1	30972	NUT, PLAIN, HEXAGON	EA	15
13	60	PAFZZ	5910-00-412-2000	CM06FD222J03	81349	CAPACITOR, FIXED, MICA	EA	1
13	61	PAFZZ	5940-00-644-8722	4007-4	77147	TERMINAL, LUG	EA	2
13	62	PAFZZ	5935-00-578-9622	119392	78947	JACK, TELEPHONE	EA	1
13	63	PAFZZ	5925-00-763-4104	SMD-504886	80063	CIRCUIT BREAKER	EA	1
13	64	PAFZZ	5310-00-221-0230	SMB-504789	80063	WASHER, FLAT	EA	8
13	65	XDFZZ		SMB-504539	80063	TERMINAL, LUG	EA	7
13	66	PAFZZ	5310-00-543-5933	MS35333-73	96906	WASHER, LOCK	EA	2
13	67	PAFZZ	5310-00-934-9764	MS35649-205	96906	NUT, PLAIN, HEXAGON	EA	12
13	68	PAFZZ	5905-00-279-1756	RC20GF151K	81349	RESISTOR, FIXED, COMPOSITION	EA	1
13	69	PAFZZ	5935-00-995-5782	MS3112E12-3P	96906	CONNECTOR, RECEPTACLE, ELECTRICAL	EA	1
13	70	PAFZZ	5970-00-173-2376	RAYC508361-1	30972	INSULATOR, BUSHING, PLASTIC	EA	4
13	71	PAFZZ	5935-00-850-8876	357-9248-00	13499	CONNECTOR, RECEPTACLE, ELECTRICAL	EA	6
13	72	PAFZZ	5940-00-817-4880	SMC-508361-2	80063	POST, BINDING, RED	EA	2
13	73	XDFZZ		SMC-508361-1	80063	POST, BINDING, BLACK	EA	2
13	74	PAFZZ	5305-00-770-2580	MS51959-16	96906	SCREW, MACHINE	EA	6
13	75	PAFZZ	5310-00-850-1611	MS15795-808	96906	WASHER, FLAT	EA	10
13	76	PAFZZ	5305-00-059-3660	MS51958-64	96906	SCREW, MACHINE	EA	10
13	77	PAFZZ	5935-00-762-0312	M39024-10-03	81349	JACK, TIP, BLACK	EA	1
13	78	PAFZZ	5305-00-763-6961	MS51959-26	96906	SCREW, MACHINE	EA	2
13	79	PAFZZ	5935-00-728-4514	M39024-10-01	81349	JACK, TIP, WHITE	EA	14

SECTION II

TM11-6625-601-34P

(1) ILLUSTRATION (A) FIG NO	(B) ITEM NO	(2) SMR CODE	(3) NATIONAL STOCK NUMBER	(4) PART NUMBER	(5) FSCM	(6) DESCRIPTION	(7) USABLE ON CODE	(8) QTY INC IN UNIT
13	80	XDOZZ		91050M56	87034	LENS, INDICATOR LIGHT, RED	EA	2
13	81	PAOZZ	6240-00-155-7836	MS25237-327	96906	LAMP, INCANDESCENT	EA	2
13	82	XDFZZ		RAYD508431-4	30972	NUT, PLAIN, ROUND	EA	2
13	83	PAFZZ	5305-00-763-7822	MS51959-14	96906	SCREW, MACHINE	EA	4
13	84	PAFZZ	5935-00-836-6522	M39012-19-0002	81349	CONNECTOR, RECEPTACLE, ELECTRICAL	EA	1
13	85	PAFZZ	5310-00-595-7237	AN936A616	88044	WASHER, LOCK	EA	12
13	86	XDFZZ		MS25082-7	96906	NUT, PLAIN, HEXAGON	EA	12
13	87	PAFZZ	5305-00-717-6950	RAYMS91528-0D181	30972	SETSCREW	EA	4
13	88	PAFZZ	5310-00-543-2740	MS35333-74	96906	WASHER, LOCK	EA	2
13	89	PAFZZ	5310-00-240-6445	SMB-504565	80063	NUT, PLAIN, HEXAGON	EA	2
13	90	PAOZZ	5355-00-813-2078	MS91528-0D18	96906	KNOB	EA	2
13	91	PAFZZ	5305-00-054-6657	MS51957-338	96906	SCREW, MACHINE	EA	3
13	92	PAFZZ	6625-00-913-5372	476-0431-00	13499	AMMETER, DIRECT CURRENT	EA	1
13	93	PAFZZ	5935-00-999-6464	80183800B-75	94375	CONNECTOR, RECEPTACLE, ELECTRICAL	EA	1
13	94	XDOZZ		RAYMS91528-1P2B1	30972	SETSCREW	EA	22
13	95	PAFZZ	5310-00-929-6395	MS35338-136	96906	WASHER, LOCK	EA	3
13	96	XDFZZ		SMC-508325-1	80063	TERMINAL, LUG	EA	1
13	97	PAFZZ	5310-00-934-9747	MS35649-262	96906	NUT, PLAIN, HEXAGON	EA	3

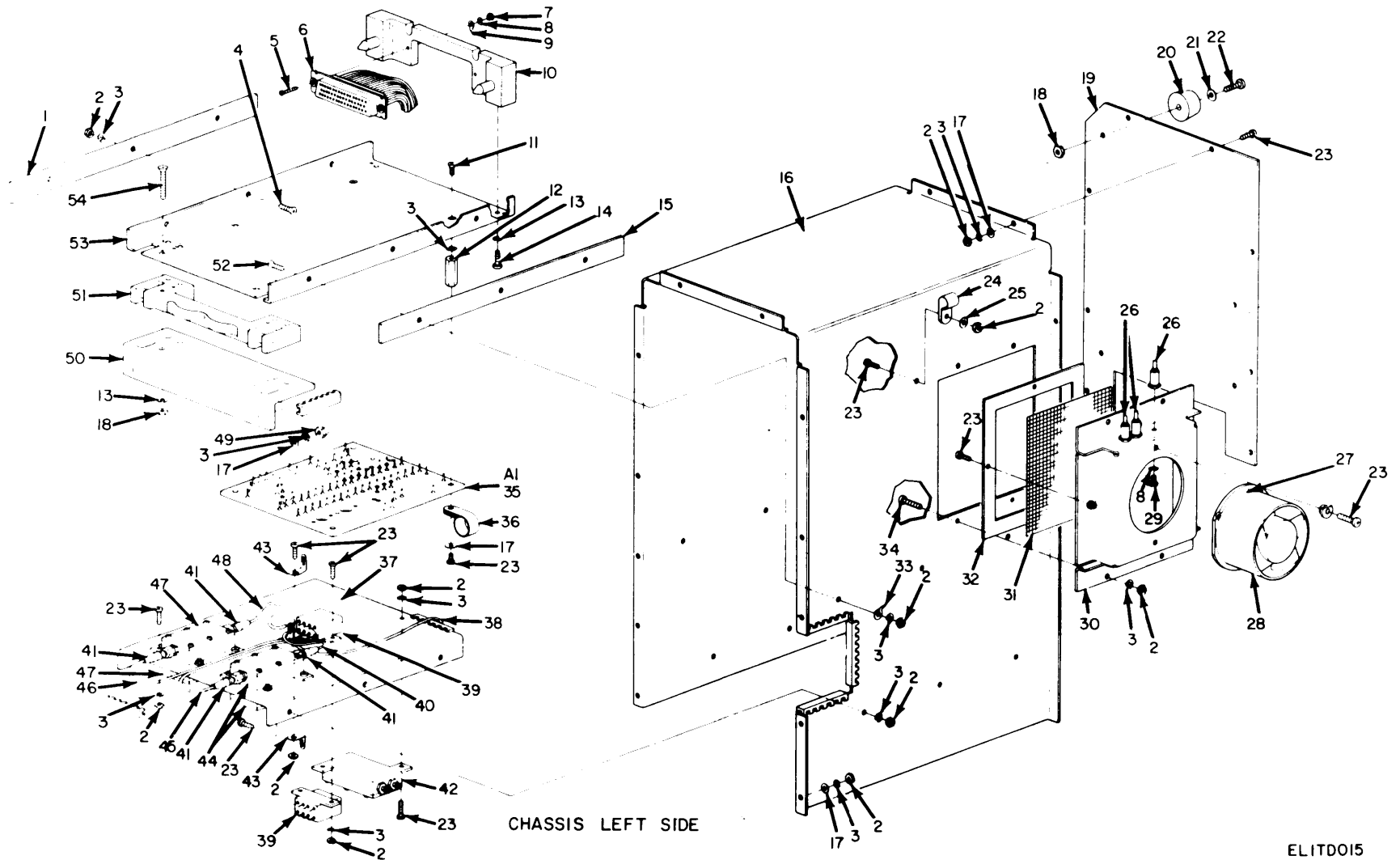

ELITD015

Figure 14. Front Panel Assembly (SMB-504958), Chassis (Sheet 1 of 2).

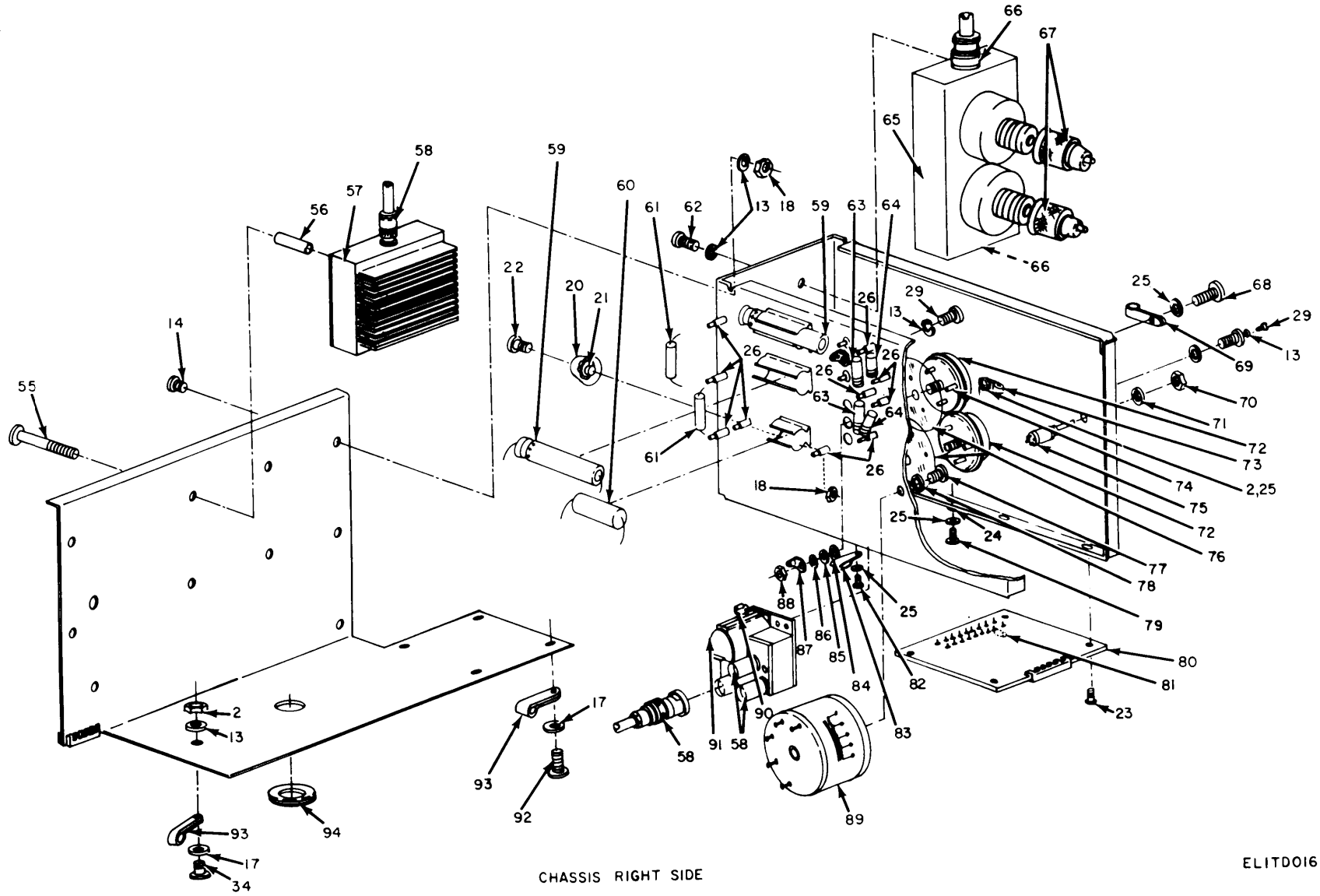

ELITD016

Figure 14. Front Panel Assembly (SMB-504958), Chassis (Sheet 2 of 2).

SECTION II

TM11-6625-601-34P

(1) ILLUSTRATION (A) FIG NO	(2) ITEM NO	(3) SMR CODE	(4) NATIONAL STOCK NUMBER	(5) PART NUMBER	(6) FSCM	(7) DESCRIPTION	(8) QTY INC IN UNIT
14	1	XDFZZ		SMC-504775-1	80063	SPACER, PLATE	EA 1
14	2	PAFZZ	5310-00-225-3072	SMB-438860	80063	NUT, PLAIN, HEXAGON	EA 81
14	3	PAFZZ	5310-00-933-8118	MS35338-135	96906	WASHER, LOCK	EA 72
14	4	PAFZZ	5305-00-770-2579	MS51959-15	96906	SCREW, MACHINE	EA 3
14	5	PAFZZ	5305-00-054-5643	MS51957-9	96906	SCREW, MACHINE	EA 2
14	6	PAFZZ	5935-00-583-5956	371-0182-000	13499	CONNECTOR, RECEPTACLE, ELECTRICAL	EA 1
14	7	PAFZZ	5310-00-934-9748	MS35649-244	96906	NUT, PLAIN, HEXAGON	EA 2
14	8	PAFZZ	5310-00-928-2690	MS35338-134	96906	WASHER, LOCK	EA 5
14	9	PAFZZ	5940-00-836-3536	4040-2HTD	77147	TERMINAL, LUG	EA 2
14	10	XDFZZ		SMC-504773	80063	SPACER PLATE, GUIDE PINS	EA 1
14	11	PAFZZ	5305-00-770-2533	MS51959-13	96906	SCREW, MACHINE	EA 4
14	12	XDFZZ		SMC-508300-3	80063	SPACER, SLEEVE	EA 4
14	13	PAFZZ	5310-00-929-6395	MS35338-136	96906	WASHER, LOCK	EA 39
14	14	PAFZZ	5305-00-054-6651	MS51957-27	96906	SCREW, MACHINE	EA 7
14	15	XDFZZ		SMC-504775-2	80063	SPACER, PLATE	EA 1
14	16	XDFZZ		SME-504929	80063	HOUSING, ELECTRICAL EQUIPMENT	EA 1
14	17	PAFZZ	5310-00-136-1631	SMB-504908	80063	WASHER, FLAT	EA 38
14	18	PAFZZ	5310-00-934-9761	MS35649-264	96906	NUT, PLAIN, HEXAGON	EA 18
14	19	XDFZZ		SMD-504749	80063	PANEL, BLANK	EA 1
14	20	PAFZZ	5340-00-264-7182	747-R	75543	BUMPER, RUBBER	EA 3
14	21	PAFZZ	5310-00-722-5998	MS15795-805	96906	WASHER, FLAT	EA 3
14	22	PAFZZ	5305-00-054-6653	MS51957-29	96906	SCREW, MACHINE	EA 3
14	23	PAFZZ	5305-00-054-5648	MS51957-14	96906	SCREW, MACHINE	EA 48
14	24	XDFZZ		SMD-504037-2	80063	CLAMP, LOOP	EA 3
14	25	PAFZZ	5310-00-782-1349	MS15795-804	96906	WASHER, FLAT	EA 5
14	26	PAFZZ	5940-00-259-8457	RTMT12M	91663	INSULATOR, STANDOFF	EA 13
14	27	XDFZZ		015-729-6763	13499	CLAMP, RIM CLENCHING	EA 2
14	28	PAFZZ	4140-00-226-4258	A047101	82877	FAN, VANEAXIAL	EA 1
14	29	PAFZZ	5305-00-054-5646	MS51957-12	96906	SCREW, MACHINE	EA 17
14	30	XDFZZ		SMD-504757	80063	HOUSING	EA 1
14	31	PAFZZ	4130-00-900-9399	009-0102-00	12064	FILTER, AIR, ELECTROSTATIC	EA 1
14	32	XDFZZ		SMC-504759	80063	FRAME, AIR, IN-OUT OUTLET	EA 1
14	33	PAFZZ	5940-00-644-8722	4007-4	77147	TERMINAL, LUG	EA 1
14	34	PAFZZ	5305-00-054-5649	MS51957-15	96906	SCREW, MACHINE	EA 5
14	35	XDFHH		SMD-504930	80063	AMPLIFIER, AUDIO FREQUENCY	EA 1
14	36	PAFZZ	5340-00-964-2557	SMC-508365-4	80063	CLAMP, LOOP	EA 2
14	37	XDFZZ		SMD-504743	80063	CHASSIS, ELECTRICAL EQUIPMENT	EA 1
14	38	XDFZZ		SMC-504969	80063	CABLE ASSEMBLY, RADIO FREQUENCY, NUMBER 15	EA 1
14	39	XDFZZ		RG9896G94	71482	RELAY, ARMATURE	EA 2
14	40	XDFZZ		SMC-504971	80063	CABLE ASSEMBLY, RADIO FREQUENCY, NUMBER 17	EA 1

SECTION II

TM11-6625-601-34P

(1) ILLUSTRATION (A) FIG NO	(2) (B) ITEM NO	(3) SMR CODE	(4) NATIONAL STOCK NUMBER	(5) PART NUMBER	(6) FSCM	(6) DESCRIPTION	(7) USABLE ON CODE	(8) QTY INC IN UNIT
14	41	XDFZZ		52-150 WHITE	98278	CONNECTOR, PLUG, ELECTRICAL	EA	4
14	42	XDFZZ		379-0513-040	13499	ATTENUATOR, FIXED	EA	1
14	43	PAFZZ	5940-00-682-2477	900100	88044	TERMINAL, LUG	EA	4
14	44	XDFZZ		375-0513-020	13499	ATTENUATOR, FIXED	EA	2
14	45	XDFZZ		SMC-504974	80063	CABLE ASSEMBLY, RADIO FREQUENCY, NUMBER 20	EA	1
14	46	XDFZZ		SMC-504975	80063	CABLE ASSEMBLY, RADIO FREQUENCY, NUMBER 21	EA	1
14	47	XDFZZ		379-0513-030	13499	ATTENUATOR, FIXED	EA	2
14	48	XDFZZ		SMC-504972	80063	CABLE ASSEMBLY, RADIO FREQUENCY, NUMBER 18	EA	1
14	49	XDFZZ		SMC-504997	80063	NUT, PLAIN, HEXAGON	EA	4
14	50	XDFZZ		SMD-504755	80063	BRACKET, ANGLE	EA	1
14	51	XDFZZ		SMC-504710	80063	SPACER PLATE, ROLLER BEARING	EA	1
14	52	PAFZZ	5305-00-770-2580	MS51959-16	96906	SCREW, MACHINE	EA	3
14	53	XDFZZ		SMD-504751	80063	BRACKET, DOUBLE ANGLE	EA	1
14	54	PAFZZ	5305-00-764-0064	MS51959-32	96906	SCREW, MACHINE	EA	6
14	55	PAFZZ	5305-00-054-6660	MS51957-36	96906	SCREW, MACHINE	EA	4
14	56	XDFZZ		SMB-504907	80063	SPACER, SLEEVE	EA	4
14	57	PAFZZ	5985-00-900-9959	351-7003-010	13499	DUMMY LOAD, ELECTRICAL	EA	1
14	58	PAFZZ	5935-00-823-0487	UG88E/U	80058	CONNECTOR, PLUG, ELECTRICAL UG88E/U	EA	4
14	59	PAFZZ	5910-00-079-9474	CE13C221G	81349	CAPACITOR, FIXED, ELECTROLYTIC	EA	2
14	60	PAFZZ	5910-00-822-0016	9188272	50000	CAPACITOR, FIXED, PAPER	EA	1
14	61	PAFZZ	5905-00-081-7348	RW67V1R0	81349	RESISTOR, FIXED, WIRE WOUND	EA	2
14	62	PAFZZ	5305-00-054-6652	MS51957-28	96906	SCREW, MACHINE	EA	4
14	63	PAFZZ	5905-00-195-6814	RC42GF102K	81349	RESISTOR, FIXED, COMPOSITION	EA	2
14	64	PAFZZ	5905-00-279-3833	RC20GF100K	81349	RESISTOR, FIXED, COMPOSITION	EA	2
14	65	XDFZZ		SMD-504925	80063	COUPLER, DIRECTIONAL	EA	1
14	66	PAFZZ	5935-00-815-6636	5424	91737	CONNECTOR, PLUG, ELECTRICAL	EA	2
14	67	XDFZZ		1390	36619	CONNECTOR, PLUG, ELECTRICAL	EA	2
14	68	PAFZZ	5305-00-054-5642	MS51957-8	96906	SCREW, MACHINE	EA	1
14	69	XDFZZ		SMC-508365-2	80063	CLAMP, LOOP	EA	1
14	70	PAFZZ	5310-00-240-6445	SMB-504565	80063	NUT, PLAIN, HEXAGON	EA	1
14	71	PAFZZ	5310-00-543-2740	MS35333-74	96906	WASHER, LOCK	EA	1
14	72	XDFZZ		JAN2N174	81349	TRANSISTOR	EA	2
14	73	XDFZZ		SMD-504037-3	80063	CLAMP, LOOP	EA	1
14	74	XDFZZ		TW516-10	08286	INSULATOR, BUSHING	EA	2
14	75	PAFZZ	5905-00-549-8222	RV6LAYS253B	81349	RESISTOR, VARIABLE	EA	1
14	76	XDFZZ		352-9964-000	13499	INSULATOR, DISK	EA	2
14	77	PAFZZ	5305-00-059-3657	MS51958-61	96906	SCREW, MACHINE	EA	1
14	78	PAFZZ	5310-00-933-8120	MS35338-138	96906	WASHER, LOCK	EA	1
14	79	PAFZZ	5305-00-054-5650	MS51957-16	96906	SCREW, MACHINE	EA	2
14	80	PAFZZ	5940-00-350-7774	SMC-504865	80063	TERMINAL BOARD	EA	1

SECTION II

TM11-6625-601-34P

(1) ILLUSTRATION (A) FIG NO	(B) ITEM NO	(2) SMR CODE	(3) NATIONAL STOCK NUMBER	(4) PART NUMBER	(5) FSCM	(6) DESCRIPTION	(7) USABLE ON CODE	(8) QTY INC IN UNIT
14	81	PAFZZ	5905-00-195-6758	RC20GF273K	81349	RESISTOR, FIXED, COMPOSITION	EA	1
14	82	PAFZZ	5305-00-727-8832	MS51959-29	96906	SCREW, MACHINE	EA	2
14	83	XDFZZ		SMD-504037-1	80063	CLAMP, LOOP	EA	1
14	84	XDFZZ		352-994-800	13499	INSULATOR, WASHER	EA	2
14	85	PAFZZ	5310-00-205-9399	SMC-508320-3	80063	WASHER, FLAT	EA	2
14	86	PAFZZ	5310-00-209-1239	MS35335-60	96906	WASHER, LOCK	EA	2
14	87	XDFZZ		SMB-504539	80063	TERMINAL, LUG	EA	2
14	88	XDFZZ		SMB-504782	80063	NUT, PLAIN, HEXAGON	EA	2
14	89	PAFZZ	5950-00-901-8143	31-11317-1	12175	TRANSFORMER, POWER, FIXED, AUTOMATIC	EA	1
14	90	PAFZZ	5961-00-892-0734	JAN1N483B	81349	SEMICONDUCTOR DEVICE, DIODE	EA	1
14	91	PAFZZ	5985-00-901-1133	410-0244-000	13499	RELAY, ARMATURE	EA	1
14	92	PAFZZ	5305-00-054-5651	MS51957-17	96906	SCREW, MACHINE	EA	1
14	93	PAFZZ	5340-00-619-7754	HP3N	09922	CLAMP, LOOP	EA	2
14	94	PAFZZ	5325-00-276-6091	MS35489-19	96906	GROMMET, RUBBER	EA	1

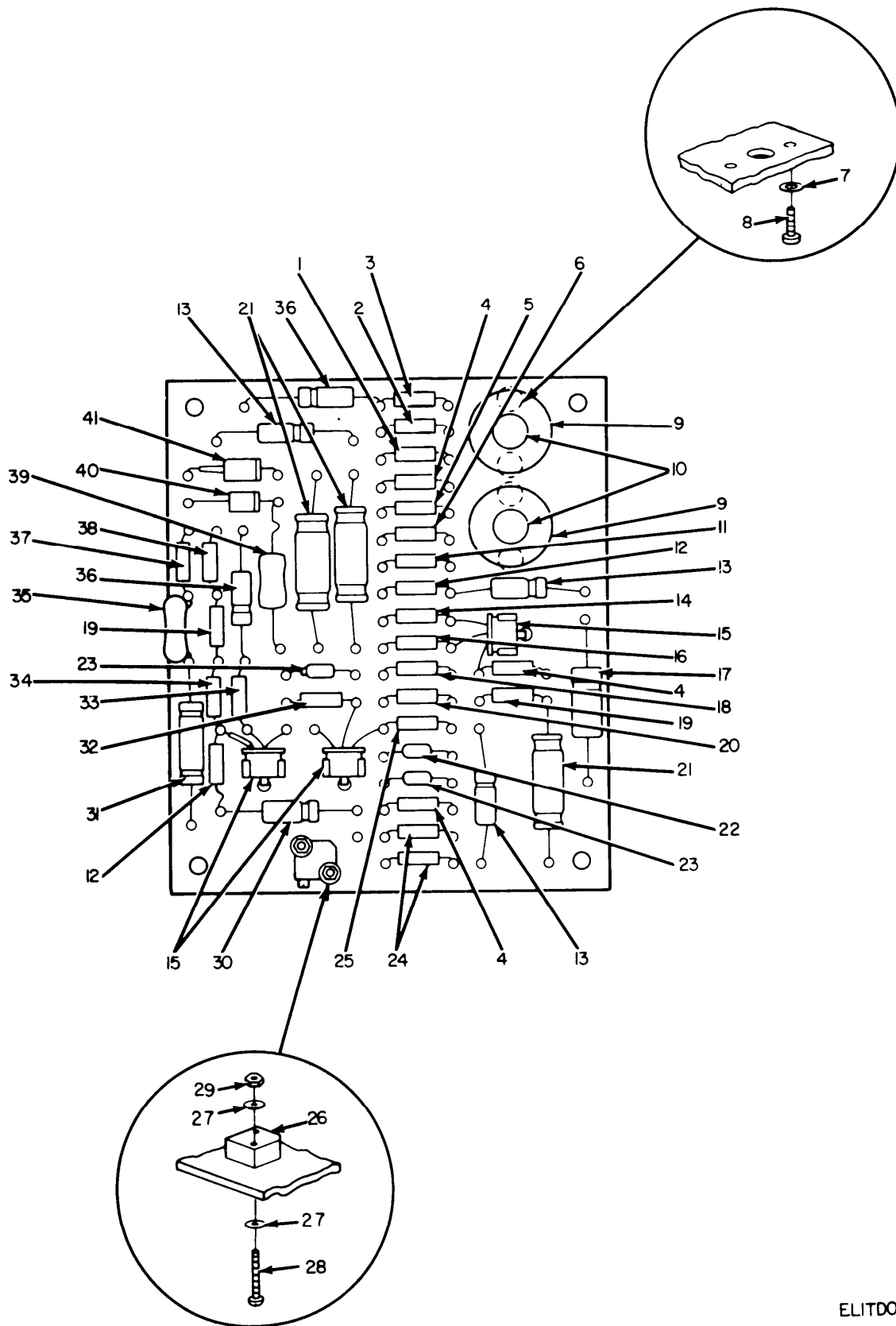

ELITDOI7

Figure 15. Audio Amplifier A1.

SECTION II

TM11-6625-601-34P

(1) ILLUSTRATION (A) FIG NO	(2) (B) ITEM NO	(3) SMR CODE	(4) NATIONAL STOCK NUMBER	(5) PART NUMBER	(6) FSCM	(7) DESCRIPTION	USABLE ON CODE	U/M	(8) QTY INC IN UNIT
						GROUP 110102 AUDIO AMPLIFIER A1			
15	1	PAHZZ	5905-00-279-1880	RC20GF272J	81349	RESISTOR, FIXED, COMPOSITION		EA	1
15	2	PAHZZ	5905-00-841-7461	RC20GF152J	81349	RESISTOR, FIXED, COMPOSITION		EA	1
15	3	PAHZZ	5905-00-279-3514	RC20GF181J	81349	RESISTOR, FIXED, COMPOSITION		EA	1
15	4	PAHZZ	5905-00-171-2006	RC20GF271J	81349	RESISTOR, FIXED, COMPOSITION		EA	3
15	5	PAHZZ	5905-00-195-6791	RC20GF681J	81349	RESISTOR, FIXED, COMPOSITION		EA	1
15	6	PAHZZ	5905-00-299-1541	RC20GF151J	81349	RESISTOR, FIXED, COMPOSITION		EA	1
15	7	PAHZZ	5310-00-231-9086	SMB-504441	80063	WASHER, FLAT		EA	4
15	8	PAHZZ	5305-00-054-5636	MS51957-2	96906	SCREW, MACHINE		EA	4
15	9	PAHZZ	5961-00-837-7262	2N697	81349	TRANSISTOR		EA	2
15	10	XDHZZ		SMD-504888	80063	HEATSINK, ELECTRICAL-ELECTRONIC COMPONENT		EA	2
15	11	PAHZZ	5905-00-279-3503	RC20GF682J	81349	RESISTOR, FIXED, COMPOSITION		EA	1
15	12	PAHZZ	5905-00-279-3499	RC20GF273J	81349	RESISTOR, FIXED, COMPOSITION		EA	2
15	13	XDHZZ		CL65BG100MP3	81349	CAPACITOR, FIXED, ELECTROLYTIC		EA	3
15	14	PAHZZ	5905-00-279-3505	RC20GF392J	81349	RESISTOR, FIXED, COMPOSITION		EA	1
15	15	PAHZZ	5961-00-829-0194	2N1308	81349	TRANSISTOR		EA	3
15	16	PAHZZ	5905-00-279-1878	RC20GF243J	81349	RESISTOR, FIXED, COMPOSITION		EA	1
15	17	XDHZZ		CL65BD181MP3	81349	CAPACITOR, FIXED, ELECTROLYTIC		EA	1
15	18	PAHZZ	5905-00-249-3656	RC20GF623J	81349	RESISTOR, FIXED, COMPOSITION		EA	1
15	19	PAHZZ	5905-00-279-1876	RC20GF222J	81349	RESISTOR, FIXED, COMPOSITION		EA	2
15	20	PAHZZ	5905-00-192-3981	RC20GF124J	81349	RESISTOR, FIXED, COMPOSITION		EA	1
15	21	PAHZZ	5910-00-841-8751	CL35BD250MP3	81349	CAPACITOR, FIXED, ELECTROLYTIC		EA	3
15	22	PAHZZ	5910-00-818-8720	150D562X90352	56289	CAPACITOR, FIXED, ELECTROLYTIC		EA	1
15	23	XDHZZ		SMD-504920-1	80063	CAPACITOR, FIXED, ELECTROLYTIC		EA	2
15	24	PAHZZ	5905-00-195-6453	RC20GF562J	81349	RESISTOR, FIXED, COMPOSITION		EA	2
15	25	PAHZZ	5905-00-185-8510	RC20GF103J	81349	RESISTOR, FIXED, COMPOSITION		EA	1
15	26	PAHZZ	5905-00-933-3999	381-9057-130	17826	RESISTOR, VARIABLE		EA	1
15	27	XDHZZ		SMB-504779	80063	WASHER, FLAT		EA	4
15	28	PAHZZ	5305-00-079-2556	SMB-504778	80063	SCREW, MACHINE		EA	2
15	29	PAHZZ	5310-00-231-8946	SMB-504784	80063	NUT, PLAIN, HEXAGON		EA	2
15	30	PAHZZ	5910-00-137-1127	CL65CC560MP3	81349	CAPACITOR, FIXED, ELECTROLYTIC		EA	1
15	31	PAHZZ	5910-00-851-5465	CL35BD060MP3	81349	CAPACITOR, FIXED, ELECTROLYTIC		EA	1
15	32	PAHZZ	5905-00-171-1998	RC20GF333J	81349	RESISTOR, FIXED, COMPOSITION		EA	1
15	33	PAHZZ	5905-00-171-2004	RC20GF223J	81349	RESISTOR, FIXED, COMPOSITION		EA	1
15	34	PAHZZ	5905-00-279-2522	RC20GF154J	81349	RESISTOR, FIXED, COMPOSITION		EA	1
15	35	PAHZZ	5910-00-412-2000	CM06FD222J03	81349	CAPACITOR, FIXED, MICA		EA	1
15	36	XDHZZ		CL65BG220MP3	81349	CAPACITOR, FIXED, ELECTROLYTIC		EA	2
15	37	PAHZZ	5905-00-192-3973	RC20GF471J	81349	RESISTOR, FIXED, COMPOSITION		EA	1
15	38	PAHZZ	5905-00-195-6800	RC20GF561J	81349	RESISTOR, FIXED, COMPOSITION		EA	1
15	39	PAHZZ	5905-00-080-5899	RW69V101	81349	RESISTOR, FIXED, WIRE WOUND		EA	1

SECTION II

TM11-6625-601-34P

(1) ILLUSTRATION (A) FIG NO	(B) ITEM NO	(2) SMR CODE	(3) NATIONAL STOCK NUMBER	(4) PART NUMBER	(5) FSCM	(6) DESCRIPTION	(7) USABLE ON CODE	(8) QTY INC IN UNIT
15	40	PAHZZ	5961-00-842-6181	JAN1N3018B	81349	SEMICONDUCTOR DEVICE,DIODE	EA	1
15	41	PAHZZ	5961-00-826-9048	JAN1N3020B	81349	SEMICONDUCTOR DEVICE,DIODE	EA	1

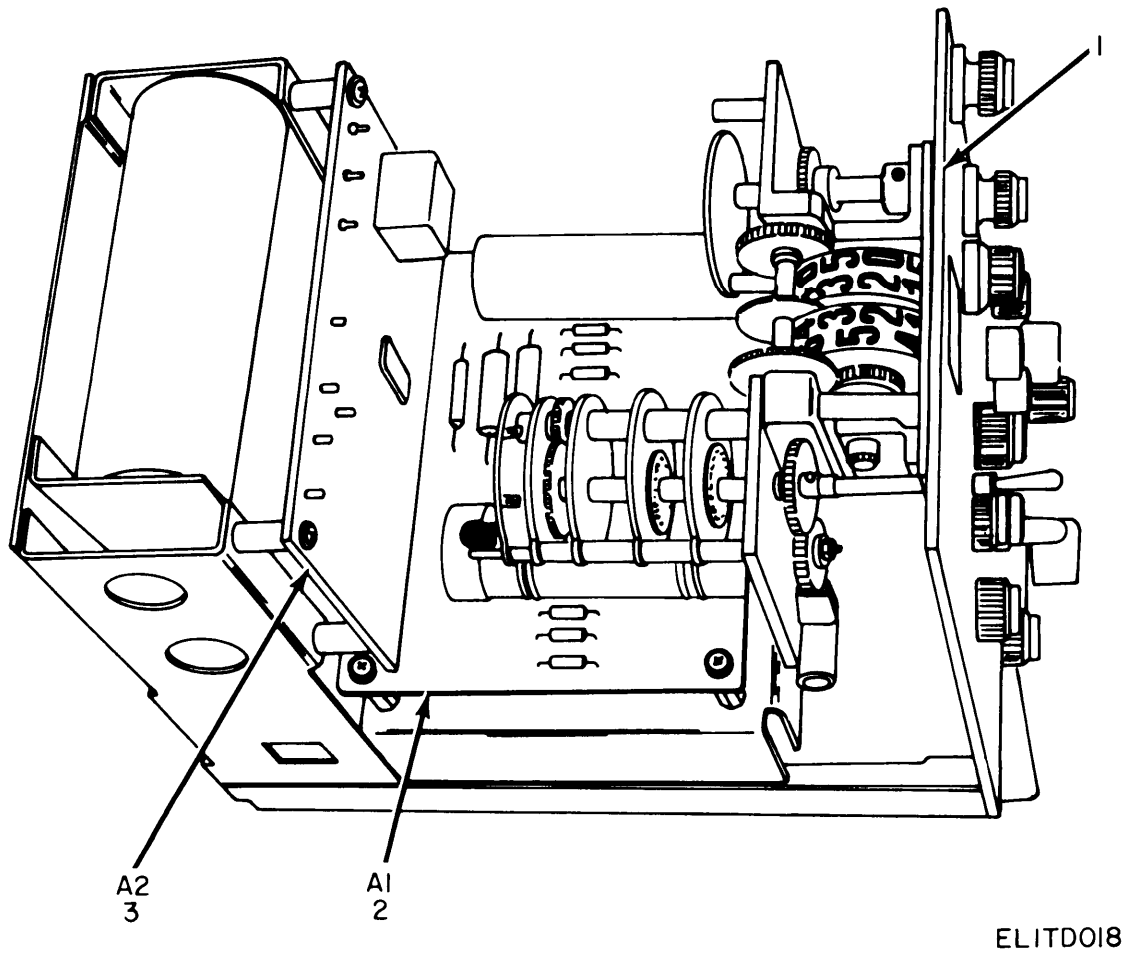

ELITDO18

Figure 16. Simulator, Test Set SM-349/ARC-54.

SECTION II

TM11-6625-601-34P

(1) ILLUSTRATION (A) FIG NO	(2) (B) ITEM NO	(3) SMR CODE	(4) NATIONAL STOCK NUMBER	(5) PART NUMBER	(6) DESCRIPTION	(7) USABLE ON CODE	(8) QTY INC IN UNIT
					GROUP 1102 SIMULATOR, TEST SET		
					SM-349/ARC-54		
16	1	XDFFF	SMB-504943	80063	FRONT PANEL ASSEMBLY	EA	1
16	2	XDFHH	SMD-504930	80063	AUDIO AMPLIFIER	EA	1
16	3	XDFHH	SMD-504926	80063	ELECTRONIC COMPONENT ASSEMBLY	EA	1

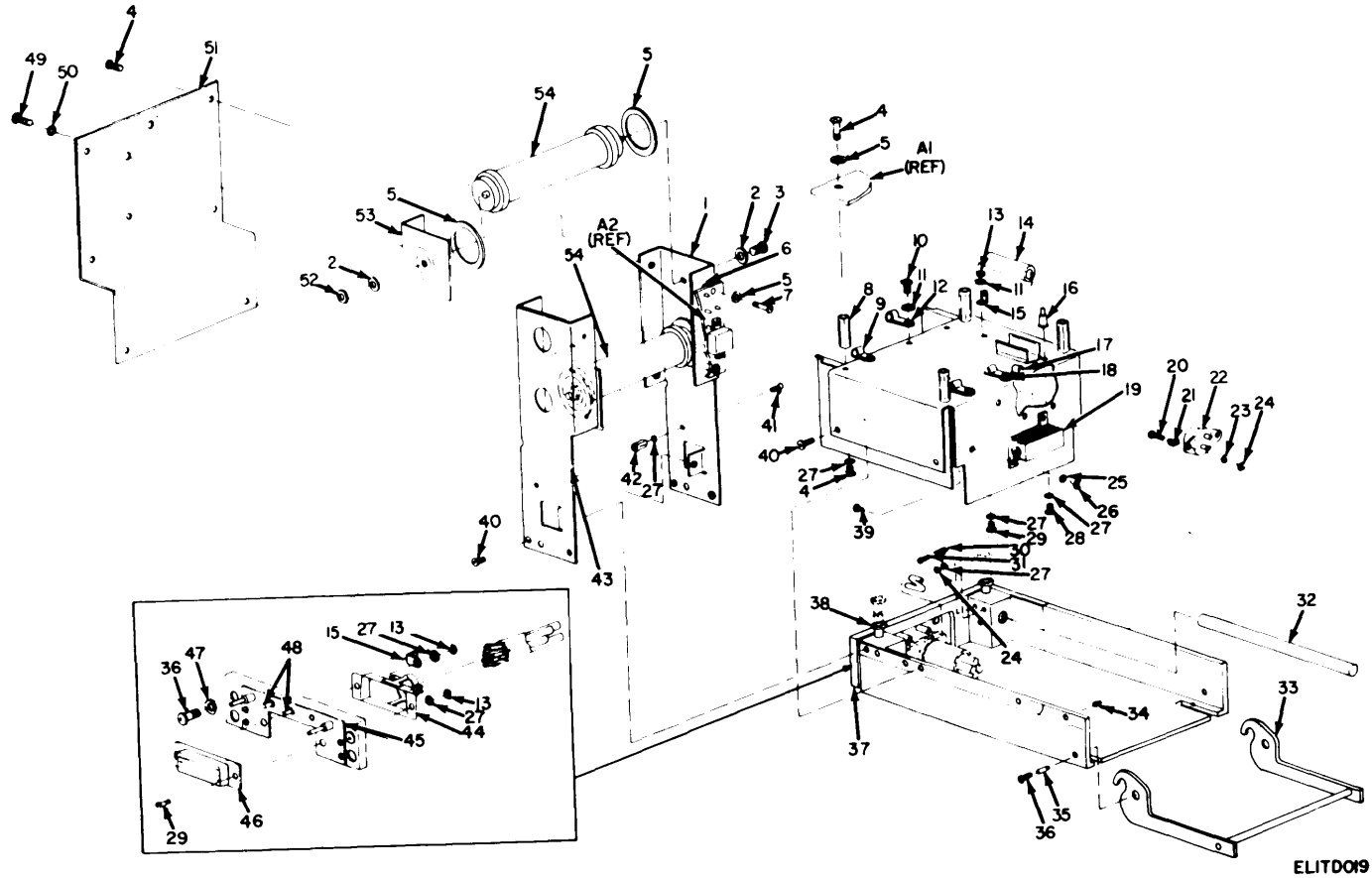

Figure 17. Simulator, Test Set SM-349/ARC-54, Chassis Assembly.

ELITD019

SECTION II

TM11-6625-601-34P

(1) ILLUSTRATION (A) FIG NO	(2) (B) ITEM NO	(3) SMR CODE	(4) NATIONAL STOCK NUMBER	(5) PART NUMBER	(6) FSCM	(7) DESCRIPTION	(8) USABLE ON CODE	(9) U/M	(10) (8) QTY INC IN UNIT
17	1	XDFZZ		SMD-504878	80063	BRACKET,DOUBLE ANGLE,RIGHT HAND		EA	1
17	2	PAFZZ	5310-00-531-9514	AN96006	80063	WASHER,FLAT		EA	4
17	3	PAFZZ	5305-00-419-0897	SMC-504797	80063	SCREW,MACHINE		EA	2
17	4	XDFZZ	5305-00-054-5648	MS51957-14	96906	SCREW,MACHINE		EA	14
17	5	XDFZZ		SMB-504781	80063	WASHER,FLAT,MICA		EA	4
17	6	XDFZZ		SMB-437306	80063	SPACER,SLEEVE		EA	4
17	7	PAFZZ	5305-00-054-5654	MS51957-20	96906	SCREW,MACHINE		EA	4
17	8	XDFZZ		SMC-508300-4	80063	SPACER,SLEEVE,HEXAGON		EA	4
17	9	XDFZZ		SMD-504037-1	80063	CLAMP,LOOP		EA	8
17	10	PAFZZ	5305-00-054-5649	MS51957-15	96906	SCREW,MACHINE		EA	2
17	11	PAFZZ	5310-00-782-1349	MS15795-804	96906	WASHER,FLAT		EA	6
17	12	XDFZZ		SMD-504037-2	80063	CLAMP,LOOP		EA	1
17	13	PAFZZ	5310-00-225-3072	SMB-438860	80063	NUT,PLAIN,HEXAGON		EA	3
17	14	PAFZZ	5910-00-847-6533	D29238	56289	CAPACITOR,FIXED,ELECTROLYTIC		EA	1
17	15	XDFZZ		SMC-504699	80063	TERMINAL,LUG		EA	2
17	16	PAFZZ	5940-00-259-8457	RTMT12M	91663	INSULATOR,STANDOFF		EA	1
17	17	XDFZZ		SMC-508365-2	80063	CLAMP,LOOP		EA	2
17	18	PAFZZ	5305-00-054-5653	MS51957-19	96906	SCREW,MACHINE		EA	2
17	19	PAFZZ	5905-00-843-6411	RE65G6R81	81349	RESISTOR,FIXED,WIRE WOUND		EA	1
17	20	PAFZZ	5305-00-054-6652	MS51957-28	96906	SCREW,MACHINE		EA	2
17	21	XDFZZ		SMC-504133-2	80063	TERMINAL,LUG		EA	1
17	22	PAFZZ	5961-00-752-5989	JAN1N2822B	81349	SEMICONDUCTOR DEVICE,DIODE		EA	1
17	23	PAFZZ	5310-00-929-6395	MS35338-136	96906	WASHER,LOCK		EA	2
17	24	PAFZZ	5310-00-934-9761	MS35649-64	96906	NUT,PLAIN,HEXAGON		EA	2
17	25	PAFZZ	5310-00-928-2690	MS35338-134	96906	WASHER,LOCK		EA	2
17	26	PAFZZ	5310-00-938-2013	MS35649-224	96906	NUT,PLAIN,HEXAGON		EA	2
17	27	PAFZZ	5310-00-933-8118	MS35338-135	96906	WASHER,LOCK		EA	16
17	28	PAFZZ	5305-00-054-5646	MS51957-12	96906	SCREW,MACHINE		EA	1
17	29	PAFZZ	5305-00-054-5647	MS51957-13	96906	SCREW,MACHINE		EA	3
17	30	XDFZZ		SMB-504791	80063	PLUNGER,DETENT,BALL		EA	2
17	31	PAFZZ	5305-00-770-2579	MS51959-15	96906	SCREW,MACHINE		EA	2
17	32	XDFZZ		SMC-504818	80063	POST,ELECTRICAL-MECHANICAL EQUIPMENT		EA	2
17	33	XDFZZ		SMD-504813	80063	LEVER,MANUAL CONTROL		EA	1
17	34	PAFZZ	5340-00-827-4024	MS21209C0420	96906	INSERT,SCREW THREAD		EA	6
17	35	XDFZZ		SMB-504810	80063	NUT,SLEEVE		EA	2
17	36	PAFZZ	5305-00-054-5651	MS51957-17	96906	SCREW,MACHINE		EA	2
17	37	XDFZZ		SMD-504746	80063	PLATE,RETAINING,ELECTRICAL-MECHANICAL		EA	1
17	38	XDFZZ		SMD-504870	80063	PIN,GROOVED,HEADED		EA	2
17	39	PAFZZ	5305-00-054-5638	MS51957-4	96906	SCREW,MACHINE		EA	2
17	40	PAFZZ	5305-00-763-7822	MS51959-14	96906	SCREW,MACHINE		EA	6

SECTION II

TM11-6625-601-34P

(1) ILLUSTRATION (A) FIG NO	(B) ITEM NO	(2) SMR CODE	(3) NATIONAL STOCK NUMBER	(4) PART NUMBER	(5) FSCM	(6) DESCRIPTION	(7) USABLE ON CODE	(8) QTY INC IN UNIT
17	41	PAFZZ	5305-00-770-2533	MS51959-13	96906	SCREW,MACHINE	EA	2
17	42	XDFZZ		SMC-508300-1	80063	SPACER,SLEEVE	EA	2
17	43	XDFZZ		SMD-504871	80063	BRACKET,DOUBLE ANGLE,LEFT HAND	EA	1
17	44	XDFZZ		SMC-504815	80063	ADAPTER,CABLE TO CONNECTOR	EA	1
17	45	XDFZZ		SMD-504799	80063	PLATE,RETAINING,ELECTRICAL CONNECTOR	EA	1
17	46	PAFZZ	5935-00-729-7306	019606-0041	71468	CONNECTOR,RECEPTACLE,ELECTRICAL	EA	1
17	47	XDFZZ		SMC-508331	80063	WASHER,LOCK	EA	2
17	48	PAFZZ	5935-00-910-5098	DM53740-5005	91146	CONNECTOR,PLUG,ELECTRICAL	EA	2
17	49	PAFZZ	5305-00-763-6955	MS51959-21	96906	SCREW,MACHINE	EA	2
17	50	PAFZZ	5310-00-136-1631	SMB-504908	80063	WASHER,FLAT	EA	2
17	51	XDFZZ		SMD-504729	80063	COVER,BACK	EA	1
17	52	PAFZZ	5310-00-934-9761	MS35649-264	96906	NUT,PLAIN,HEXAGON	EA	6
17	53	XDFZZ		SMC-504862	80063	BRACKET,ANGLE	EA	2
17	54	PAFZZ	5905-00-583-6150	RW36V100	81349	RESISTOR,FIXED,WIRE WOUND	EA	2

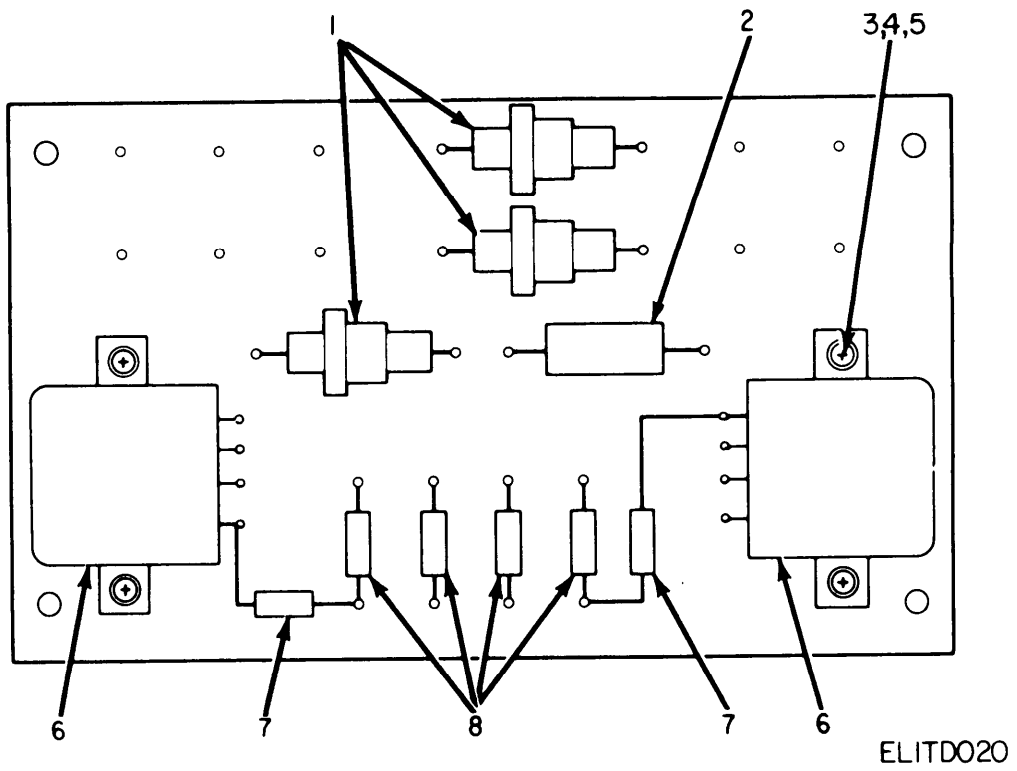

Figure 18. Electronic Component Assembly A2.

SECTION II

TM11-6625-601-34P

(1) ILLUSTRATION (A) FIG NO	(2) (B) ITEM NO	(3) SMR CODE	(4) NATIONAL STOCK NUMBER	(5) PART NUMBER	(6) DESCRIPTION	(7) USABLE ON CODE	(8) QTY INC IN UNIT
					GROUP 110201 ELECTRONIC COMPONENT		
					ASSEMBLY A2		
18	1	XDHZZ		1N600	81349 SEMICONDUCTOR DEVICE,DIODE	EA	3
18	2	PAHZZ	5905-00-615-6489	RN65B1213F	81349 RESISTOR, FIXED, FILM	EA	1
18	3	PAHZZ	5310-00-934-9761	MS35649-264	96906 NUT, PLAIN, HEXAGON	EA	4
18	4	PAHZZ	5310-00-136-1631	SMB-504908	80063 WASHER, FLAT	EA	4
18	5	PAHZZ	5305-00-054-5648	MS51957-14	96906 SCREW, MACHINE	EA	4
18	6	PAHZZ	5945-00-965-8786	974-0822-00	13499 RELAY, ARMATURE	EA	2
18	7	PAHZZ	5905-00-104-8343	RC32GF100K	81349 RESISTOR, FIXED, COMPOSITION	EA	2
18	8	PAHZZ	5961-00-892-0734	JAN1N483B	81349 SEMICONDUCTOR DEVICE, DIODE	EA	4

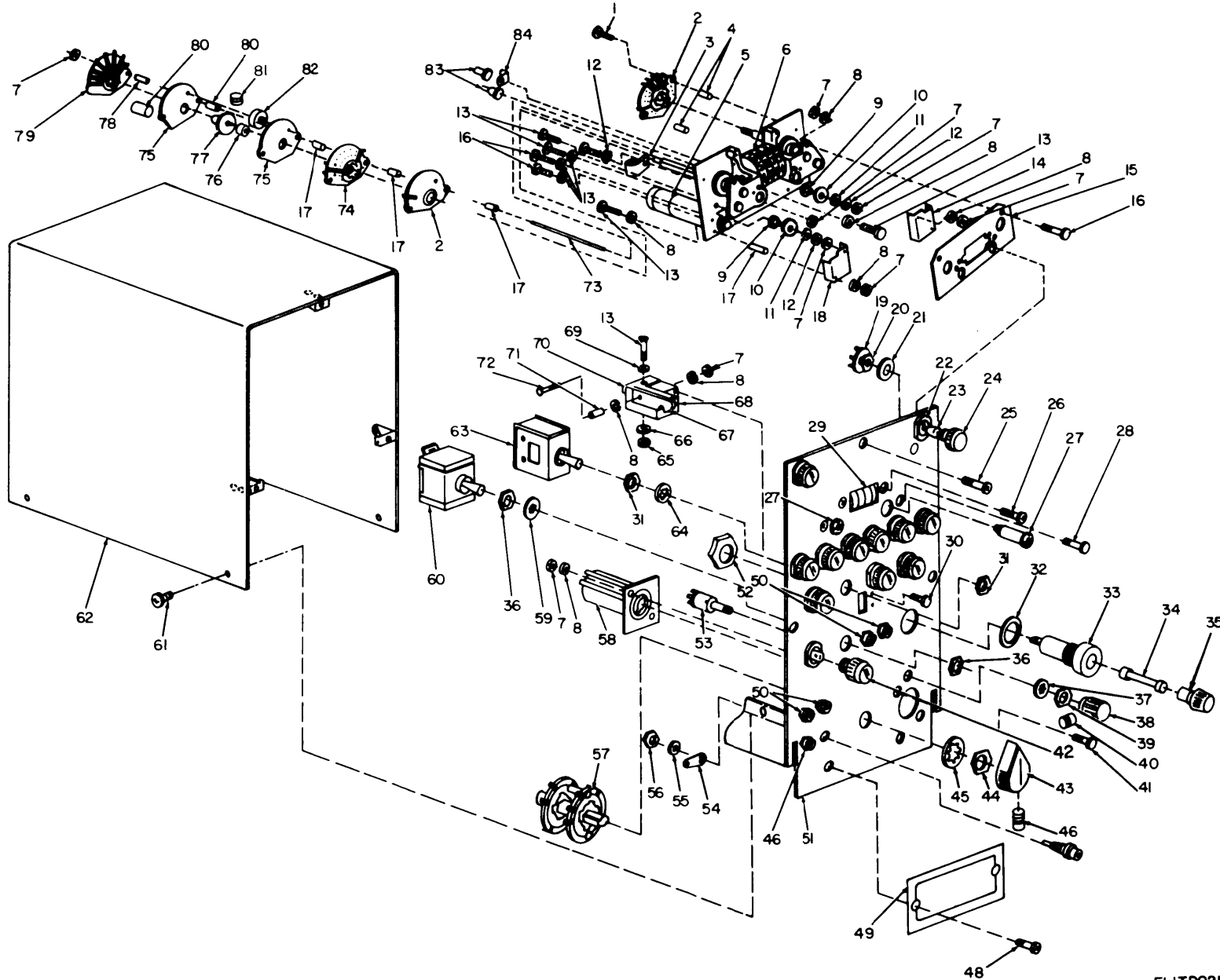

Figure 19. Front Panel Assembly SMB 50493.

ELITD021

SECTION II

TM11-6625-601-34P

(1) ILLUSTRATION (A) FIG NO	(2) (B) ITEM NO	(3) SMR CODE	(4) NATIONAL STOCK NUMBER	(5) PART NUMBER	(6) FSCM	(7) DESCRIPTION USABLE ON CODE	(8) QTY INC IN UNIT
						GROUP 110203 FRONT PANEL ASSEMBLY (SMB-504943)	
19	1	XDFZZ		SMB-504121-3	80063	SCREW,MACHINE	EA 2
19	2	PAFZZ	5950-00-786-3511	SMD-504011	80063	SWITCH SECTION,ROTARY	EA 2
19	3	XDFZZ		SMD-504037-2	80063	CLAMP,LOOP	EA 1
19	4	XDFZZ		SMC-504004-4	80063	SPACER,SLEEVE	EA 2
19	5	PAFFF	3010-00-902-1493	762-0903-001	13499	MOTOR,DIRECT CURRENT WITH GEAR AND PIN	EA 2
19	6	PAFFF	6625-00-901-0612	762-0906-001	13499	COUNTER,ELECTRICAL	EA 1
19	7	PAFZZ	5310-00-225-3072	SMB-438860	80063	NUT,PLAIN,HEXAGON	EA 17
19	8	PAFZZ	5310-00-933-8118	MS35338-135	96906	WASHER,LOCK	EA 19
19	9	XDFZZ		SMB-504761	80063	SHAFT,SHOULDERED	EA 2
19	10	PAFZZ	3020-00-901-4332	SMC-504750	80063	GEAR,HELICAL	EA 2
19	11	XDFZZ		SMB-504730	80063	WASHER,THRUST,NONMETALLIC	EA 2
19	12	PAFZZ	5310-00-782-1349	MS15795-804	96906	WASHER,FLAT	EA 2
19	13	PAFZZ	5305-00-054-5653	MS51957-19	96906	SCREW,MACHINE	EA 5
19	14	XDFZZ		SMC-504996-2	80063	GUARD,MECHANICAL DRIVE	EA 1
19	15	XDFZZ		SMC-504806	80063	SPACER,PLATE	EA 1
19	16	PAFZZ	5305-00-054-5647	MS51957-13	96906	SCREW,MACHINE	EA 6
19	17	XDFZZ		SMC-504221-7	80063	SPACER,SLEEVE	EA 4
19	18	XDFZZ		SMC-504996-1	80063	GUARD,MECHANICAL DRIVE	EA 1
19	19	XDFZZ		91080M	87034	LAMPHOLDER	EA 12
19	20	XDFZZ		RAYD508431-3	30972	NUT,PLAIN,HEXAGON	EA 12
19	21	XDFZZ		RAYD508431-5	30972	WASHER,LOCK	EA 12
19	22	XDFZZ		RATD508431-4	30972	NUT,PLAIN,ROUND	EA 12
19	23	PAOZZ	6240-00-155-7836	MS25237-327	96906	LAMP,INCANDESCENT	EA 12
19	24	PAOZZ	6210-00-169-5157	SMC-508425-2	80063	LENS,INDICATING LIGHT,GREEN	EA 11
19	25	PAFZZ	5305-00-054-5649	MS51957-15	96906	SCREW,MACHINE	EA 3
19	26	PAFZZ	5305-00-770-2579	MS51959-15	96906	SCREW,MACHINE	EA 2
19	27	PAFZZ	6240-00-155-7836	217732-2	99479	LIGHT,PANEL	EA 2
19	28	PAFZZ	5305-00-764-2966	MS51959-2	96906	SCREW,MACHINE	EA 2
19	29	XDFZZ		SMC-504726	80063	WINDOW,METER	EA 1
19	30	PAFZZ	5305-00-764-2964	MS51959-4	96906	SCREW,MACHINE	EA 2
19	31	XDFZZ		RAYD504801-1	30972	NUT	EA 2
19	32	XDFZZ		RAYC508373-3	30972	WASHER,NONMETALLIC	EA 1
19	33	PAFZZ	5920-00-933-4139	265-1138-00	71400	FUSEHOLDER	EA 1
19	34	XDOZZ		SMC-508344-2	80063	FUSE,CARTRIDGE	EA 1
19	35	XDOZZ		RAYC508373-1	30972	CAP,ELECTRICAL,FUSEHOLDER	EA 1
19	36	PAFZZ	5310-00-185-2774	RAYMS35058-31-1	30972	NUT,PLAIN,HEXAGON	EA 2
19	37	PAFZZ	5310-00-543-2740	MS35333-74	96906	WASHER,LOCK	EA 1
19	38	PAOZZ	5355-00-813-2078	MS91528-0D1B	96906	KNOB	EA 1
19	39	PAFZZ	5310-00-240-6445	SMB-504565	80063	NUT,PLAIN,HEXAGON	EA 1

SECTION II

TM11-6625-601-34P

(1) ILLUSTRATION (A) FIG NO	(B) ITEM NO	(2) SMR CODE	(3) NATIONAL STOCK NUMBER	(4) PART NUMBER	(5) FSCM	(6) DESCRIPTION	(7) USABLE ON CODE	(8) QTY INC IN UNIT
19	40	PAOZZ	5305-00-717-6950	RAYMS91528-0D1B1	30972	SETSCREW, HEXAGON HEAD	EA	2
19	41	PAFZZ	5305-00-763-7827	MS51959-18	96906	SCREW, MACHINE	EA	2
19	42	XDOZZ		91050M56	87034	LENS, INDICATING LIGHT, RED	EA	1
19	43	PAOZZ	5355-00-616-9604	MS91528-1P2B	96906	KNOB	EA	1
19	44	XDFZZ		MS25082-7	96906	NUT, PLAIN, HEXAGON	EA	1
19	45	PAFZZ	5310-00-595-7237	AN936A616	88044	WASHER, LOCK	EA	1
19	46	XDOZZ		RAYMS915828-1P2B 1	30972	SETSCREW, HEXAGON HEAD	EA	2
19	47	PAFZZ	5935-00-762-0312	M39024-10-03	81349	JACK, TIP, BLACK	EA	2
19	48	PAFZZ	5305-00-054-5644	MS51957-11	96906	SCREW, MACHINE	EA	2
19	49	XDFZZ		SMD-504913-1	80063	PLATE, IDENTIFICATION	EA	1
19	50	PAFZZ	5935-00-728-4514	M39024-10-01	81349	JACK, TIP, WHITE	EA	4
19	51	XDFZZ		SMD-504879	80063	PANEL, BLANK	EA	1
19	52	PAFZZ	5310-00-401-4998	RAYC508373-4	30972	NUT, PLAIN, HEXAGON	EA	1
19	53	XDFZZ		SMC-504033	80063	RESISTOR, VARIABLE	EA	1
19	54	PAFZZ	5940-00-665-5592	4012	77147	TERMINAL, LUG	EA	1
19	55	XDFZZ		RAYMS16108-1-2	30972	WASHER, LOCK	EA	6
19	56	PAFZZ	5310-00-245-7801	RAYMS16108-1-1	30972	NUT, PLAIN, HEXAGON	EA	6
19	57	PAFZZ	5930-00-944-2418	259-2243-030	13499	SWITCH, ROTARY	EA	1
19	58	PAFZZ	5935-00-578-9622	119392	78947	JACK, TELEPHONE, BLACK	EA	1
19	59	XDFZZ		RAYMS35058-31-3	30972	WASHER, LOCK	EA	1
19	60	PAFZZ	5930-00-655-1523	MS35058-31	96906	SWITCH, TOGGLE	EA	1
19	61	PAFZZ	5305-00-054-5648	MS51957-14	96906	SCREW, MACHINE	EA	2
19	62	XDFZZ		SMD-504853	80063	COVER, SIMULATOR	EA	1
19	63	PAFZZ	5930-00-810-6724	260-2699-00	13499	SWITCH, TOGGLE	EA	1
19	64	XDFZZ		RAYD504801-3	30972	WASHER, LOCK	EA	1
19	65	PAFZZ	5310-00-938-2013	MS35649-224	96906	NUT, PLAIN, HEXAGON	EA	1
19	66	PAFZZ	5310-00-928-2690	MS35338-134	96906	WASHER, LOCK	EA	1
19	67	XDFZZ		SMC-504768	80063	HOOK, HOLD-DOWN	EA	1
19	68	XDFZZ		SMC-504767	80063	BRACKET, EYE, NON ROTATING SHAFT	EA	1
19	69	PAFZZ	5310-00-136-1631	SMB-504908	80063	WASHER, FLAT	EA	1
19	70	XDFZZ		SMC-504769	80063	SPRING, FLAT	EA	1
19	71	XDFZZ		SMC-504776	80063	BEARING, SLEEVE	EA	1
19	72	PAFZZ	5305-00-054-5642	MS51957-8	96906	SCREW, MACHINE	EA	13
19	73	XDFZZ		SMC-504796	80063	STUD, CONTINUOUS THREAD	EA	2
19	74	PAFZZ	5930-00-188-8183	SMD-504849-1	80063	SWITCH SECTION, ROTARY	EA	1
19	75	XDFZZ		SMC-504001	80063	PLATE, RETAINING, SHAFT	EA	2
19	76	PAFZZ	3020-00-763-2351	516-2613-001	13499	GEAR, HELICAL	EA	1
19	77	XDFZZ		SMB-504909	80063	SHAFT AND CLUTCH HALF, POSITIVE	EA	1
19	78	XDFZZ		SMC-504004-2	80063	SPACER, SLEEVE	EA	2

SECTION II

TM11-6625-601-34P

(1) ILLUSTRATION (A) FIG NO	(B) ITEM NO	(2) SMR CODE	(3) NATIONAL STOCK NUMBER	(4) PART NUMBER	(5) FSCM	(6) DESCRIPTION	(7) USABLE ON CODE	U/M	(8) QTY INC IN UNIT
19	79	PAFZZ	5930-00-169-3739	SMD-504849-2	80063	SWITCH SECTION, ROTARY	EA	1	
19	80	XDFZZ		SMC-504004-3	80063	SPACER, SLEEVE	EA	2	
19	81	PAFZZ	5305-00-717-6865	SMC-504014-1	80063	SETSCREW	EA	2	
19	82	PAFZZ	5821-00-757-2803	516-2610-001	95104	GEAR, CLUSTER, HELICAL	EA	1	
19	83	PAFZZ	5940-00-259-8457	RTMT12M	91663	INSULATOR, STANDOFF	EA	2	
19	84	PAFZZ	5940-00-644-8722	4007-4	77147	TERMINAL, LUG	EA	1	

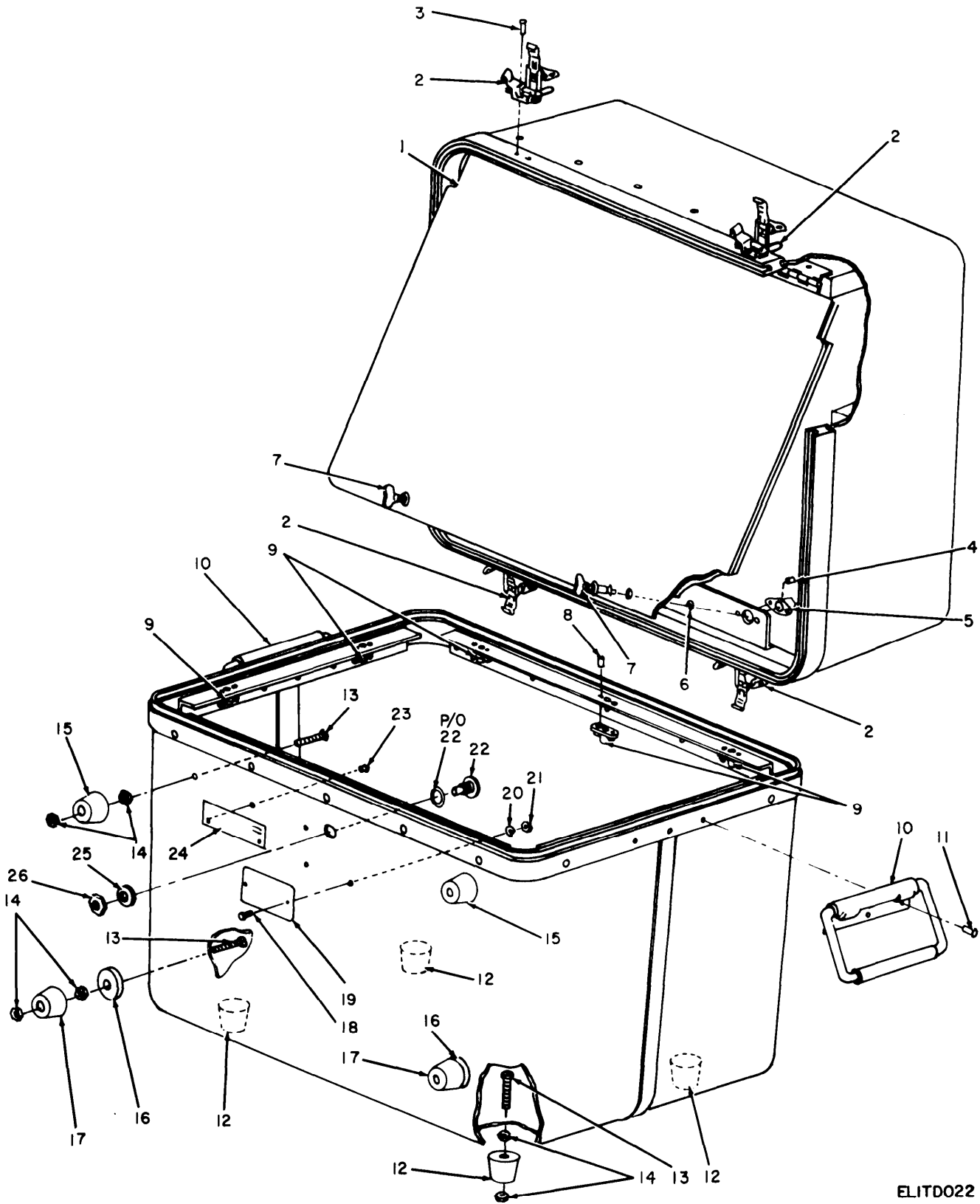

ELITD022

Figure 20. Case, Maintenance Kit CW-711/ARC-54.

SECTION II

TM11-6625-601-34P

(1) ILLUSTRATION (A) FIG NO	(2) (B) ITEM NO	(3) SMR CODE	(4) NATIONAL STOCK NUMBER	(5) PART NUMBER	(6) FSCM DESCRIPTION	(7) USABLE ON CODE U/M	(8) QTY INC IN UNIT
					GROUP 12 CASE, MAINTENANCE KIT		
					CW-711/ARC-54		
20	1	XDFZZ		SK639203	74284 DOOR, ACCESS	EA	1
20	2	PAFZZ	5340-00-173-3178	SKM617	74284 CLAMP, RIM CLENCHING	EA	4
20	3	PAFZZ	5320-00-928-2763	MS16535-162	96906 RIVET, TUBULAR	EA	8
20	4	PAFZZ	5320-00-117-6939	MS20426AD3-5	96906 RIVET, SOLID	EA	4
20	5	PAFZZ	5325-00-559-0334	212-12A	71286 RECEPTACLE, TURNLOCK FASTENER	EA	2
20	6	PAFZZ	5310-00-243-2259	2600SW	71286 WASHER, FLAT	EA	2
20	7	PAFZZ	5325-00-085-1746	2600-6SW	71286 STUD, TURNLOCK FASTENER	EA	2
20	8	PAFZZ	5320-00-117-6941	MS20426AD3-7	96906 RIVET, SOLID	EA	20
20	9	PAFZZ	5310-00-772-3720	MF1000-3	15653 NUT, PLATE, FLOATING	EA	10
20	10	PAFZZ	5340-00-063-0666	SKM637	74284 HANDLE, BAIL	EA	2
20	11	PAFZZ	5320-00-823-4945	MS16535-166	96906 RIVET, TUBULAR	EA	6
20	12	PAFZZ	5340-00-223-1645	SKM543	74284 BUMPER, RUBBER	EA	4
20	13	PAFZZ	5305-00-993-9269	MS3212-28	30972 SEELSCREW, SLOTTED HEAD	EA	8
20	14	PAFZZ	5310-00-838-6537	MS35650-105	96906 NUT, PLAIN, HEXAGON	EA	16
20	15	PAFZZ	5340-00-480-6140	SKM649	74284 BUMPER, RUBBER	EA	2
20	16	PAFZZ	5310-00-445-4717	SKM797	74284 SPACER, RUBBER	EA	2
20	17	PAFZZ	5340-00-173-3176	SK2399	74284 BUMPER, RUBBER	EA	2
20	18	PAFZZ	5305-00-054-5647	MS51957-13	96906 SCREW, MACHINE	EA	2
20	19	XDFZZ		SMD-504913-3	80063 PLATE, IDENTIFICATION	EA	1
20	20	PAFZZ	5310-00-933-8118	MS35338-135	96906 WASHER, LOCK	EA	2
20	21	PAFZZ	5310-00-225-3072	SMB-438860	80063 NUT, PLAIN, HEXAGON	EA	2
20	22	PAFZZ	4820-00-477-7953	SKM315	74284 VALVE, RELIEF	EA	1
20	23	XDFZZ		MS16535-161	96906 RIVET, TUBULAR	EA	2
20	24	XDFZZ		SKM262	74284 PLATE, INSTRUCTION	EA	1
20	25	PAFZZ	5310-00-409-3259	SKM315-3	74284 WASHER, FLAT	EA	1
20	26	PAFZZ	5310-00-240-7221	SKM315-2	74284 NUT, PLAIN, HEXAGON	EA	1

NOTE: LATEST NATIONAL STOCK NUMBER AND PART NUMBER ASSIGNMENTS ARE INCLUDED AT END OF INDEX

STOCK NUMBER	FIGURE NO	NO	STOCK NUMBER	FIGURE NO	ITEM NO
5910-00-051-4612	2	43	5310-00-245-7801	2	16
5935-00-052-3758	3	19	5310-00-245-7801	3	18
5935-00-052-3758	6	5	5310-00-245-7801	4	20
5305-00-054-5636	15	8	5310-00-245-7801	5	32
5305-00-054-5637	3	10	5310-00-245-7801	6	23
5305-00-054-5637	9	16	5310-00-245-7801	13	59
5305-00-054-5637	13	34	5310-00-245-7801	19	56
5305-00-054-5638	17	39	5905-00-249-3656	15	18
5305-00-054-5642	14	68	5940-00-259-8457	14	26
5305-00-054-5642	19	72	5940-00-259-8457	17	16
5305-00-054-5643	14	5	5940-00-259-8457	19	83
5305-00-054-5644	13	29	5325-00-263-6632	2	18
5305-00-054-5644	19	48	5325-00-263-6632	3	28
5305-00-054-5646	14	29	5325-00-263-6632	6	4
5305-00-054-5646	17	28	5325-00-276-6091	14	94
5305-00-054-5647	2	32	5905-00-279-1756	13	68
5305-00-054-5647	3	31	5905-00-279-1876	15	19
5305-00-054-5647	4	11	5905-00-279-1878	15	16
5305-00-054-5647	5	19	5905-00-279-1880	15	1
5305-00-054-5647	6	10	5905-00-279-2522	15	34
5305-00-054-5647	17	29	5905-00-279-3499	15	12
5305-00-054-5647	19	16	5905-00-279-3503	15	11
5305-00-054-5647	20	18	5905-00-279-3505	15	14
5305-00-054-5648	2	39	5905-00-279-3514	15	3
5305-00-054-5648	3	37	5905-00-279-3833	14	64
5305-00-054-5648	4	16	5935-00-280-2195	13	5
5305-00-054-5648	5	28	5325-00-290-6163	6	13
5305-00-054-5648	6	2	5905-00-299-1541	15	6
5305-00-054-5648	9	9	5310-00-409-3259	20	25
5305-00-054-5648	14	23	5910-00-412-2000	13	60
5305-00-054-5648	17	4	5910-00-412-2000	15	35
5305-00-054-5648	18	5	5310-00-445-4717	20	16
5305-00-054-5649	3	15	4820-00-477-7953	20	22
5305-00-054-5649	14	34	5340-00-480-6140	20	15
5305-00-054-5649	17	10	5310-00-543-2740	13	88
5305-00-054-5649	19	25	5310-00-543-2740	14	71
5305-00-054-5650	14	79	5310-00-543-2740	19	37
5305-00-054-5651	14	92	5310-00-543-5933	13	66
5305-00-054-5651	17	36	5325-00-559-0334	20	5
5305-00-054-5653	17	18	5935-00-578-9622	13	62
5305-00-054-5653	19	13	5935-00-578-9622	19	58
5305-00-054-5654	17	7	5935-00-583-5956	9	14
5305-00-054-6651	14	14	5935-00-583-5956	13	36
5305-00-054-6653	14	22	5935-00-583-5956	14	6
5305-00-054-6656	13	40	5905-00-583-6150	17	54
5305-00-054-6660	14	55	5310-00-595-7237	13	85
5305-00-054-6668	9	13	5310-00-595-7237	19	45
5305-00-059-3657	14	77	5905-00-615-6489	18	2
5305-00-059-3660	13	76	5355-00-616-9604	13	27
5340-00-063-0666	20	10	5355-00-616-9604	19	43
5910-00-079-9474	14	59	5940-00-644-8722	13	61
5905-00-080-5899	15	39	5940-00-644-8722	14	33
5905-00-081-7348	14	61	5940-00-644-8722	19	84
5325-00-085-1746	20	7	5930-00-655-1523	19	60
5320-00-117-6939	20	4	5940-00-665-5592	2	14
5320-00-117-6941	20	8	5940-00-665-5592	3	16
6240-00-155-7836	13	81	5940-00-665-5592	4	18
6240-00-155-7836	19	23	5940-00-665-5592	5	30
6240-00-155-7836	19	27	5940-00-665-5592	6	25
5905-00-171-1998	15	32	5940-00-665-5592	13	51
5905-00-171-2004	15	33	5940-00-665-5592	19	54
5905-00-171-2006	15	4	5935-00-685-9816	3	25
5970-00-173-2376	13	70	5935-00-702-4199	4	14
5340-00-173-3178	20	2	5310-00-722-5998	13	13
5310-00-185-2774	19	36	5310-00-722-5998	14	21
5905-00-185-8510	15	25	5305-00-725-4191	5	25
5905-00-192-3973	15	37	5305-00-727-8832	13	33
5905-00-192-3981	15	20	5305-00-727-8832	14	82
5905-00-195-6758	14	81	5935-00-728-4514	2	36
5905-00-195-6800	15	38	5935-00-728-4514	3	35
5905-00-195-6814	14	63	5935-00-728-4514	4	13
5310-00-209-1239	14	86	5935-00-728-4514	5	26
5340-00-223-1645	20	12	5935-00-728-4514	6	1
5310-00-225-3071	9	5	5935-00-728-4514	19	50
5310-00-225-3072	9	2	5935-00-729-7306	9	17
4140-00-226-4258	14	28	5935-00-729-7306	17	46
5310-00-231-8965	3	45	5961-00-752-5989	17	22
5310-00-231-8965	5	37	5821-00-757-2803	19	82
5310-00-240-7221	20	26	5935-00-762-0312	2	37
5310-00-243-2259	20	6	5935-00-762-0312	3	34

SECTION IV

NATIONAL STOCK NUMBER AND PART NUMBER INDEX

TM11-6625-601-34P

STOCK NUMBER	FIGURE NO	ITEM NO	STOCK NUMBER	FIGURE NO	ITEM NO
5935-00-762-0312	5	27	5961-00-892-0734	18	8
5935-00-762-0312	13	77	4130-00-900-9399	14	31
5935-00-762-0312	19	47	5985-00-900-9959	14	57
3020-00-763-2351	19	76	5985-00-901-1133	14	91
5305-00-763-6955	17	49	5950-00-901-8143	14	89
5305-00-763-6961	13	78	3010-00-902-1493	19	5
5305-00-763-7822	2	21	6625-00-913-5372	13	92
5305-00-763-7822	3	21	5935-00-926-2955	10	1
5305-00-763-7822	4	2	5310-00-929-6395	13	95
5305-00-763-7822	9	10	5310-00-929-6395	14	13
5305-00-763-7822	17	40	5310-00-929-6395	17	23
5305-00-763-7827	2	35	5920-00-933-4139	19	33
5305-00-763-7827	3	33	5310-00-933-8118	2	5
5305-00-763-7827	5	2	5310-00-933-8118	3	3
5305-00-763-7827	13	37	5310-00-933-8118	4	5
5305-00-763-7827	19	41	5310-00-933-8118	5	8
5305-00-764-0064	14	54	5310-00-933-8118	6	7
5305-00-764-2964	2	31	5310-00-933-8118	9	20
5305-00-764-2964	3	32	5310-00-933-8118	13	17
5305-00-764-2964	4	12	5310-00-933-8118	14	3
5305-00-764-2964	19	30	5310-00-933-8118	17	27
5305-00-764-2966	19	28	5310-00-933-8118	19	8
5305-00-768-0336	2	30	5310-00-933-8118	20	20
5305-00-768-0336	5	3	5310-00-933-8119	9	6
5305-00-770-2533	14	11	5310-00-933-8120	13	21
5305-00-770-2533	17	41	5310-00-933-8120	14	78
5305-00-770-2579	2	34	5310-00-934-9747	13	97
5305-00-770-2579	5	4	5310-00-934-9748	2	4
5305-00-770-2579	13	38	5310-00-934-9748	3	2
5305-00-770-2579	14	4	5310-00-934-9748	5	12
5305-00-770-2579	17	31	5310-00-934-9748	6	20
5305-00-770-2579	19	26	5310-00-934-9748	14	7
5305-00-770-2580	13	74	5310-00-934-9761	13	20
5305-00-770-2580	14	52	5310-00-934-9761	14	18
5310-00-782-1349	2	6	5310-00-934-9761	17	52
5310-00-782-1349	3	4	5310-00-934-9761	18	3
5310-00-782-1349	5	13	5310-00-934-9764	13	67
5310-00-782-1349	6	21	5935-00-936-7376	13	3
5310-00-782-1349	9	3	5310-00-938-2013	2	27
5310-00-782-1349	14	25	5310-00-938-2013	3	5
5310-00-782-1349	17	11	5310-00-938-2013	4	7
5310-00-782-1349	19	12	5310-00-938-2013	5	36
5935-00-809-0786	13	2	5310-00-938-2013	17	26
5935-00-811-1382	3	22	5310-00-938-2013	19	65
5355-00-813-2078	13	90	5935-00-941-9642	3	23
5355-00-813-2078	19	38	5935-00-941-9642	9	21
5935-00-815-6636	14	66	5930-00-943-1444	13	7
5365-00-820-4535	13	6	5935-00-943-6898	13	19
5961-00-826-9048	15	41	5930-00-944-2415	13	53
5340-00-827-4024	17	34	5930-00-944-2417	13	9
5940-00-836-3536	14	9	5930-00-944-2425	13	8
5935-00-836-6522	13	84	5930-00-944-4578	13	55
5910-00-841-8751	15	21	5999-00-944-4742	3	8
5961-00-842-6181	15	40	5999-00-944-4742	9	11
5905-00-843-6411	17	19	5935-00-944-7169	2	23
5910-00-847-6533	17	14	5935-00-944-7169	6	26
5910-00-851-5465	15	31	5935-00-950-0365	2	24
5935-00-881-9480	2	25	5935-00-950-0365	3	24
5935-00-881-9480	3	42	5935-00-950-0365	6	12
5935-00-881-9480	5	40	5945-00-965-8786	18	6
5961-00-892-0734	14	90	5935-00-995-5782	13	69

PART NUMBER	FSCM	FIG NO	ITEM NO	PART NUMBER	FSCM	FIG NO	ITEM NO
AN936A616	88044	13	85	CM06FD222J03	81349	15	35
AN936A616	88044	19	45	DAF15SC33	80063	4	9
AS-1487/ARC-54	80058	1	7	DAM15S037	71468	6	9
A047101	82877	14	28	DBM13W3PC27	71468	3	22
CE13C221G	81349	14	59	DCF37S-C33	71468	5	34
CL35BD060MP3	81349	15	31	DE-9P-C33	71468	2	2
CL35BD250MP3	81349	15	21	DEF9S-C33	71468	2	29
CL65BD181MP3	81349	15	17	DM53740-5005	91146	17	48
CL65BG100MP3	81349	15	13	DM53740-5035	71468	3	23
CL65BG220MP3	81349	15	36	DM53740-5035	71468	9	21
CL65CC560MP3	81349	15	30	DM53742-5029	71468	3	8
CM05ED220J03	81349	2	43	DM53742-5029	71468	9	11
CM05E470J03	81349	3	40	D29238	56289	17	14
CM06FD222J03	81349	13	60	HP3N	09922	14	93

PART NUMBER	FSCM	FIG NO	ITEM NO	PART NUMBER	FSCM	FIG NO	ITEM NO
ID-48/ARN	80058	13	41	MS35649-224	96906	3	5
JAN1N2822B	81349	17	22	MS35649-224	96906	4	7
JAN1N3018B	81349	15	40	MS35649-224	96906	5	36
JAN1N3020B	81349	15	41	MS35649-224	96906	17	26
JAN1N483B	81349	14	90	MS35649-224	96906	19	65
JAN1N483B	81349	18	8	MS35649-244	96906	2	4
JAN2N174	81349	14	72	MS35649-244	96906	3	2
MF1000-3	15653	20	9	MS35649-244	96906	5	12
MS15795-804	96906	2	6	MS35649-244	96906	6	20
MS15795-804	96906	3	4	MS35649-244	96906	14	7
MS15795-804	96906	5	13	MS35649-262	96906	13	97
MS15795-804	96906	6	21	MS35649-264	96906	13	20
MS15795-804	96906	9	3	MS35649-264	96906	14	18
MS15795-804	96906	14	25	MS35649-264	96906	17	52
MS15795-804	96906	17	11	MS35649-264	96906	18	3
MS15795-804	96906	19	12	MS35649-64	96906	17	24
MS15795-805	96906	13	13	MS35650-105	96906	20	14
MS15795-805	96906	14	21	MS39024-10-03	81349	4	15
MS15795-808	96906	13	75				
MS16535-161	96906	20	23	MS51957-11	96906	13	29
MS16535-162	96906	20	3	MS51957-11	96906	19	48
MS16535-166	96906	20	11	MS51957-12	96906	14	29
MS16632-1021	96906	4	21	MS51957-12	96906	17	28
MS16632-1021	96906	5	41	MS51957-13	96906	2	32
				MS51957-13	96906	3	31
MS20426AD3-5	96906	20	4	MS51957-13	96906	4	11
MS20426AD3-7	96906	20	8	MS51957-13	96906	5	19
MS21209C0420	96906	17	34	MS51957-13	96906	6	10
MS25082-7	96906	13	86	MS51957-13	96906	17	29
MS25082-7	96906	19	44	MS51957-13	96906	19	16
MS25237-327	96906	13	81	MS51957-13	96906	20	18
MS25237-327	96906	19	23	MS51957-14	96906	2	39
MS3057-10A	96906	13	2	MS51957-14	96906	3	37
MS3057-6A	96906	13	5	MS51957-14	96906	4	16
MS3106A14S-7S	96906	13	4	MS51957-14	96906	5	28
MS3106A18-1S	96906	13	1	MS51957-14	96906	6	2
MS3112E12-3P	96906	13	69	MS51957-14	96906	9	9
MS3116J12-3S	96906	10	1	MS51957-14	96906	14	23
MS3420-10	96906	13	3	MS51957-14	96906	17	4
MS3420-6	96906	13	6	MS51957-14	96906	18	5
MS35058-31	96906	19	60	MS51957-15	96906	3	15
MS35125-3	96906	13	32	MS51957-15	96906	14	34
MS35333-73	96906	13	66	MS51957-15	96906	17	10
MS35333-74	96906	13	88	MS51957-15	96906	19	25
MS35333-74	96906	14	71	MS51957-16	96906	14	79
MS35333-74	96906	19	37	MS51957-17	96906	14	92
MS35335-60	96906	14	86	MS51957-17	96906	17	36
MS35338-134	96906	2	28	MS51957-19	96906	17	18
MS35338-134	96906	3	6	MS51957-19	96906	19	13
MS35338-134	96906	4	8	MS51957-2	96906	15	8
MS35338-134	96906	5	35	MS51957-20	96906	17	7
MS35338-134	96906	9	15	MS51957-27	96906	14	14
MS35338-134	96906	13	35	MS51957-28	96906	14	62
MS35338-134	96906	14	8	MS51957-28	96906	17	20
MS35338-134	96906	17	25	MS51957-29	96906	14	22
MS35338-134	96906	19	66	MS51957-3	96906	3	10
MS35338-135	96906	2	5	MS51957-3	96906	9	16
MS35338-135	96906	3	3	MS51957-3	96906	13	34
MS35338-135	96906	4	5	MS51957-32	96906	13	40
MS35338-135	96906	5	8	MS51957-338	96906	13	91
MS35338-135	96906	6	7	MS51957-36	96906	14	55
MS35338-135	96906	9	20	MS51957-4	96906	17	39
MS35338-135	96906	13	17	MS51957-43	96906	9	13
MS35338-135	96906	14	3	MS51957-8	96906	14	68
MS35338-135	96906	17	27	MS51957-8	96906	19	72
MS35338-135	96906	19	8	MS51957-9	96906	14	5
MS35338-135	96906	20	20	MS51958-61	96906	14	77
MS35338-136	96906	13	95	MS51958-64	96906	13	76
MS35338-136	96906	14	13	MS51959-13	96906	14	11
MS35338-136	96906	17	23	MS51959-13	96906	17	41
MS35338-137	96906	9	6	MS51959-14	96906	2	21
MS35338-138	96906	13	21	MS51959-14	96906	3	21
MS35338-138	96906	14	78	MS51959-14	96906	4	2
MS35489-13	96906	6	13	MS51959-14	96906	9	10
MS35489-19	96906	14	94	MS51959-14	96906	17	40
MS35489-6	96906	2	18	MS51959-15	96906	2	34
MS35489-6	96906	3	28	MS51959-15	96906	5	4
MS35489-6	96906	6	4	MS51959-15	96906	13	38
MS35649-205	96906	13	67	MS51959-15	96906	14	4
MS35649-224	96906	2	27	MS51959-15	96906	17	31

SECTION IV

NATIONAL STOCK NUMBER AND PART NUMBER INDEX

TM11-6625-601-34P

MS51959-15	96906	19	26	RAYMS91528-0D1B1	30972	19	60
MS51959-16	96906	13	74	RAYMS91528-1P2B1	30972	13	94
MS51959-16	96906	14	52	RAYMS91528-1P2B1	30972	19	46
MS51959-17	96906	2	30	RAYM39012-21-1-1	30972	2	12
MS51959-17	96906	5	3	RAYM39012-21-1-1	30972	3	13
MS51959-18	96906	2	35	RAYM39012-21-1-1	30972	5	24
MS51959-18	96906	3	33	RAYM39012-21-1-1	30972	6	18
MS51959-18	96906	5	2	RAYM39012-21-1-2	30972	2	11
MS51959-18	96906	13	37	RAYM39012-21-1-2	30972	3	12
MS51959-18	96906	19	41	RAYM39012-21-1-2	30972	5	23
MS51959-2	96906	19	28	RAYM39012-21-1-2	30972	6	17
MS51959-21	96906	17	49				
MS51959-26	96906	13	78	RC07GF273J	81349	2	42
MS51959-29	96906	13	33	RC07GF273J	81349	3	39
MS51959-29	96906	14	82	RC20GF100K	81349	14	64
MS51959-32	96906	14	54	RC20GF103J	81349	15	25
MS51959-4	96906	2	31	RC20GF124J	81349	15	20
MS51959-4	96906	3	32	RC20GF151J	81349	15	6
MS51959-4	96906	4	12	RC20GF151K	81349	13	68
MS51959-4	96906	19	30	RC20GF152J	81349	15	2
MS51959-7	96906	5	25	RC20GF154J	81349	15	34
MS51960-64	96906	13	54	RC20GF181J	81349	15	3
MS91528-0D1B	96906	13	90	RC20GF222J	81349	15	19
MS91528-0D1B	96906	19	38	RC20GF223J	81349	15	33
MS91528-1P2B	96906	13	27	RC20GF243J	81349	15	16
MS91528-1P2B	96906	19	43	RC20GF271J	81349	15	4
M39012-19-0002	81349	13	84	RC20GF272J	81349	15	1
M39024-10-01	81349	2	36	RC20GF273J	81349	15	12
M39024-10-01	81349	3	35	RC20GF273K	81349	14	81
M39024-10-01	81349	4	13	RC20GF333J	81349	15	32
M39024-10-01	81349	5	26	RC20GF392J	81349	15	14
M39024-10-01	81349	6	1	RC20GF471J	81349	15	37
M39024-10-01	81349	19	50	RC20GF561J	81349	15	38
M39024-10-02	81349	4	14	RC20GF562J	81349	15	24
M39024-10-03	81349	2	37	RC20GF623J	81349	15	18
M39024-10-03	81349	3	34	RC20GF681J	81349	15	5
M39024-10-03	81349	5	27	RC20GF682J	81349	15	11
M39024-10-03	81349	13	77	RC32GF100K	81349	18	7
M39024-10-03	81349	19	47	RC42GF102K	81349	14	63
				RE65G6R81	81349	17	19
RAYC504031-1	30972	3	45	RG9896G94	71482	14	39
RAYC504031-1	30972	5	37	RN65B1213F	81349	18	2
RAYC504031-2	30972	2	3	RTMT12M	91663	14	26
RAYC504031-2	30972	3	44	RTMT12M	91663	17	16
RAYC504031-2	30972	5	38	RTMT12M	91663	19	83
RAYC504067-1	30972	2	2	RV6LAYSA253B	81349	14	75
RAYC504067-1	30972	5	10	RV6NAYSL103B	81349	13	50
RAYC504067-2	30972	5	11	RW36V100	81349	17	54
RAYC504820-1	30972	6	11	RW67V1R0	81349	14	61
RAYC504919-1	30972	10	5	RW69V101	81349	15	39
RAYC505015-1	30972	13	31	SKM262	74284	20	24
RAYC508361-1	30972	13	70	SKM315	74284	20	22
RAYC508373-1	30972	19	35	SKM315-2	74284	20	26
RAYC508373-3	30972	19	32	SKM315-3	74284	20	25
RAYC508373-4	30972	19	52	SKM543	74284	20	12
RAYD504801-1	30972	19	31	SKM617	74284	20	2
RAYD504801-3	30972	19	64	SKM637	74284	20	10
RAYD508431-3	30972	13	47	SKM649	74284	20	15
RAYD508431-3	30972	19	20	SKM797	74284	20	16
RAYD508431-4	30972	13	82	SK2399	74284	20	17
RAYD508431-4	30972	19	22	SK639203	74284	20	1
RAYD508431-5	30972	13	48	SMB-437306	80063	17	6
RAYD508431-5	30972	19	21	SMB-438860	80063	4	6
RAYMS16108-1-1	30972	2	16	SMB-438860	80063	5	9
RAYMS16108-1-1	30972	3	18	SMB-438860	80063	6	6
RAYMS16108-1-1	30972	4	20	SMB-438860	80063	9	2
RAYMS16108-1-1	30972	5	32	SMB-438860	80063	13	14
RAYMS16108-1-1	30972	6	23	SMB-438860	80063	14	2
RAYMS16108-1-1	30972	13	59	SMB-438860	80063	17	13
RAYMS16108-1-1	30972	19	56	SMB-438860	80063	19	7
RAYMS16108-1-2	30972	2	15	SMB-438860	80063	20	21
RAYMS16108-1-2	30972	3	17	SMB-504121-3	80063	19	1
RAYMS16108-1-2	30972	4	19	SMB-504441	80063	15	7
RAYMS16108-1-2	30972	5	31	SMB-504539	80063	13	65
RAYMS16108-1-2	30972	6	24	SMB-504539	80063	14	87
RAYMS16108-1-2	30972	13	58	SMB-504565	80063	13	89
RAYMS16108-1-2	30972	19	55	SMB-504565	80063	14	70
RAYMS35058-31-1	30972	19	36	SMB-504565	80063	19	39
RAYMS35058-31-3	30972	19	59	SMB-504707	80063	2	38
RAYMS91528-0D1B1	30972	13	87	SMB-504707	80063	3	36

PART NUMBER	FSCM	FIG NO	ITEM NO	PART NUMBER	FSCM	FIG NO	ITEM NO
SMB-504707	80063	4	17	SMC-504806	80063	19	15
SMB-504707	80063	5	29	SMC-504815	80063	17	44
SMB-504707	80063	6	15	SMC-504818	80063	17	32
SMB-504724	80063	5	17	SMC-504820-1	80063	2	19
SMB-504730	80063	19	11	SMC-504823	80063	5	20
SMB-504761	80063	19	9	SMC-504843	80063	8	1
SMB-504778	80063	15	28	SMC-504862	80063	17	53
SMB-504779	80063	15	27	SMC-504865	80063	14	80
SMB-504781	80063	17	5	SMC-504866	80063	9	1
SMB-504782	80063	14	88	SMC-504875	80063	6	19
SMB-504784	80063	15	29	SMC-504905	80063	13	43
SMB-504787	80063	4	23	SMC-504906	80063	13	42
SMB-504789	80063	5	43	SMC-504919	80063	10	4
SMB-504789	80063	13	64	SMC-504946	80063	13	25
				SMC-504969	80063	14	38
SMB-504791	80063	17	30	SMC-504971	80063	14	40
SMB-504810	80063	17	35	SMC-504972	80063	14	48
SMB-504907	80063	14	56	SMC-504974	80063	14	45
SMB-504908	80063	13	18	SMC-504975	80063	14	46
SMB-504908	80063	14	17	SMC-504996-1	80063	19	18
SMB-504908	80063	17	50	SMC-504996-2	80063	19	14
SMB-504908	80063	18	4	SMC-504997	80063	14	49
SMB-504908	80063	19	69	SMC-508300-1	80063	17	42
SMB-504909	80063	19	77	SMC-508300-3	80063	14	12
SMB-504943	80063	16	1	SMC-508300-4	80063	17	8
SMB-504958	80063	12	1				
				SMC-508320-3	80063	14	85
SMC-394465	80063	5	6	SMC-508325-1	80063	13	96
SMC-504001	80063	19	75	SMC-508325-2	80063	9	7
SMC-504004-2	80063	19	78	SMC-508331	80063	17	47
SMC-504004-3	80063	19	80	SMC-508340-1	80063	2	40
SMC-504004-4	80063	19	4	SMC-508340-1	80063	3	38
SMC-504014-1	80063	19	81	SMC-508344-2	80063	19	34
SMC-504033	80063	13	52	SMC-508361-1	80063	13	73
SMC-504033	80063	19	53	SMC-508361-2	80063	13	72
SMC-504133-2	80063	13	22	SMC-508365-2	80063	3	14
SMC-504133-2	80063	17	21	SMC-508365-2	80063	14	69
SMC-504221-6	80063	13	11	SMC-508365-2	80063	17	17
SMC-504221-7	80063	19	17	SMC-508365-4	80063	13	10
SMC-504466-2	80063	4	4	SMC-508365-4	80063	14	36
SMC-504466-2	80063	6	28	SMC-508376	80063	3	26
SMC-504699	80063	5	7	SMC-508425-2	80063	19	24
SMC-504699	80063	3	19	SMD-504011	80063	19	2
SMC-504699	80063	17	15	SMD-504037-1	80063	14	83
SMC-504710	80063	14	51	SMD-504037-1	80063	17	9
SMC-504726	80063	19	29	SMD-504037-2	80063	2	13
SMC-504727-1	80063	5	33	SMD-504037-2	80063	14	24
SMC-504728	80063	6	29	SMD-504037-2	80063	17	12
SMC-504731	80063	6	8	SMD-504037-2	80063	19	3
SMC-504732	80063	3	7	SMD-504037-3	80063	14	73
SMC-504744	80063	4	3	SMD-504037-4	80063	9	4
SMC-504745-1	80063	2	9	SMD-504307	80063	9	12
SMC-504745-2	80063	2	26	SMD-504307	80063	13	23
SMC-504745-2	80063	5	39	SMD-504366	80063	3	9
SMC-504745-3	80063	5	16	SMD-504729	80063	17	51
SMC-504745-4	80063	3	41	SMD-504737	80063	4	1
SMC-504745-5	80063	5	44	SMD-504743	80063	14	37
SMC-504747-2	80063	5	5	SMD-504746	80063	17	37
SMC-504748-1	80063	4	22	SMD-504749	80063	14	19
SMC-504748-2	80063	5	42	SMD-504751	80063	14	53
SMC-504750	80063	19	10	SMD-504755	80063	14	50
SMC-504759	80063	14	32	SMD-504757	80063	14	30
SMC-504760	80063	2	7	SMD-504766	80063	2	1
SMC-504760	80063	3	43	SMD-504766	80063	3	1
SMC-504760	80063	5	14	SMD-504799	80063	9	18
SMC-504767	80063	19	68	SMD-504799	80063	17	45
SMC-504768	80063	19	67	SMD-504808	80063	9	8
SMC-504769	80063	19	70	SMD-504813	80063	17	33
SMC-504770-1	80063	2	20				
SMC-504770-2	80063	3	20	SMD-504830	80063	7	1
SMC-504773	80063	14	10	SMD-504846-5	80063	13	24
SMC-504775-1	80063	14	1	SMD-504846-6	80063	13	56
SMC-504775-2	80063	14	15				
SMC-504776	80063	19	71	SMD-504849-1	80063	19	74
SMC-504796	80063	19	73	SMD-504849-2	80063	19	79
SMC-504797	80063	17	3	SMD-504850	80063	13	12
SMC-504800	80063	2	10	SMD-504853	80063	19	62
SMC-504800	80063	3	11	SMD-504854	80063	13	57
SMC-504800	80063	5	22				
SMC-504800	80063	6	16	SMD-504870	80063	17	38

PART NUMBER	FSCM	FIG NO	ITEM NO	PART NUMBER	FSCM	FIG NO	ITEM NO
SMD-504871	80063	17	43	260-2699-00	13499	19	63
SMD-504878	80063	17	1	2600-6SW	71286	20	7
SMD-504879	80063	19	51	2600SW	71286	20	6
SMD-504886	80063	13	63	265-1138-00	71400	19	33
SMD-504888	80063	15	10	30	76545	6	27
SMD-504913	80063	4	10	31-11317-1	12175	14	89
SMD-504913-1	80063	19	49	31-53	98278	2	23
SMD-504913-2	80063	13	28	31-53	98278	6	26
SMD-504913-3	80063	20	19	351-7003-010	13499	14	57
SMD-504913-4	80063	2	33	352-994-800	13499	14	84
SMD-504913-5	80063	3	30	352-9964-000	13499	14	76
SMD-504913-7	80063	5	18	357-9227-000	13499	3	25
SMD-504913-8	80063	6	14	357-9248-00	13499	13	71
SMD-504920-1	80063	15	23	357-9308-00	13499	2	25
SMD-504925	80063	14	65	357-9308-00	13499	3	42
SMD-504926	80063	16	3	357-9308-00	13499	5	40
SMD-504930	80063	14	35	363-0026-240	85775	10	6
SMD-504930	80063	16	2	371-0182-000	13499	9	14
SMD-504947	80063	5	1	371-0182-000	13499	13	36
SMD-508443	80063	13	49	371-0182-000	13499	14	6
SME-504929	80063	14	16	371-0290-00	13499	3	19
SM-349/ARC-54	80058	12	2	371-0290-00	13499	6	5
SOS50-32-55	98278	2	24	371-6113-000	13499	8	3
SOS50-32-55	98278	3	24	371-6281-00	13499	8	2
SOS50-32-55	98278	6	12	371-6411-00	13499	7	2
TK-156/ARC-54	80058	1	11	375-0513-020	13499	14	44
TS-1967/ARC-54	80058	1	1	379-0513-030	13499	14	47
TW516-10	08286	14	74	379-0513-040	13499	14	42
UG-1678/U	80058	1	3	381-9057-130	17826	15	26
UG625B/U	80058	3	29	4007-4	77147	13	61
UG625B/U	80058	5	21	4007-4	77147	14	33
UG625B/U	80058	6	3	4007-4	77147	19	84
UG625B/U	80058	2	41	4012	77147	2	14
UG88E/U	80058	11	1	4012	77147	3	16
UG88E/U	80058	14	58	4012	77147	4	18
YE-1620	09922	13	26	4012	77147	5	30
Y500	94375	2	8	4012	77147	6	25
Y500	94375	5	15	4012	77147	13	51
009-0102-00	12064	14	31	4012	77147	19	54
015-729-6763	13499	14	27	4040-2HTD	77147	14	9
019606-0041	71468	9	17	410-0244-000	13499	14	91
019606-0041	71468	17	46	476-0431-00	13499	13	92
1E7052-89	01548	13	55	516-2610-001	95104	19	82
1N600	81349	18	1	516-2613-001	13499	19	76
119392	78947	13	62	52-150 WHITE	98278	14	41
119392	78947	19	58	5424	91737	14	66
13564	91737	13	19	57	85775	10	2
1390	36619	14	67	747-R	75543	14	20
150D562X90352	56289	15	22	762-0903-001	13499	19	5
2N1308	81349	15	15	762-0906-001	13499	19	6
2N697	81349	15	9	801B3800B-75	94375	13	93
212-12A	71286	20	5	87-RED	85775	10	3
217732-2	99479	19	27	900-14	15849	13	39
244213F1	76854	13	45	900100	88044	14	43
244223F1	76854	13	15	91050M56	87034	13	80
259-2243-030	13499	19	57	91050M56	87034	19	42
259-2343-010	13499	13	7	91080M	87034	13	46
259-2343-020	13499	13	8	91080M	87034	19	19
259-2344-010	13499	13	53	911	75543	2	17
259-2344-020	13499	13	16	911	75543	3	27
259-2344-040	76854	13	44	9188272	50000	14	60
259-2344-070	13499	13	9	974-0822-00	13499	18	6

ADDITIONAL LATEST NATIONAL STOCK NUMBER ASSIGNMENTS

5999-00-577-0994	6	27
5310-00-850-1611	13	75
5910-00-954-1772	3	40

ADDITIONAL LATEST PART NUMBER ASSIGNMENTS

AN960C6	88044	17	2	MS3212-28	96906	20	13
---------	-------	----	---	-----------	-------	----	----

SECTION IV

NATIONAL STOCK NUMBER AND PART NUMBER INDEX
LATEST NATIONAL STOCK NUMBER ASSIGNMENTS

TM11-6625-601-34P

STOCK NUMBER	FIGURE NO	ITEM NO	STOCK NUMBER	FIGURE NO	ITEM NO
5821-00-001-8571	1	3	5925-00-763-4104	13	63
5305-00-054-5648	19	61	5305-00-763-7822	13	83
5305-00-054-6652	14	62	5935-00-769-4066	2	22
5305-00-054-6652	17	20	5310-00-772-3720	20	9
5305-00-054-6657	13	91	5950-00-786-3511	19	2
			5930-00-810-6724	19	63
5305-00-071-1321	13	54	5940-00-812-2903	13	26
5305-00-079-2556	15	28	5310-00-814-4534	13	32
			5940-00-817-4880	13	72
5905-00-104-8343	18	7	5910-00-818-8720	15	22
5310-00-136-1631	13	18	5950-00-820-1227	2	40
5310-00-136-1631	14	17	5950-00-820-1227	3	38
5310-00-136-1631	17	50	5910-00-822-0016	14	60
5310-00-136-1631	18	4	5935-00-823-0487	11	1
5310-00-136-1631	19	69	5935-00-823-0487	14	58
5910-00-137-1127	15	30	5320-00-823-4945	20	11
5940-00-143-4774	8	1	5961-00-829-0194	15	15
5930-00-169-3739	19	79	5961-00-837-7262	15	9
6210-00-169-5157	19	24	5310-00-838-6537	20	14
5935-00-173-1214	13	57	6610-00-839-8638	13	41
5340-00-173-3176	20	17	5905-00-841-7461	15	2
5930-00-188-8183	19	74			
5905-00-195-6453	15	24			
5905-00-195-6791	15	5			
5310-00-205-9399	14	85	5935-00-850-8876	13	71
5310-00-221-0230	5	43	5180-00-900-8041	1	11
5310-00-221-0230	13	64	6625-00-901-0612	19	6
5310-00-225-3072	4	6	6625-00-901-2972	1	1
5310-00-225-3072	5	9	3020-00-901-4332	19	10
5310-00-225-3072	6	6	5995-00-901-4334	1	9
5310-00-225-3072	13	14	5995-00-901-4335	1	8
5310-00-225-3072	14	2	5995-00-901-4337	1	10
5310-00-225-3072	17	13	5995-00-901-4340	1	6
5310-00-225-3072	19	7	5935-00-901-5204	2	29
5310-00-225-3072	20	21	6625-00-906-1172	12	2
5310-00-231-8946	15	29	6625-00-906-1173	1	15
5310-00-231-9086	15	7	6625-00-906-1174	1	12
5310-00-240-6445	13	89	6625-00-906-1175	1	5
5310-00-240-6445	14	70	6625-00-906-1176	1	14
5310-00-240-6445	19	39	6625-00-906-1177	1	13
5325-00-248-7031	2	17	5935-00-910-5098	17	48
5325-00-248-7031	3	27	5310-00-928-2690	2	28
5340-00-264-7182	14	20	5310-00-928-2690	3	6
5975-00-284-7615	10	2	5310-00-928-2690	4	8
5340-00-337-8642	9	4	5310-00-928-2690	5	35
5940-00-350-7774	14	80	5310-00-928-2690	9	15
5310-00-401-4998	19	52	5310-00-928-2690	13	35
5305-00-419-0895	4	22	5310-00-928-2690	14	8
5305-00-419-0896	5	42	5310-00-928-2690	17	25
5305-00-419-0897	17	3	5310-00-928-2690	19	66
5310-00-531-9514	17	2	5320-00-928-2763	20	3
5905-00-549-8222	14	75	5905-00-933-3999	15	26
5935-00-552-7660	2	41	5975-00-933-4279	10	6
5935-00-552-7660	3	29	5995-00-933-5782	1	4
5935-00-552-7660	5	21	5310-00-934-9761	17	24
5935-00-552-7660	6	3	5930-00-944-2414	13	44
5975-00-557-2531	10	3	5930-00-944-2416	13	56
5905-00-615-5217	2	42	5930-00-944-2418	19	57
5905-00-615-5217	3	39	5930-00-944-2419	13	15
5340-00-619-7754	14	93	5935-00-963-1432	2	8
5940-00-682-2477	14	43	5935-00-963-1432	5	15
5935-00-686-3635	5	6	5340-00-964-2557	13	10
5305-00-717-6865	19	81	5340-00-964-2557	14	36
5305-00-717-6950	13	87	5340-00-969-6501	6	22
5305-00-717-6950	19	40	5985-00-985-9023	1	7
5935-00-719-1029	6	9	5935-00-989-2546	4	9
5935-00-721-0491	13	1	5935-00-989-4399	5	34
5935-00-728-4514	13	79	5365-00-993-5303	4	21
5935-00-728-4514	13	79	5365-00-993-5303	4	21
5935-00-729-8687	7	1	5365-00-993-5303	5	41
			5305-00-993-9269	20	13
5935-00-762-0312	4	15	5935-00-999-6464	13	93
			6625-00-906-1171	1	2

LATEST PART NUMBER ASSIGNMENTS

PART NUMBER	FSCM	FIG NO	ITEM NO	PART NUMBER	FSCM	FIG NO	ITEM NO
AN936B4B	88044	13	30	MX-4930/ARC-54	80058	1	5
CG-409/GU	80058	1	4	MX-4931/ARC-54	80058	1	12
CW-711/ARC-54	80058	1	2	MX-4932/ARC-54	80058	1	14
CX-11136/ARC-54	80058	1	6	MX-4933/ARC-54	80058	1	15
CX-9070/ARC-54	80058	1	9	MX-4934/ARC-54	80058	1	13
CX-9071/ARC-54	80058	1	8	M39024-10-01	81349	13	79
CX-9072/ARC-54	80058	1	10	SMB-504795	80063	9	5
MS51957-14	96906	19	61	SMC-508365-3	80063	6	22
MS51959-14	96906		83				

RECOMMENDED CHANGES TO EQUIPMENT TECHNICAL MANUALS



SOMETHING WRONG WITH THIS MANUAL?

THEN... JOT DOWN THE DOPE ABOUT IT ON THIS FORM, TEAR IT OUT, FOLD IT AND DROP IT IN THE MAIL!

FROM: (YOUR UNIT'S COMPLETE ADDRESS)

Commander
Stateside Army Depot
ATTN: AMSTA-US
Stateside, N.J. 07703

DATE 10 July 1975

PUBLICATION NUMBER

TM 11-5840-340-12

DATE

23 Jan 74

TITLE

Radar Set AN/P-3-76

BE EXACT... PIN-POINT WHERE IT IS

PAGE NO.	PARA-GRAPH	FIGURE NO.	TABLE NO.
----------	------------	------------	-----------

2-25	2-28		
3-10	3-3		3-1
5-6	5-8		

FO3

IN THIS SPACE TELL WHAT IS WRONG AND WHAT SHOULD BE DONE ABOUT IT:

Recommend that the installation antenna alignment procedure be changed throughout to specify a 2° IFF antenna lag rather than 1°.

REASON: Experience has shown that with only a 1° lag, the antenna servo system is too sensitive to wind gusting in excess of 5 knots, and has a tendency to rapidly accelerate and decelerate as it hunts, causing strain to the drive train. Hunting is minimized by adjusting the lag to 2° without degradation of operation.

Item 5, Function column. Change "2 db" to "3db."

REASON: The adjustment procedure for the TRANS POWER FAULT indicator calls for a 3 db (500 watts) adjustment to light the TRANS POWER FAULT indicator.

Add new step f.1 to read, "Replace cover plate removed in step e.1, above."

REASON: To replace the cover plate.

Zone C 3. On J1-2, change "+24 VDC to "+5 VDC."

REASON: This is the output line of the 5 VDC power supply. + 24 VDC is the input voltage.

TYPED NAME, GRADE OR TITLE, AND TELEPHONE NUMBER

SSG I. M. DeSpirito 999-1776

SIGN HERE:

SSG I. M. DeSpirito

DA FORM 2028-2
1 AUG 74

P.S.--IF YOUR OUTFIT WANTS TO KNOW ABOUT YOUR MANUAL "FIND," MAKE A CARBON COPY OF THIS AND GIVE IT TO YOUR HEADQUARTERS.

HISA 1686-75

TEAR ALONG DOTTED LINE

FILL IN YOUR
UNIT'S ADDRESS

FOLD BACK

DEPARTMENT OF THE ARMY

OFFICIAL BUSINESS
PENALTY FOR PRIVATE USE, \$300

POSTAGE AND FEES PAID
DEPARTMENT OF THE ARMY
DOD-314



Commander
US Army Communications and
Electronics Materiel Readiness Command
ATTN: DRSEL-ME-MQ
Fort Monmouth, New Jersey 07703

TEAR ALONG DOTTED LINE

FOLD BACK

RECOMMENDED CHANGES TO EQUIPMENT TECHNICAL MANUALS



SOMETHING WRONG WITH THIS MANUAL?

THEN... JOT DOWN THE DOPE ABOUT IT ON THIS FORM, TEAR IT OUT, FOLD IT AND DROP IT IN THE MAIL!

FROM: (YOUR UNIT'S COMPLETE ADDRESS)

DATE

PUBLICATION NUMBER

TM 11-6625-601-34P

DATE

2 NOV 78

TITLE MAINTENANCE KIT, ELECTRONIC EQUIPMENT MK-733/ARC-54

BE EXACT... PIN-POINT WHERE IT IS

IN THIS SPACE TELL WHAT IS WRONG AND WHAT SHOULD BE DONE ABOUT IT:

PAGE NO.	PARA-GRAPH	FIGURE NO.	TABLE NO.
----------	------------	------------	-----------

TEAR ALONG DOTTED LINE

TYPED NAME, GRADE OR TITLE, AND TELEPHONE NUMBER

SIGN HERE:

DA FORM 2028-2
1 AUG 74

P.S.--IF YOUR OUTFIT WANTS TO KNOW ABOUT YOUR MANUAL "FIND," MAKE A CARBON COPY OF THIS AND GIVE IT TO YOUR HEADQUARTERS.

FILL IN YOUR
UNIT'S ADDRESS

FOLD BACK

DEPARTMENT OF THE ARMY

OFFICIAL BUSINESS
PENALTY FOR PRIVATE USE, \$300

POSTAGE AND FEES PAID
DEPARTMENT OF THE ARMY
DOD-314



Commander
US Army Communications and
Electronics Materiel Readiness Command
ATTN: DRSEL-ME-MQ
Fort Monmouth, New Jersey 07703

FOLD BACK

TEAR ALONG DOTTED LINE

RECOMMENDED CHANGES TO EQUIPMENT TECHNICAL MANUALS



SOMETHING WRONG WITH THIS MANUAL?

THEN... JOT DOWN THE DOPE ABOUT IT ON THIS FORM, TEAR IT OUT, FOLD IT AND DROP IT IN THE MAIL!

FROM: (YOUR UNIT'S COMPLETE ADDRESS)

DATE

PUBLICATION NUMBER

TM 11-6625-601-34P

DATE

2 NOV 78

TITLE MAINTENANCE KIT, ELECTRONIC
MK-733/ARC-54

BE EXACT... PIN-POINT WHERE IT IS

IN THIS SPACE TELL WHAT IS WRONG AND WHAT SHOULD BE DONE ABOUT IT:

PAGE NO.	PARA-GRAPH	FIGURE NO.	TABLE NO.
----------	------------	------------	-----------

TEAR ALONG DOTTED LINE

TYPED NAME, GRADE OR TITLE, AND TELEPHONE NUMBER

SIGN HERE:

DA FORM 2028-2
1 AUG 74

P.S.--IF YOUR OUTFIT WANTS TO KNOW ABOUT YOUR MANUAL "FIND," MAKE A CARBON COPY OF THIS AND GIVE IT TO YOUR HEADQUARTERS.

FILL IN YOUR
UNIT'S ADDRESS

FOLD BACK

DEPARTMENT OF THE ARMY

OFFICIAL BUSINESS
PENALTY FOR PRIVATE USE, \$300

POSTAGE AND FEES PAID
DEPARTMENT OF THE ARMY
DOD-314



Commander
US Army Communications and
Electronics Materiel Readiness Command
ATTN: DRSEL-ME-MQ
Fort Monmouth, New Jersey 07703

TEAR ALONG DOTTED LINE

FOLD BACK

By Order of the Secretary of the Army:

BERNARD W. ROGERS
General, United States Army
Chief of Staff

Official:

J. C. PENNINGTON
Brigadier General, United States Army
The Adjutant General

DISTRIBUTION:

To be distributed in accordance with DA Form 12-36A, Section II, Direct and General Support requirements for MK-733/ARC-54.

DEPARTMENT OF THE ARMY
US ARMY AG PUBLICATIONS CENTER
1655 WOODSON ROAD
ST. LOUIS, MISSOURI 63114
OFFICIAL BUSINESS
PENALTY FOR PRIVATE USE \$300

POSTAGE AND FEES PAID
DEPARTMENT OF THE ARMY
DOD 314



PIN: 020895